

## - Coolant Replacement

---

1. [Remove the engine compartment covers.](#)
2. Wait until the engine is cool, then carefully remove the radiator cap.
3. Loosen the drain plug (A), and drain the coolant.

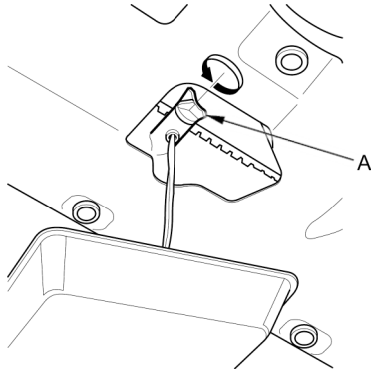

4. Install a rubber hose (A) on the drain bolt (B) located at the rear of the engine block, then loosen the drain bolt.

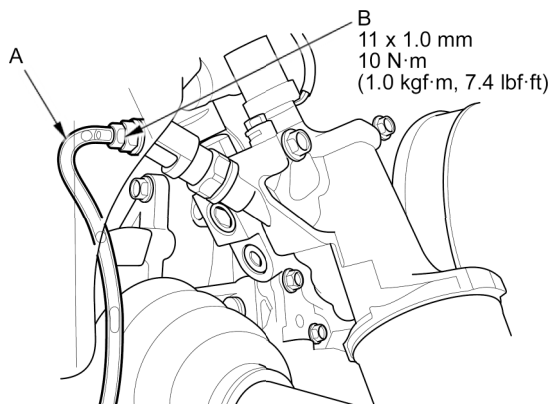

5. When the coolant stops draining, tighten the drain bolt. Remove the rubber hose.
6. Tighten the radiator drain plug securely.
7. Remove, drain, and reinstall the coolant reservoir.
8. Fill the coolant reservoir to the MAX mark (A) with Acura Long Life Antifreeze/Coolant Type 2.

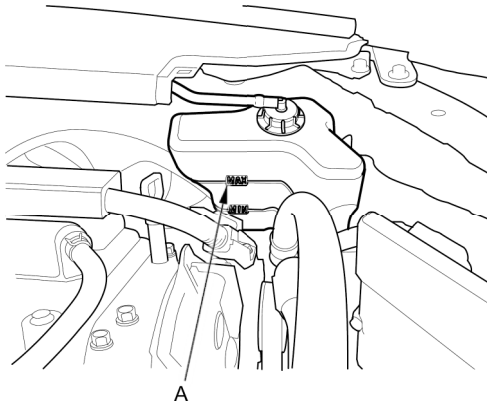

9. Pour Acura Long Life Antifreeze/Coolant Type 2 into the radiator up to the base of the filler neck.

NOTE:

- Always use Acura Long Life Antifreeze/Coolant Type 2. Using a non-Acura coolant can result in corrosion, causing the cooling system to malfunction or fail.
- Acura Long Life Antifreeze/Coolant Type 2 is a mixture of 50 % antifreeze and 50 % water. Do not add water.

**Engine Coolant Refill Capacities (Including the coolant reservoir capacity of 0.69 L (0.182 US gal))**

**At Coolant Change:**

**6.3 L (1.66 US gal)**

**After Engine Overhaul:**

**8.3 L (2.19 US gal)**

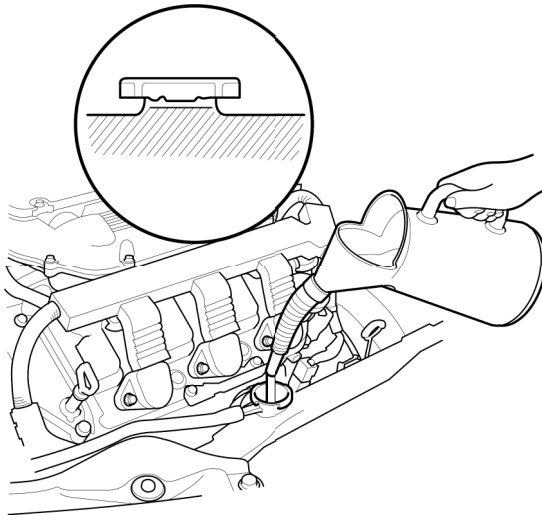

- Loosely install the radiator cap.
- Set the heater temperature control to maximum heat.
- Start the engine, and let it run until it warms up (the radiator fan comes on at least twice).
- Turn off the engine. Check the level in the radiator, and add Acura Long Life Antifreeze/Coolant Type 2, if needed.
- Put the radiator cap on securely, then run the engine again, and check for leaks.
- Clean up any spilled engine coolant.
- [Install the engine compartment covers.](#)

17. [If the Maintenance Minder required replacing the engine coolant, reset the Maintenance Minder](#), and this procedure is complete. If the Maintenance Minder did not require engine coolant replacement, go to step [18](#).
18. Turn the ignition switch to LOCK (0), or press the engine start/stop button to select the OFF mode.
19. [Connect the HDS to the DLC](#).
20. Turn the ignition switch to ON (II), or press the engine start/stop button to select the ON mode.
21. Make sure the HDS communicates with the vehicle and the ECM/PCM. If it does not communicate, [troubleshoot the DLC circuit](#).
22. Select GAUGES in the BODY ELECTRICAL with the HDS.
23. Select ADJUSTMENT in the GAUGES with the HDS.
24. Select MAINTENANCE MINDER in the ADJUSTMENT with the HDS.
25. Select RESET in the MAINTENANCE MINDER with the HDS.
26. Select MAINTENANCE SUB ITEM 5 RESET with the HDS.