



## Rattle or Vibration From the Rear Speakers

### SYMPTOM

There is a rattle or vibration coming from the rear speakers or subwoofer when the audio system is on.

### POSSIBLE CAUSE

Vibration from the subwoofer causes cracks in the rear parcel shelf at the subwoofer mounting location.

### CORRECTIVE ACTION

Cut out the damaged section of the rear parcel shelf and install a service plate.

### PARTS INFORMATION

NOTE: To help clarify where new parts are used in the REPAIR PROCEDURE, the new part is listed in the applicable repair step with a ">" symbol.

Rear Parcel Shelf Kit: P/N 66500-TK4-3050

Kit includes:

- Service Plate
- Subwoofer Trim Ring
- Twist Tube
- Harness Clip
- Bolts
- Paper Template (cut-out)

C-Pillar Trim Clip: P/N 91561-TA0-A11 (Two Required)

### REQUIRED MATERIALS

Loctite Threadlocker Blue 242

J-B Weld

### TOOL INFORMATION

Center Punch (commercially available)  
 Deburring Tool (commercially available)  
 Reciprocating Saw (commercially available)  
 Reciprocating Saw Blade  
 (4 inches in length, 4 mm wide, 24 TPI)  
 (commercially available)  
 Rotabroach Tool Kit T/N BLR1120SO

### WARRANTY CLAIM INFORMATION

The normal warranty applies.

Operation Number: 8390A3

Flat Rate Time: 1.2 hours

Failed Part: P/N 66500-TK4-A00ZZ

Defect Code: 01801

Symptom Code: 04501

Skill Level: Repair Technician

### INSPECTION PROCEDURE

1. Open the trunk lid. Detach the clips and remove the cargo hook buttons, then remove the side trim panel from both sides.

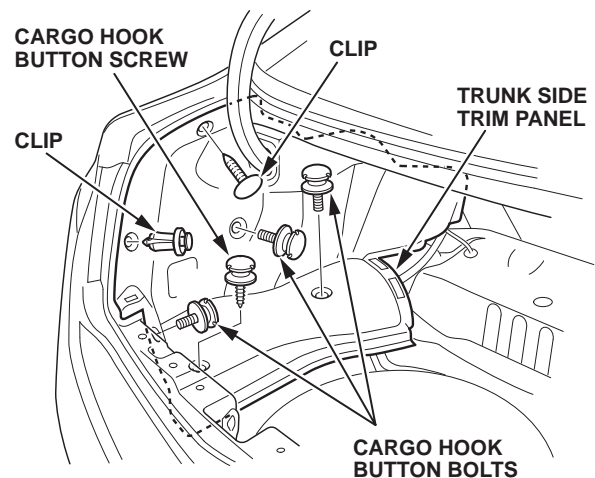

- Lower the trunk upper trim panel to detach the clips, then remove the panel from the trunk compartment.

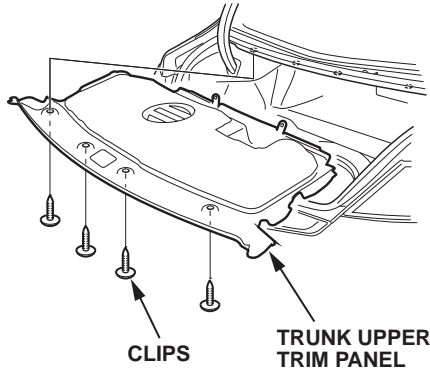

- Visually inspect the rear shelf subwoofer attachment area for cracks.
  - If the rear shelf subwoofer attachment nut area has cracks, go to REPAIR PROCEDURE.
  - If the rear shelf subwoofer attachment area does not have any cracks, this bulletin does not apply; continue with normal troubleshooting.

**Examples of cracks in the underside of the rear shelf**



**REPAIR PROCEDURE**

- While pushing down on the rear seat cushion, pull the seat hook handles to release the hooks.

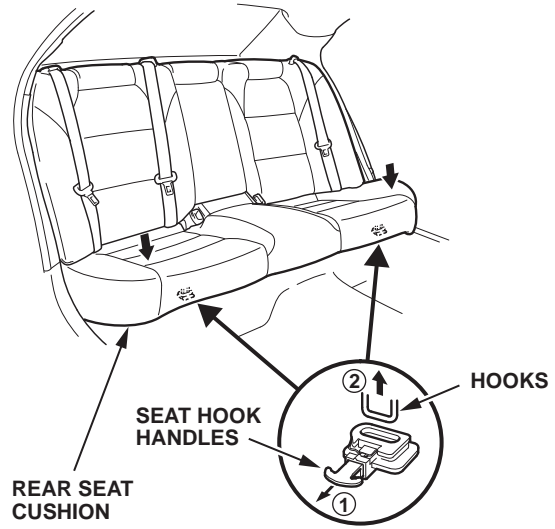

- Remove the seat cushion, and release the center seat belt buckles from the slits.

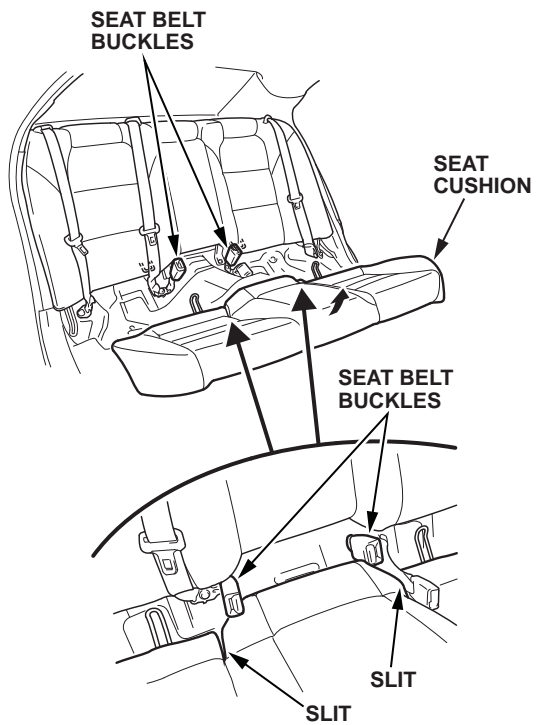

3. Release the seat belts from their guides.

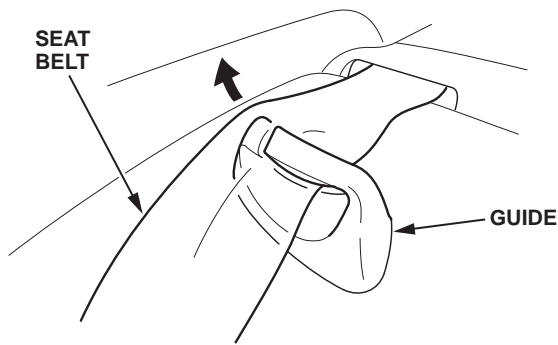

4. Remove the bolts from the base of the seat-back.

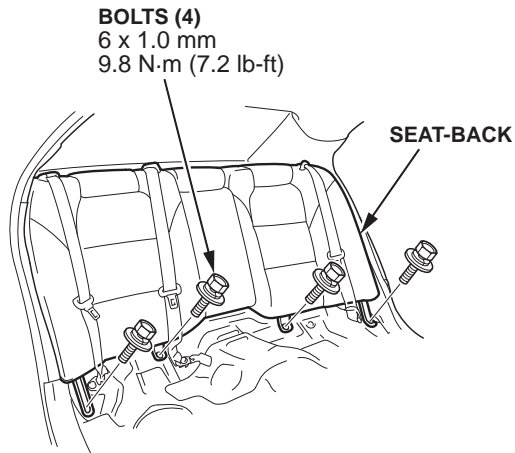

5. Remove the rear seat-back.

- Lift up the bottom of the seat-back
- Push on the seat-back while lifting it up to release the wire loops from the hooks on the body.

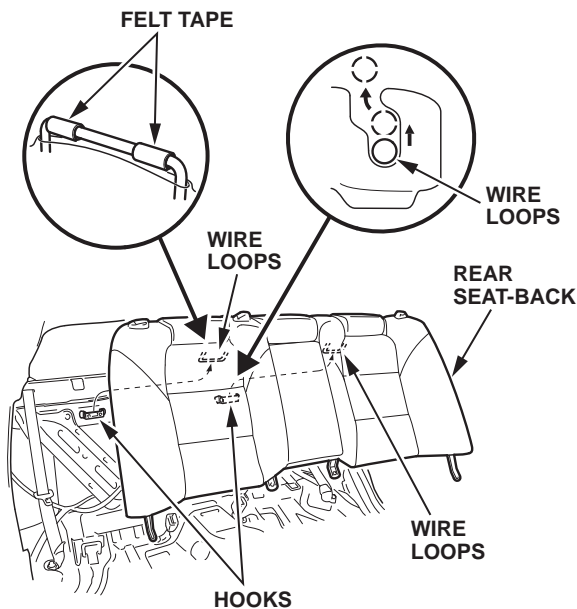

6. Remove the door opening seal as needed.

7. Hit the upper clip in the C-pillar trim with a rubber mallet. Hitting the clip breaks the projections on the pin and pushes it into the grommet on the body.

NOTE: The upper clip must be replaced with a new one when the C-pillar trim is reinstalled.

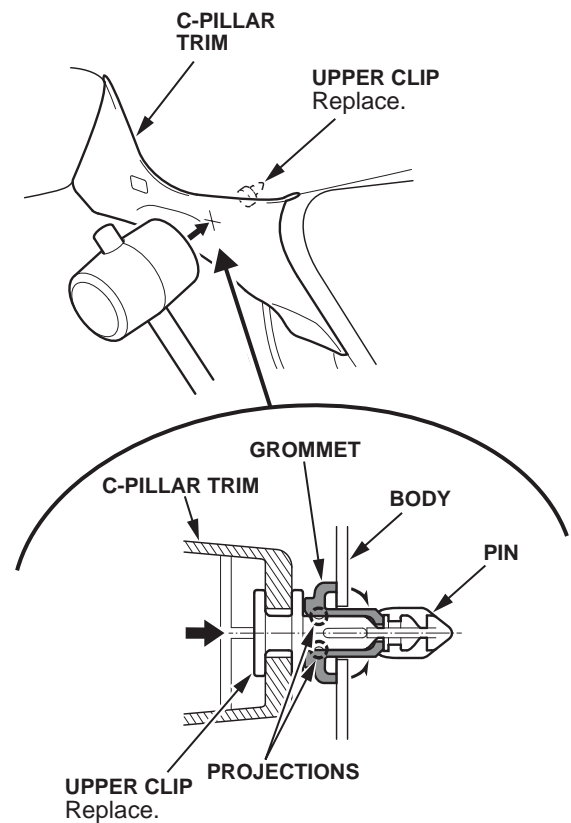

8. Pull back the top of the C-pillar by hand to remove the upper clip from the body.

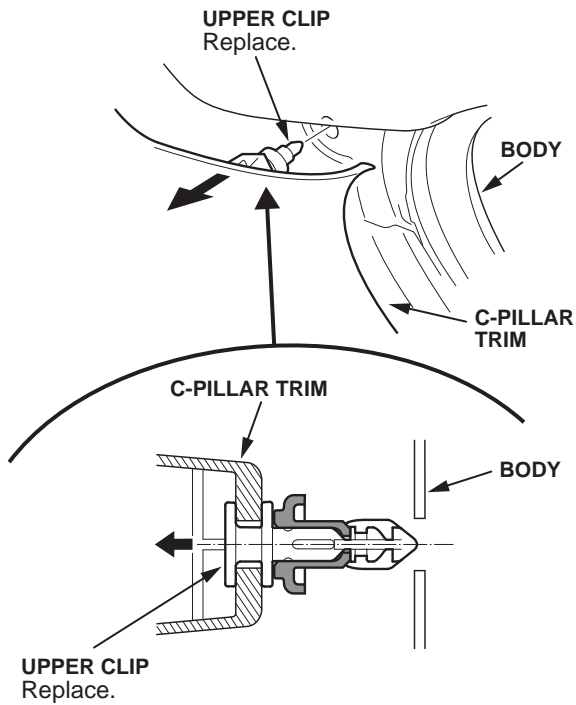

9. Pull the C-pillar trim by hand to detach the clips, then pull out the trim from the rear shelf.

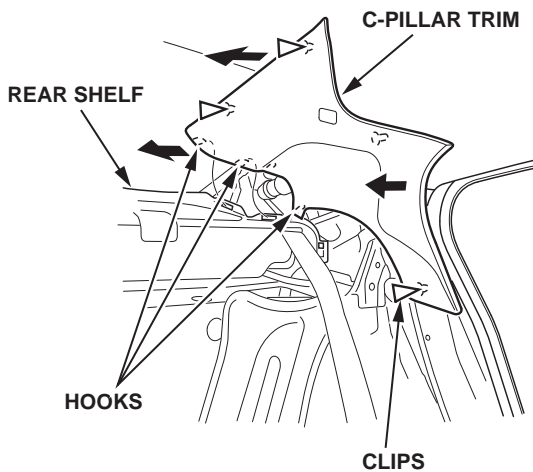

10. Remove the rear shelf.

- Pull up the entire rear shelf to detach the clips.
- Pull both rear seat belts and the rear center seat belt out through the slits in the rear shelf.

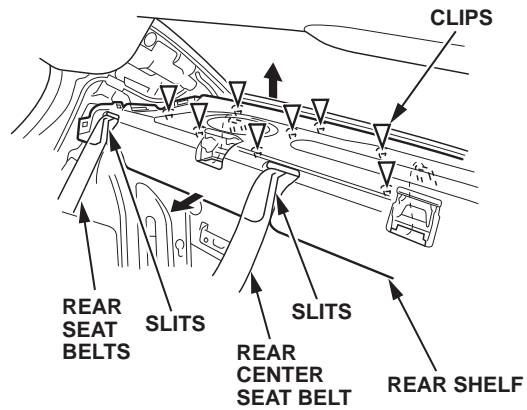
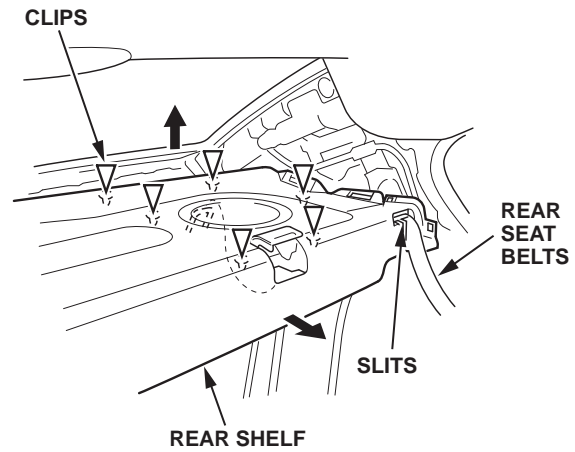

11. Remove the four mounting bolts from the subwoofer.

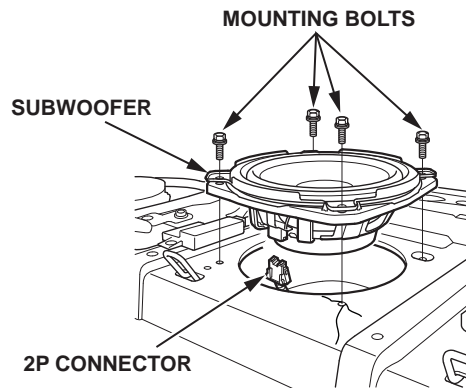

12. Disconnect the 2P connector, and remove the subwoofer.

13. Lay a drop cloth down inside the trunk area, and lay shop towels over the top side of the rear parcel shelf next to the rear speakers and seat belt retractors to protect them from metal debris.

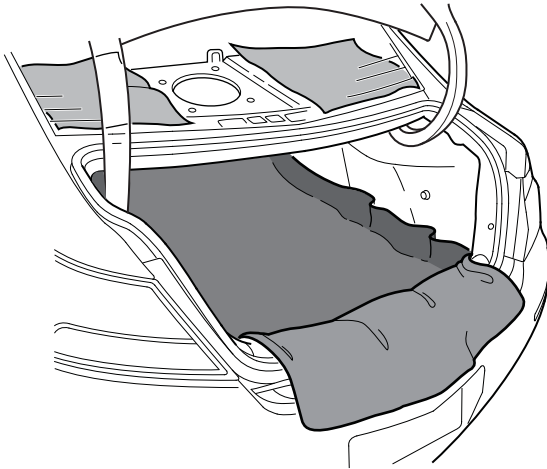

14. Cut out the paper template provided in the kit. Punch four holes in the template where the subwoofer mounting bolts go through.

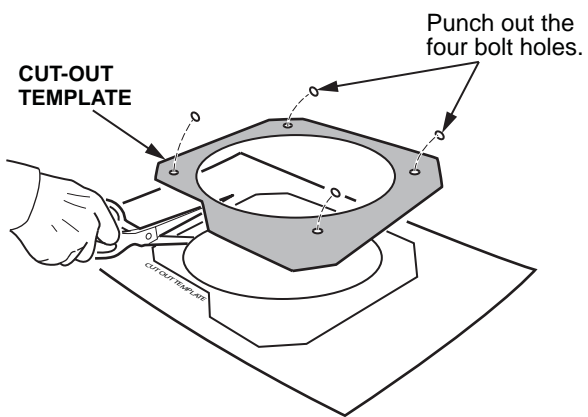

15. Lay the paper template down on the top of the rear parcel shelf and install two bolts in a cross-diagonal location as shown.

NOTE: Use the bolt locations where minimal cracking has occurred.

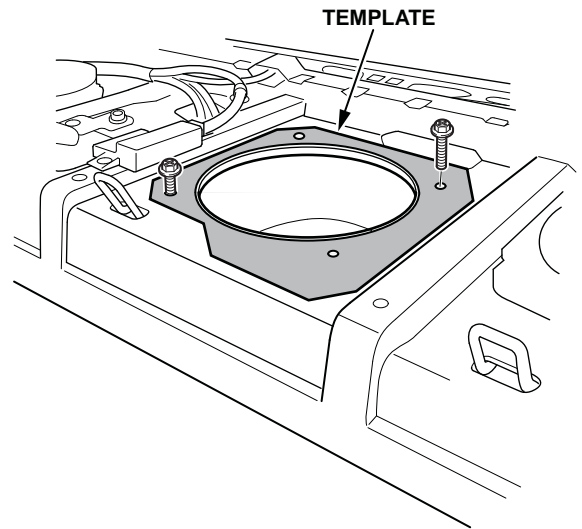

16. Using a felt tip pen, mark an outline of the area to be cut out on the rear parcel shelf.

NOTE: Do not mark a larger section than the size of the template.

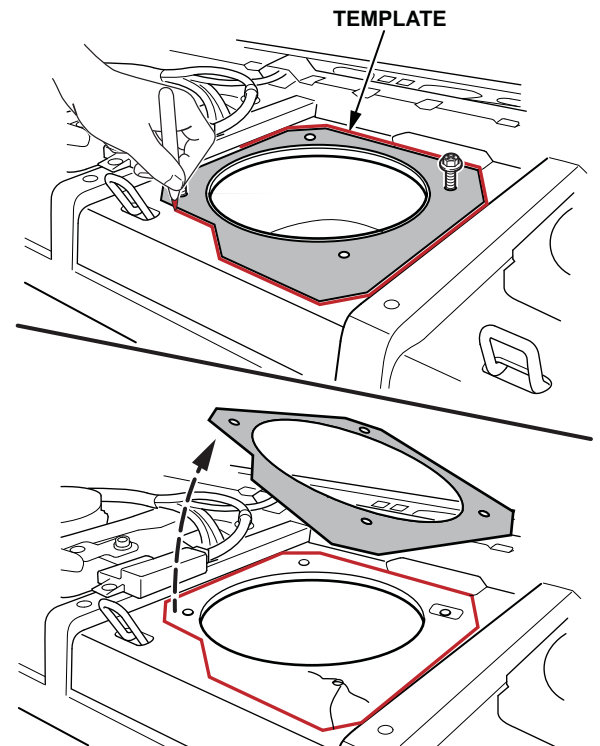

17. Inspect the rear shelf for cracking that may extend past the cut line. If any crack extends beyond the cut line, drill an 1/8" hole into the end of the crack. Fill the hole and crack with J-B Weld.
- NOTE: Deburr the hole, then fill the hole and crack with J-B Weld.

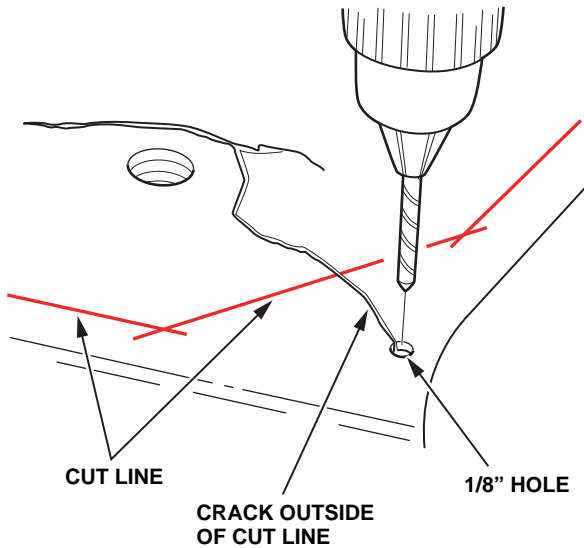

18. From inside the trunk, attach the service plate to the underside of the rear shelf using two bolts in a cross-diagonal location.

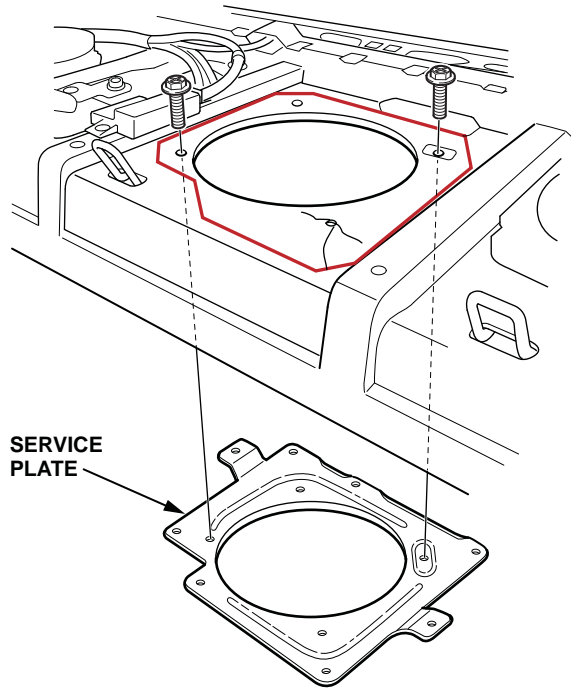

19. Using a felt tip pen, mark the eight holes in the service plate to the rear shelf to be drilled.

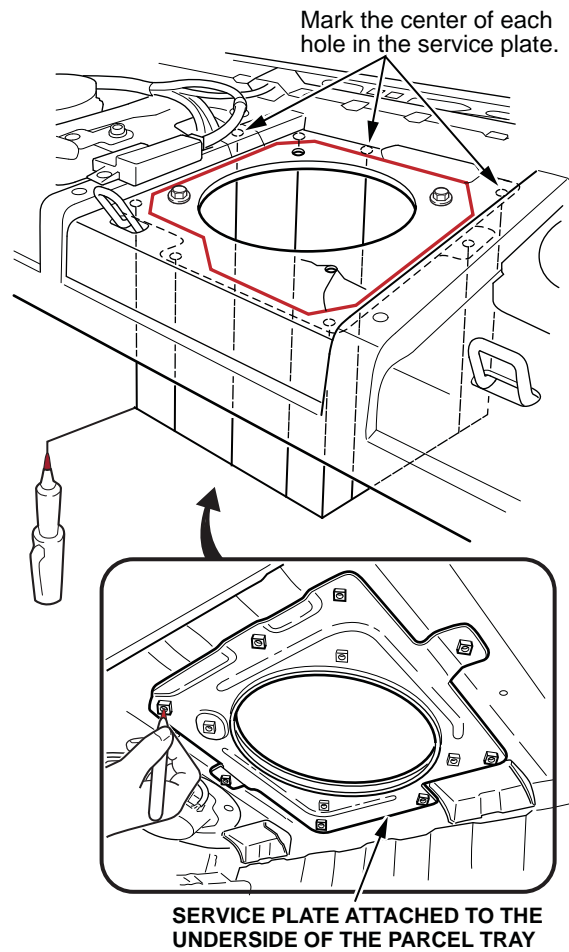

20. Remove the service plate.
21. Use a center punch on each marked hole to prepare the surface for drilling.

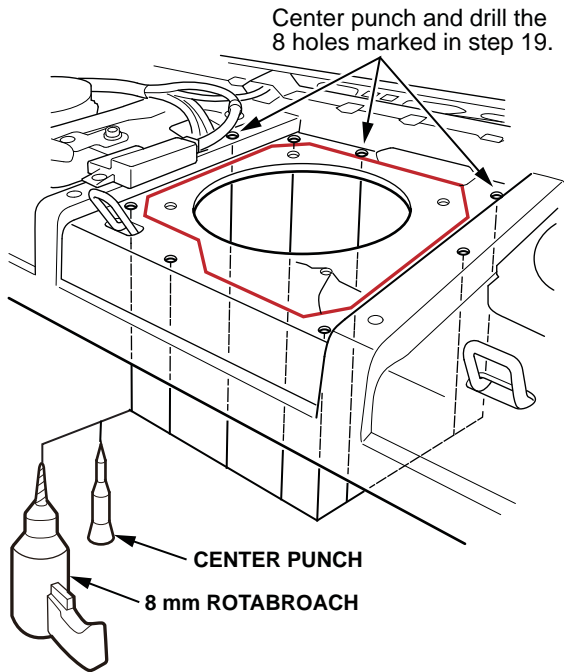

22. Using an 8 mm diameter Rotabroach, drill the eight holes marked into the underside of the rear shelf.  
NOTE: Make sure to remove the metal debris from the top side of the rear parcel shelf before going to the next step.

23. Using a reciprocating saw with a 4 mm wide blade with 24 TPI, cut along the inside of the cut line made in step 16 to remove the damaged area of the rear parcel shelf.

NOTE: Chamfer and round each of the corners.

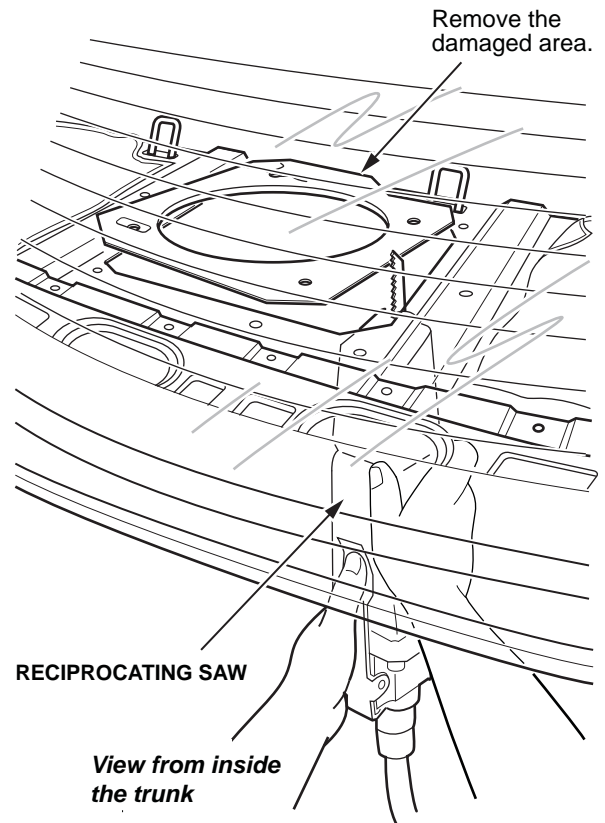

24. Using a deburring tool or metal file, debur and smooth the newly cut area.

NOTE: Use gloves to protect your hands.

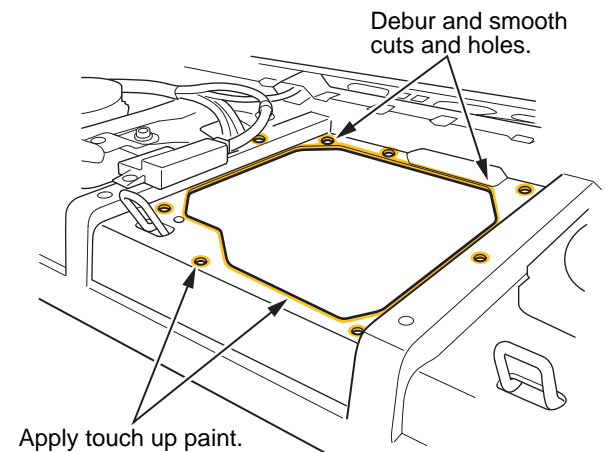

25. Use touch-up paint to coat the newly cut area, drilled holes, and any area where J-B Weld may have been used to prevent rust from occurring.

26. From inside the trunk, install the service plate to the bottom side of the rear shelf. Install the bolts from the top side of the rear shelf and into the service plate. Bolts should be hand tight.

> Service plate

> Bolts

NOTE: Apply blue loctite to the threads of the eight bolts.

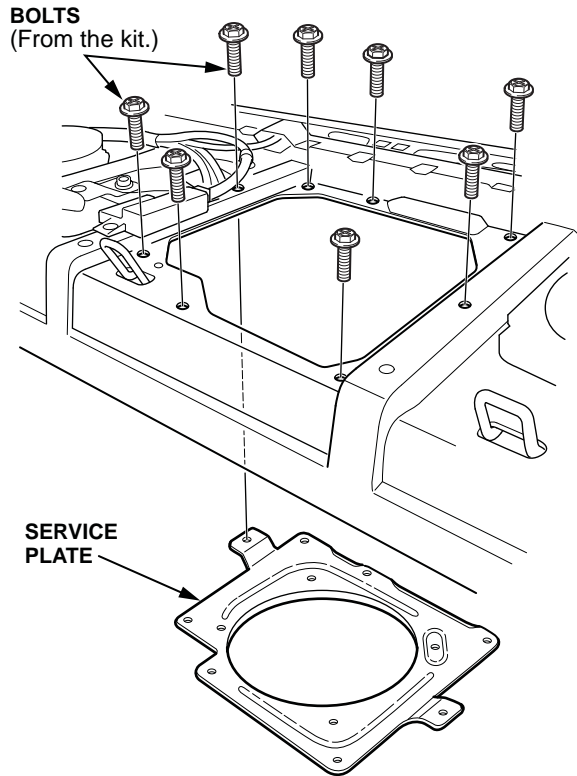

27. Torque the eight service plate bolts to **6.9 to 11.9 N•m (5 to 8.8 lb-ft)**.

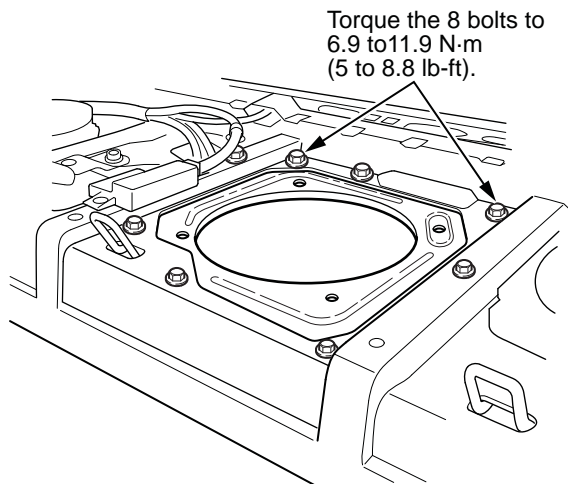

28. Carefully remove the shop towels off the rear speakers and seat belt retractor. Make sure not to drop any metal debris that may be on the towels.

29. Remove the drop cloth from inside the trunk.

30. Separate the plastic trim ring from the subwoofer and install a new one from the kit.

> Subwoofer trim ring.

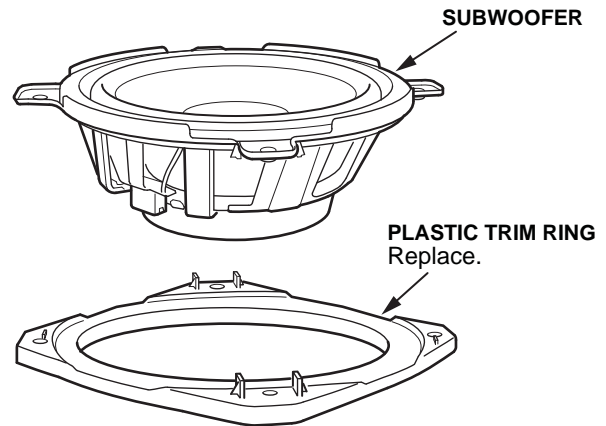



31. If equipped, remove the compass harness and clip from its current location. Apply the twist tube from the kit around the compass harness to protect it from bolt damage.

> Twist tube

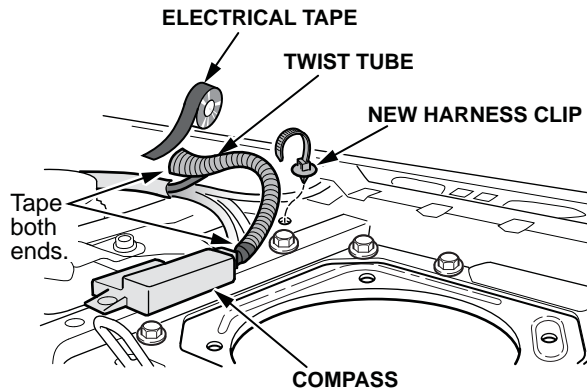

32. Wrap the ends of the twist tube with electrical tape. Then apply a new harness clip from the kit to the location shown.

> Harness clip

33. Install the subwoofer assembly to the new service plate., and torque the bolts to **2.9 to 3.9 N•m (2.2 to 3 lb-ft)**

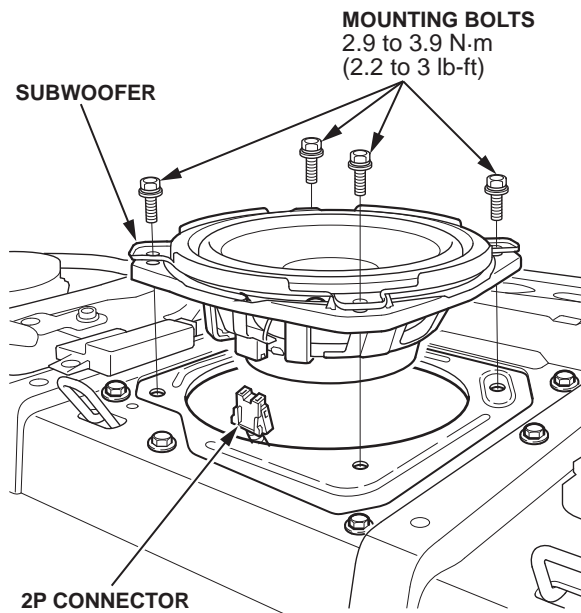

34. Connect the 2P connector to the subwoofer.

35. Vacuum the rear shelf and trunk area to remove any metal shavings.

36. Reinstall the rear shelf.

37. Reinstall the C-pillar trim with the new trim clip.

> C-Pillar trim clip

38. Reinstall the door opening seal.

39. Reinstall the rear seat back and the rear seat cushion.

40. Reinstall the trunk upper and side trim panels.