

- Front Door Panel Removal/Installation

Special Tools Required

- KTC Trim Tool Set SOJATP2014
- Trim Pad Remover Snap-on A 177A or equivalent, commercially available
 - *Available through the Acura Tool and Equipment Program; call 888-424-6857

NOTE:

- Take care not to scratch the door or the related parts.
- Use the appropriate tool from the KTC trim tool set to avoid damage when removing components.
- When prying with a flat-tip screwdriver, wrap it with protective tape to prevent damage.

1. Push on the upper hook (A) with the appropriate trim tool, then pull back the inner handle cap (B) to remove it.

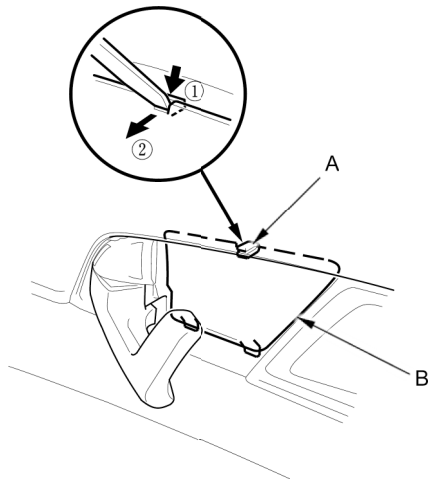

2. Remove the screws securing the inner handle (A).

Fastener Locations

▶ : Screw, 2

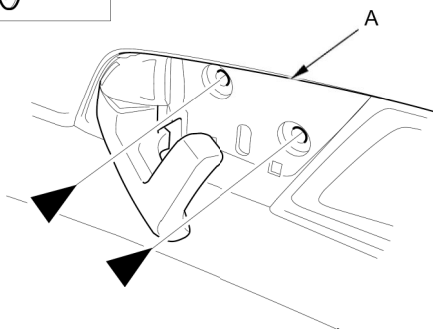

3. Remove the door grip trim (A).
 1. Insert the appropriate trim tool into the notch (B), and pry out along the edge of the trim to release the hooks (C).
 1. Pull up the trim to release the hook (D).

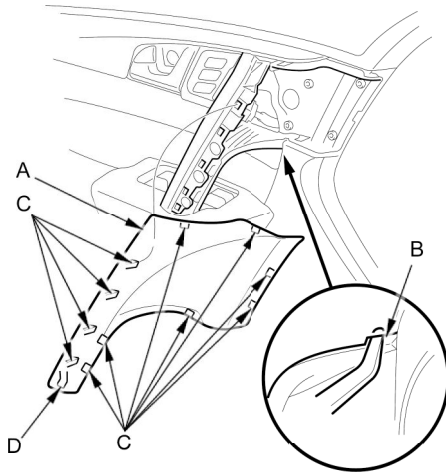

4. Remove the screw.

Fastener Location

▶ : Screw, 1

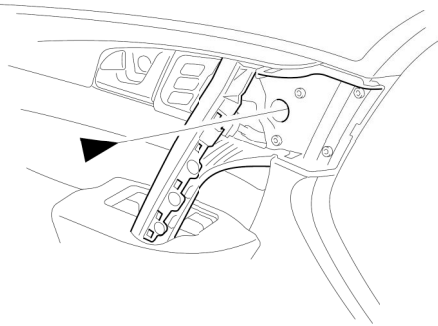

5. Release the hooks (A), and remove the front pull pocket cap (B), then remove the screw.

Fastener Location

▶ : Screw, 1

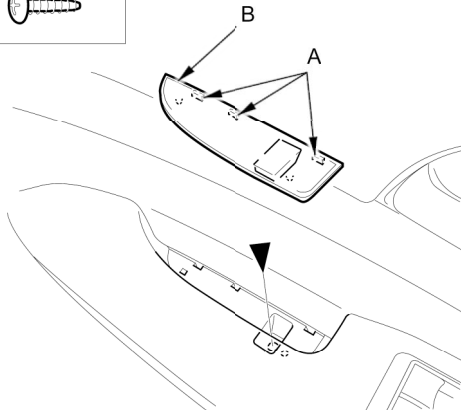

6. From under the armrest, pry out at the notch (A) with the appropriate trim tool, and open the pocket cap (B), then

remove the screw.

Fastener Location

▶ : Screw, 1

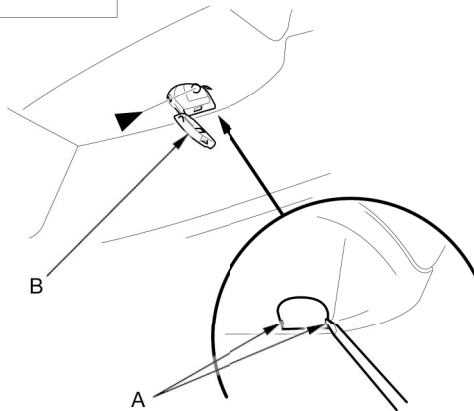

7. Remove the door panel (A) with as little bending as possible to avoid creasing or breaking it.
1. Start at the bottom edge of the door panel, detach the clips (B) with a commercially available trim pad remover.
 1. Detach the remaining clips (C).
 1. Release the door panel from the metal clips (D) attached to the door glass inner weatherstrip.
 1. Starting at the rear, pull out the door panel.
NOTE: The inner handle cable (E) and the latch cable (F) are connected to the inner handle (G). Do not pull up the door panel too far, or these cables will be damaged.

Fastener Locations

B, C ▷ : Clip, 11 D ▷ : Clip, 5

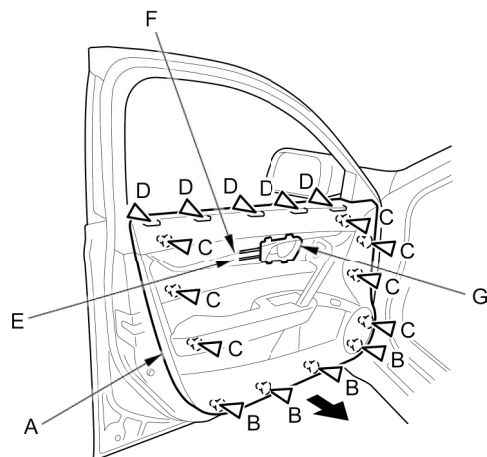

8. While holding the door panel away from the door, detach the clips by pulling out the inner handle (A), then remove the inner handle from the door panel.

Fastener Locations

▷ : Clip, 4

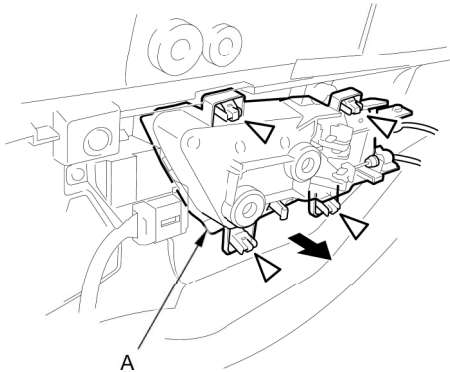
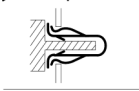

9. While holding the door panel (A) away from the door, remove these items:
1. Driver's door: Disconnect the driver's door wire harness connectors (B, C).
 1. Passenger's door: Detach the harness clip (D), then disconnect the power window switch connector (E) and the courtesy light connector (F).
- NOTE: If you are only removing the door panel, go to step [14](#). If you are doing further disassembly of the door panel, continue to step [10](#).

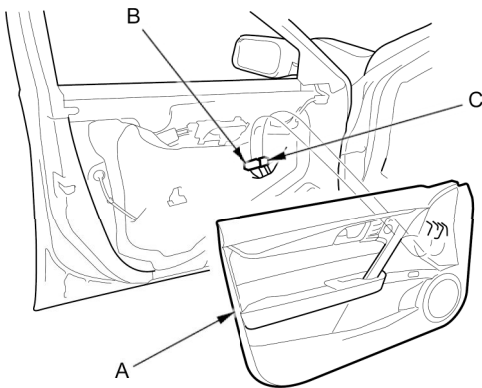
Driver's door**Passenger's door**

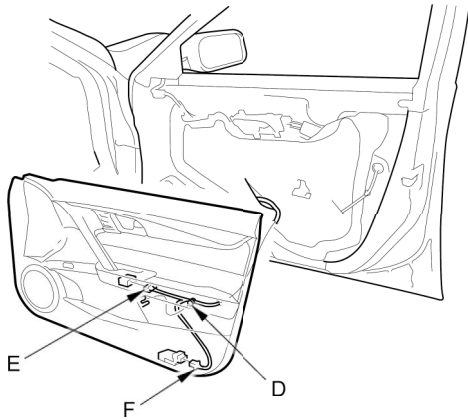

Inner Handle Removal

10. Disconnect the inner handle cable (A) and the latch cable (B) from the inner handle (C), then remove the handle.
 1. Release the inner handle cable fasteners (D, E), then disconnect the inner handle cable from the cable fasteners.
 1. Release the latch cable fastener (F), and remove the latch cable fastener (G) from the inner handle by pinching its tabs together.

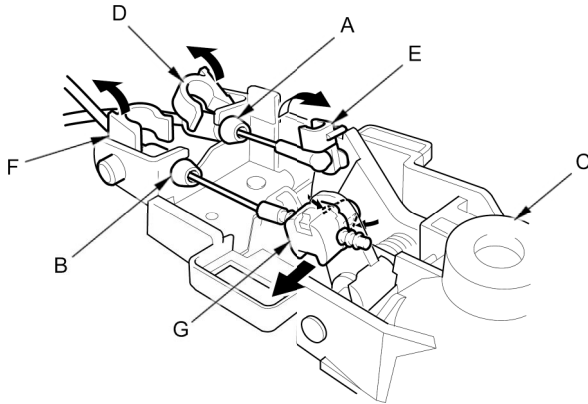

Door End Trim Removal

11. Remove the screw (A), and detach the clips (B), then remove the door end trim (C) by pulling back the trim. The clips (D) will stay in the door.
NOTE: Install the clips D on the door end trim before installing the trim on the door.

Fastener Locations

A ▲ : Screw, 1 B ▷ : Clip, 4 (Gray) D ▷ : Clip, 2 (White)

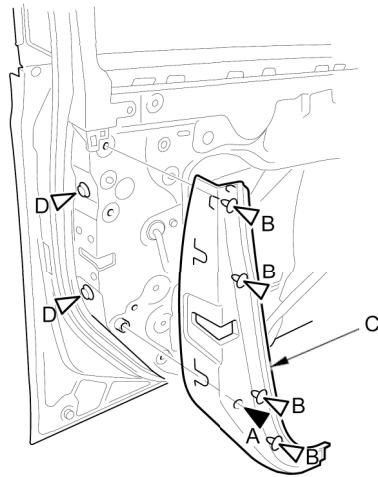
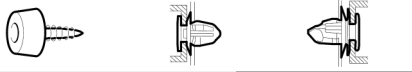
**Armrest Assembly/Grip Assembly Removal**

12. Remove the armrest/grip assembly (A) from the door panel (B).
 1. Disconnect the door subharness connector (C).
 1. Driver's door: Disconnect the seat position memory switch connector (D) and the power mirror switch connector (E).
 1. Remove the screws from back of the door panel and the front of the grip assembly.
 1. Pull out along the edge of the armrest/grip assembly to release the hooks (F).

Fastener Locations

▲ : Screw, 12

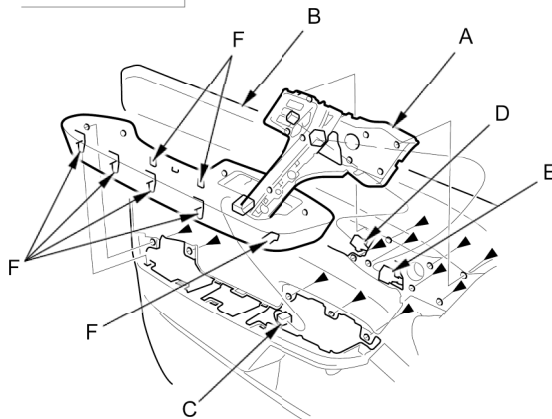
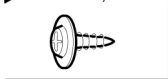

13. Remove the screws, then separate the armrest assembly (A) and the grip assembly (B).

Fastener Locations

▶ : Screw, 2

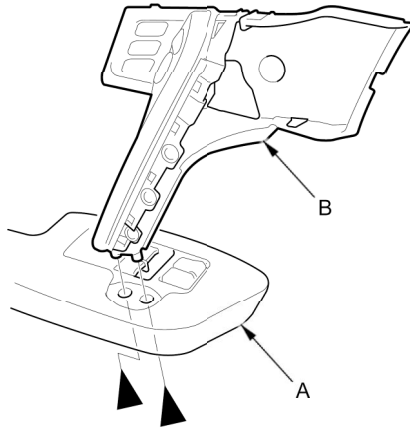
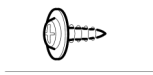

14. Install the door panel in the reverse order of removal, and note these items:
- If the clips are damaged or stress-whitened, replace them with new ones.
 - Replace any damaged cable fasteners with new ones.
 - The latch cable (A) should be fixed to the cable fastener (B) with the latch in the unlocked position as shown.
 - Make sure each connector is plugged in properly, and the cables are connected securely.
 - Make sure the power window, the power door lock, and the power mirror operate properly.
 - When reinstalling the door panel, make sure the plastic cover on the door is installed properly.
 - Push the clips and the hooks into place securely.

