

- Parking Brake Inspection and Adjustment

Inspection

1. Pull the parking brake lever (A) with 196 N (20 kgf, 44 lbf) of force to fully apply the parking brake. The parking brake lever should be locked within the specified number of clicks.

Lever locked clicks: 6 to 8 clicks

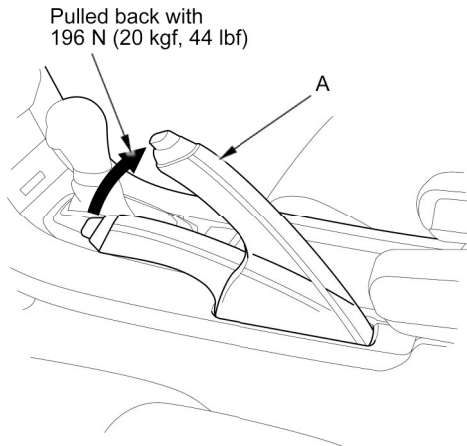

2. If the number of lever clicks is not as specified, adjust the parking brake.
NOTE: Minor parking brake lever adjustments (1 to 2 clicks) can be made with the adjusting nut (see parking brake minor adjustment). If a larger adjustment is required, follow the major adjustment procedure using the adjuster nut at the parking brake drum (see parking brake major adjustment).
After installing new parking brake shoes and/or new brake disc/drum, make sure you [drive the vehicle for "break-in"](#).

Minor Adjustment

1. [Raise and support the vehicle.](#)
2. Release the parking brake lever fully.
3. Remove the console box mat (A), then remove the lid (B).
NOTE: It is easier to use packing tape to remove the console box mat.

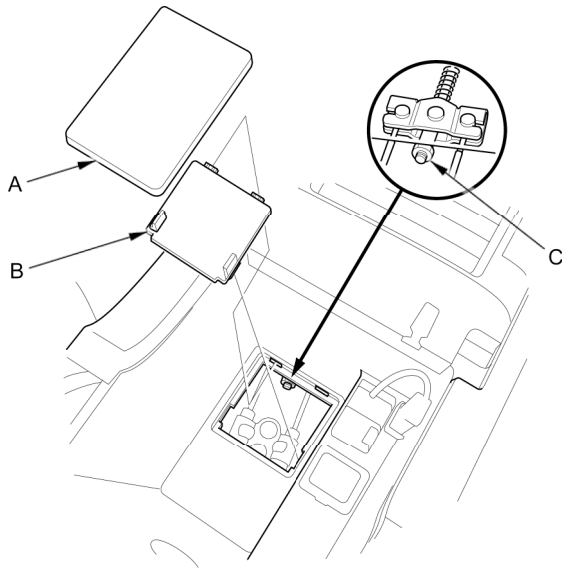

4. Pull the parking brake lever 1 click.
5. Tighten the adjusting nut (C) until the parking brakes drag slightly when the rear wheels are turned.
6. Release the parking brake lever fully, and check that the parking brakes do not drag when the rear wheels are turned. Readjust if necessary.
7. Make sure the parking brake lever is within the specified number of clicks (6 to 8 clicks).
8. Install the lid, then install the console box mat.

Major Adjustment (to be done when replacing parking brake shoes)

1. [Raise and support the vehicle.](#)
2. Release the parking brake lever fully.
3. Remove the console box mat (A), then remove the lid (B).
NOTE: It is easier to use packing tape to remove the console box mat.

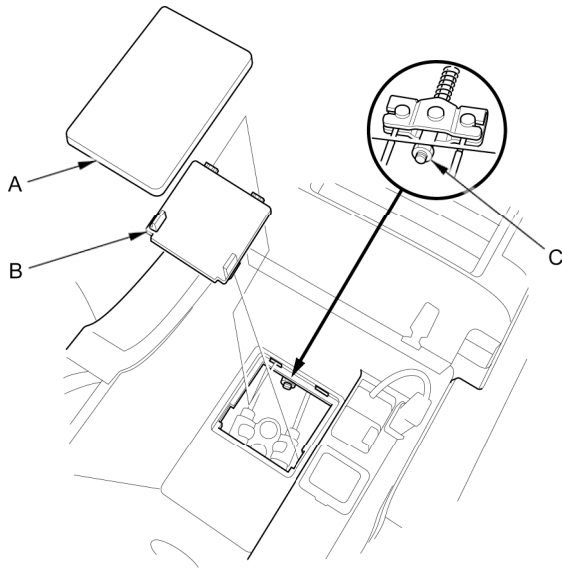

4. Loosen the adjusting nut (C).
5. Remove the rear wheels.
6. Remove the access plug (A).

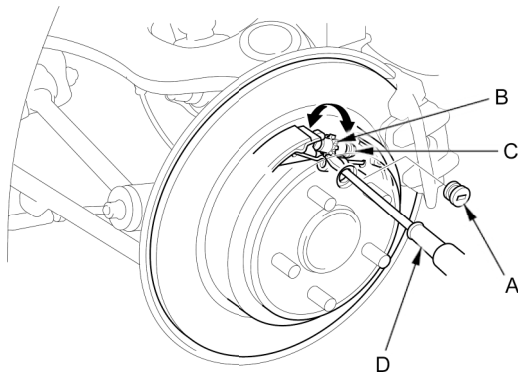

7. Turn the ratchet teeth (B) on the adjuster assembly (C) with a flat-tip screwdriver (D) until the shoes lock against the parking brake drum. Then back off the adjuster 8 clicks, and install the access plug.
8. Do the minor adjustment procedure.
9. Clean the mating surfaces between the brake disc/drum and the inside of the wheel, then install the rear wheels.