



Cylinder Head Inspection for Warp

1. Remove the cylinder head (see page 6-39).
2. Inspect the camshaft (see page 6-49)
3. Check the cylinder head for warp.
Measure along the edges, and three ways across the center.
 - If warp is less than 0.05 mm (0.002 in.), cylinder head resurfacing is not required.
 - If warp is between 0.05 mm (0.002 in.) and 0.2 mm (0.008 in.), resurface the cylinder head.
 - Maximum resurface limit is 0.2 mm (0.008 in.) based on a height of 121 mm (4.76 in.).

Cylinder Head Height:

Standard (New): 120.95–121.05 mm
(4.762–4.766 in.)

PRECISION STRAIGHT EDGE

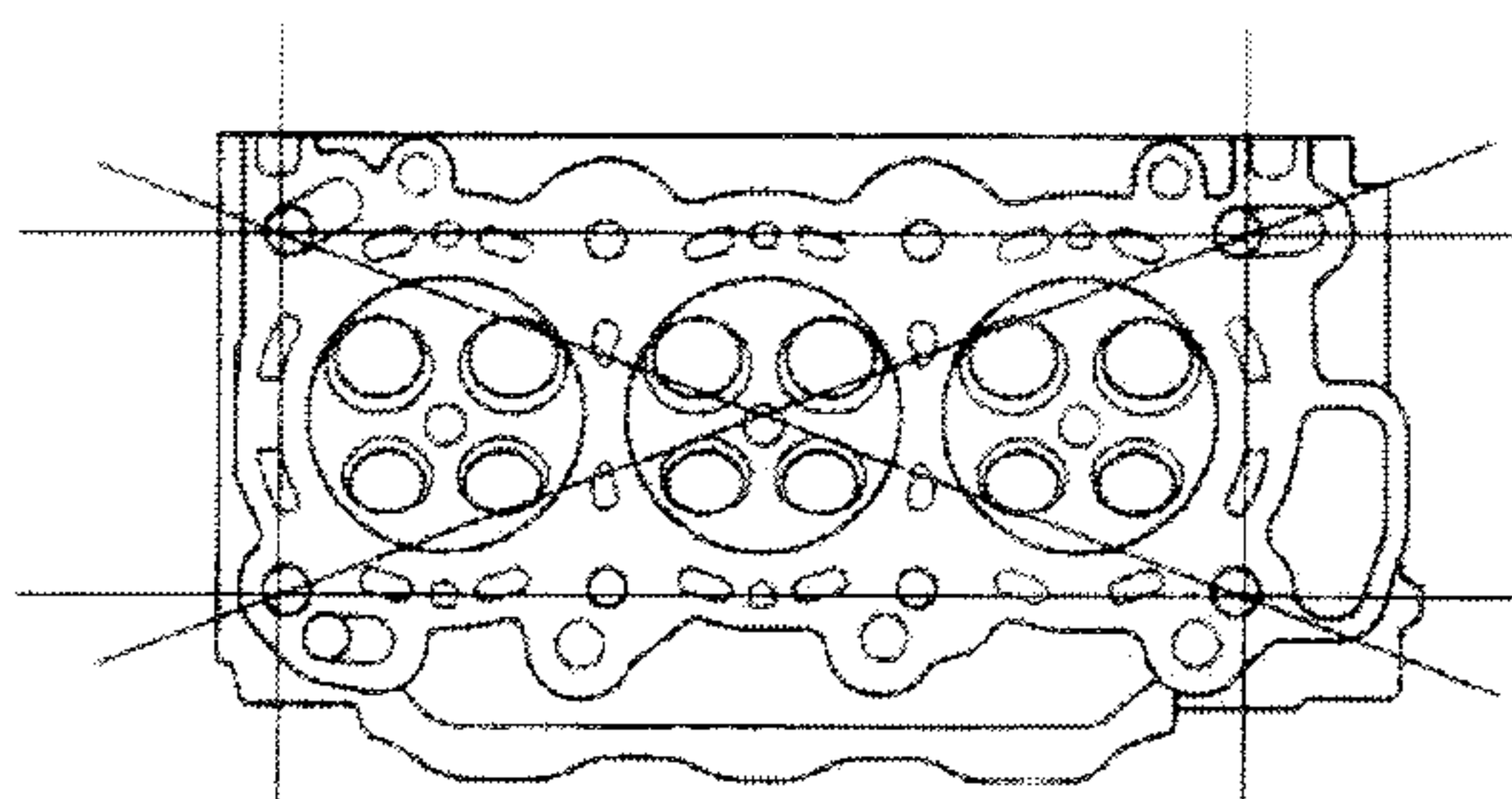
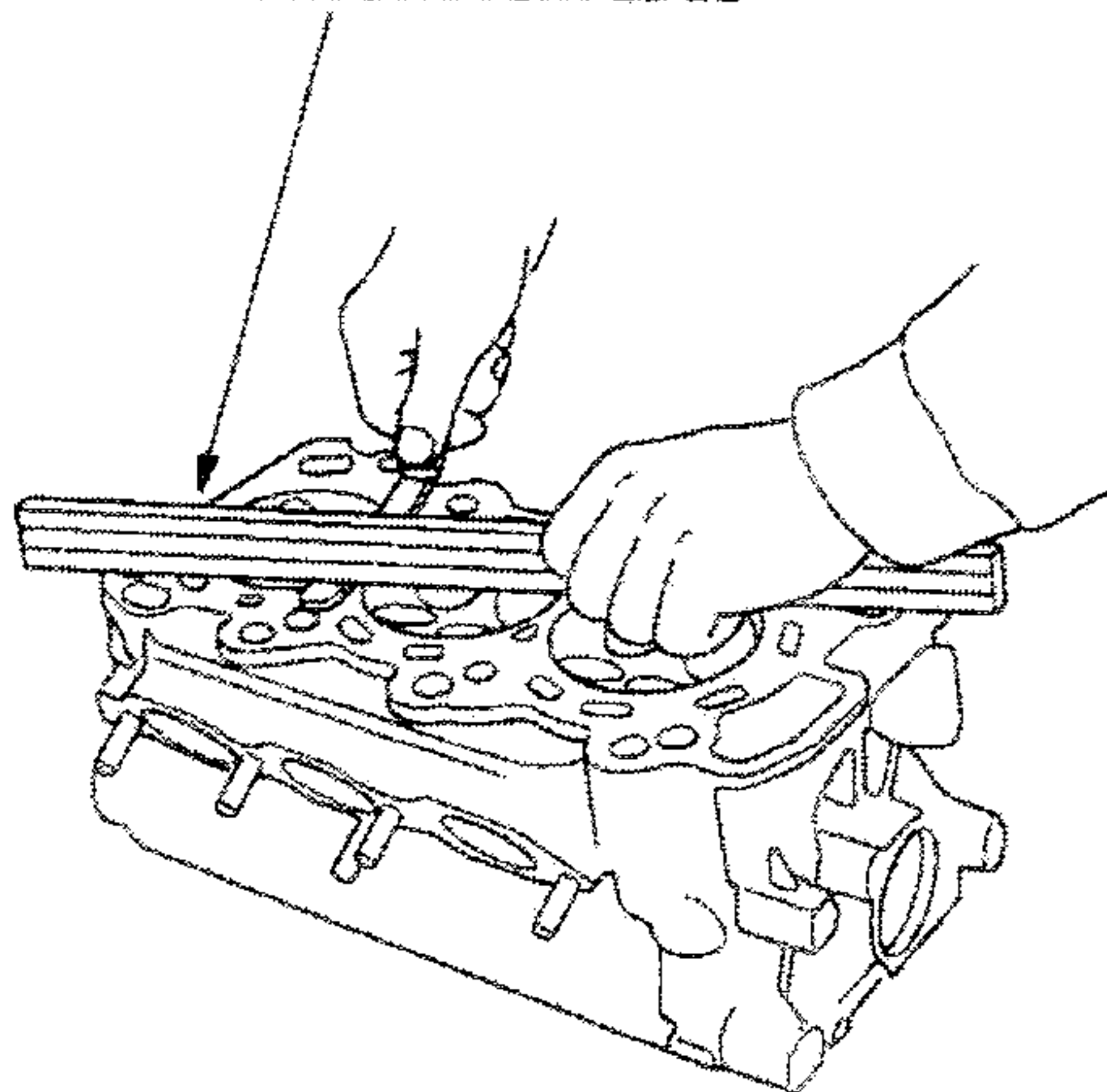

Rocker Arm Assembly Removal

1. Loosen the adjusting screws (A).

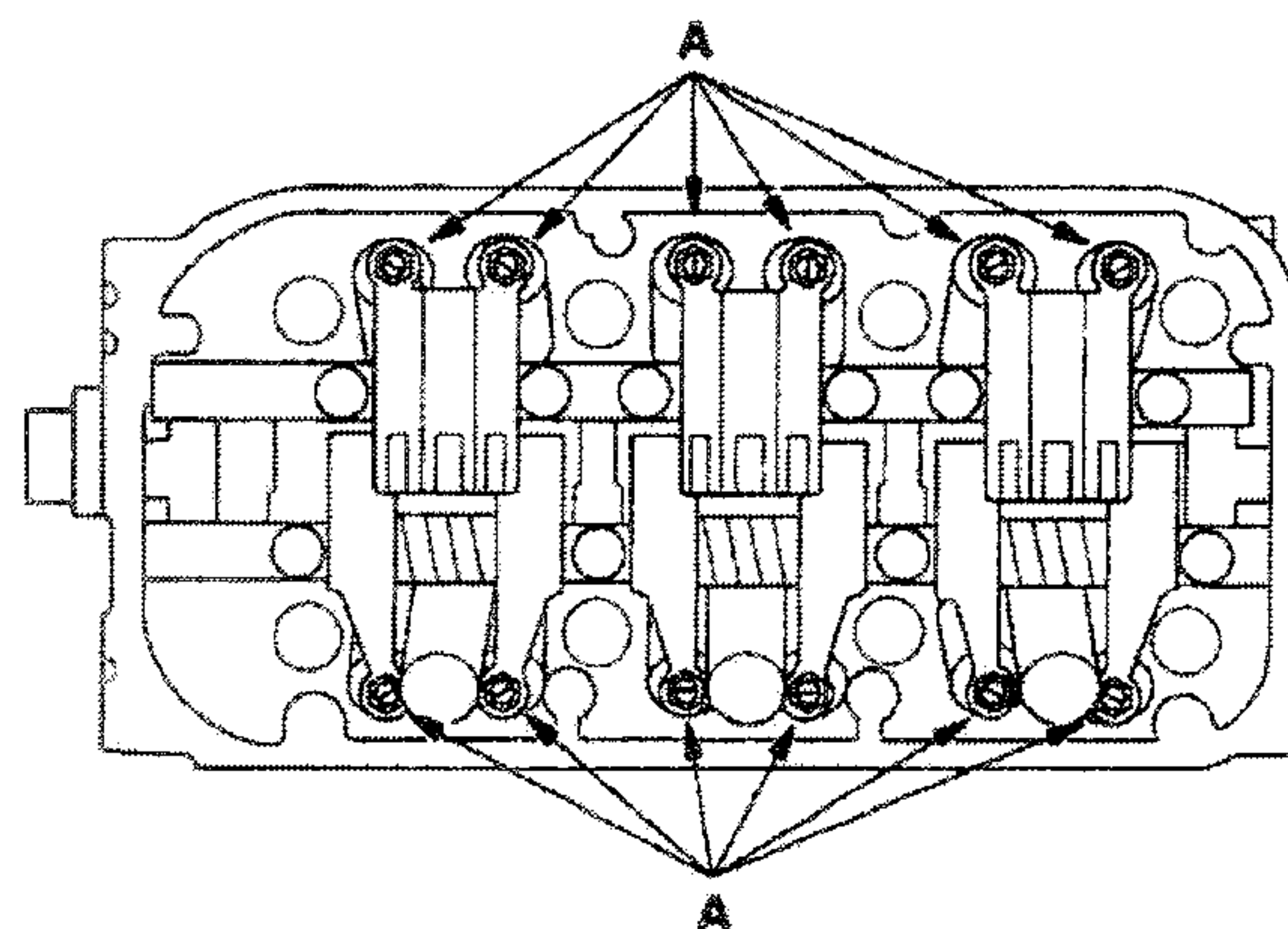

2. Remove the bolts and the rocker arm assembly.

- Unscrew the rocker shaft mounting bolts two turns at a time, in a crisscross pattern, to prevent damaging the valves or rocker arm assembly.
- When removing the rocker arm assembly, do not remove the rocker shaft mounting bolts. The bolts will keep the springs and the rocker arms on the shafts.

CAMSHAFT HOLDER BOLT LOOSENING SEQUENCE:

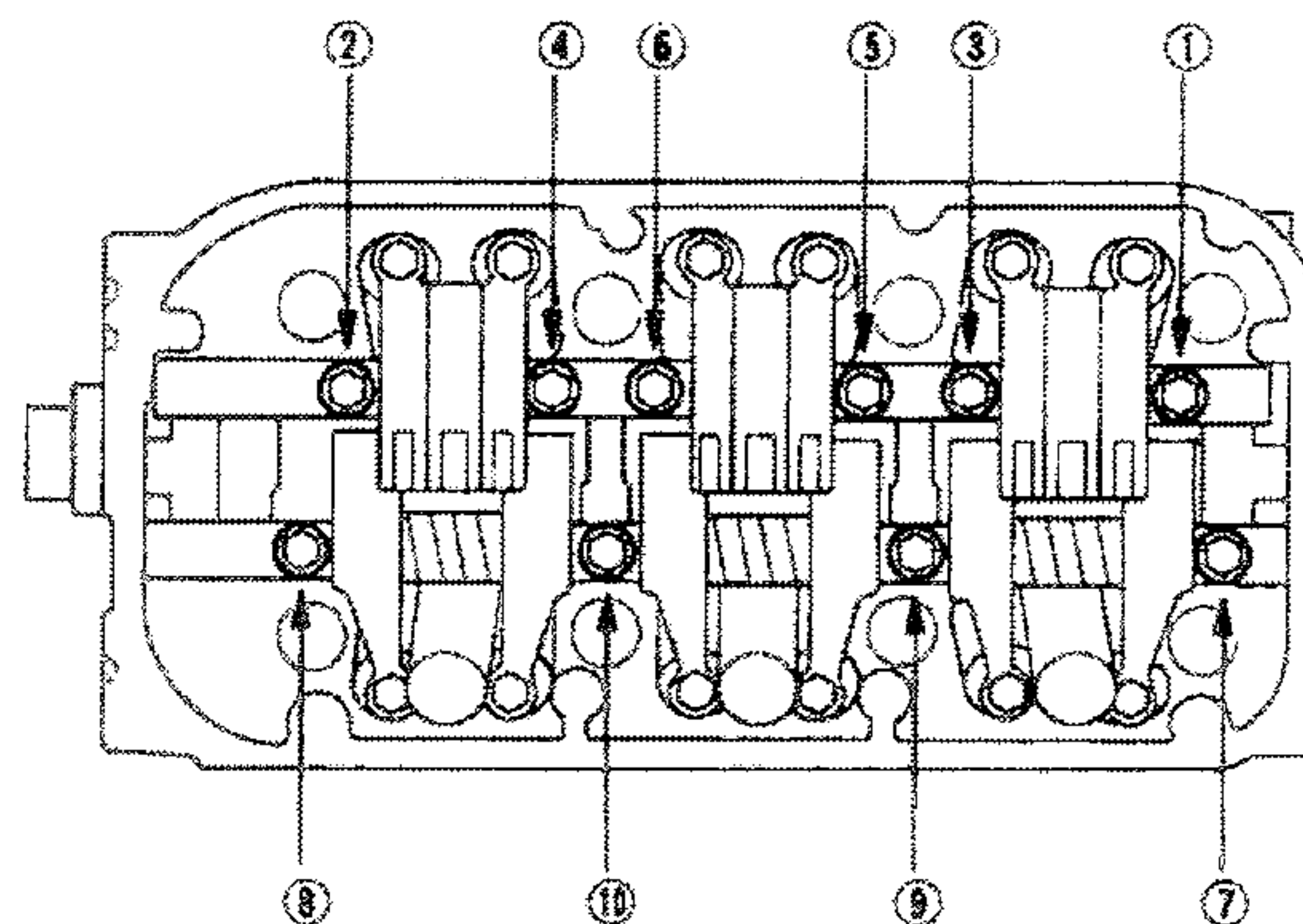



Camshaft/Rocker Arms, Camshaft Seal, and Pulley Installation

1. Apply a light coat of oil around the camshaft oil seal.
2. Gently tap the new camshaft oil seal (A) into the cylinder head.
 - 1 Tap the camshaft oil seal in squarely.
 - 2 Install the oil seal about 0.5—1.5 mm (0.02—0.06 in.) below the surface of the cylinder head.

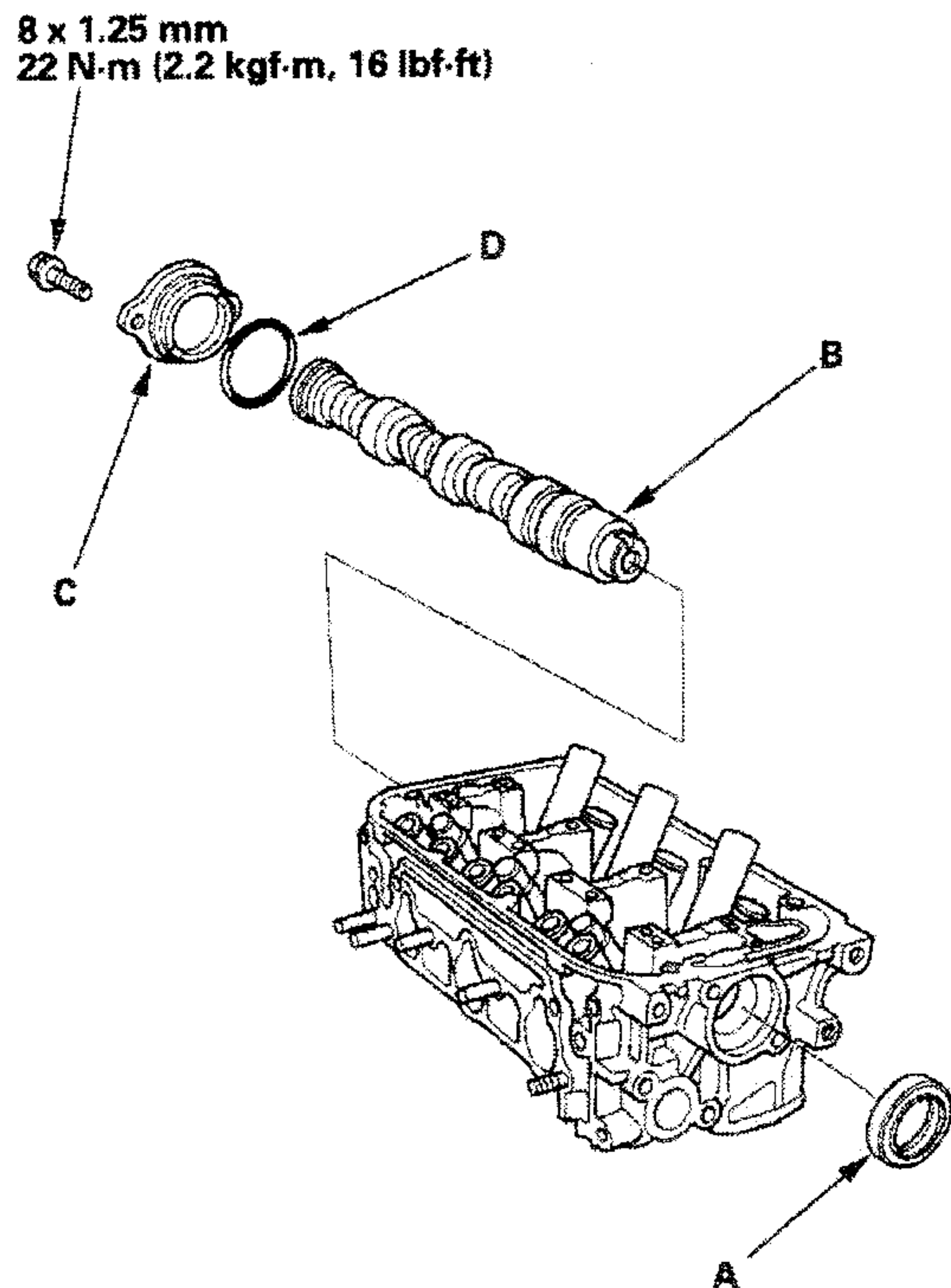

3. Insert the camshaft (B) into the cylinder head, then install the camshaft thrust cover (C). Always use a new O-ring (D).
4. Check that the oil seal lips are not distorted.

5. Loosen the valve adjusting screws.
6. Install the solid dowel pins in the rear of the cylinder head, and the hollow dowel pins in the timing belt end.
7. Set the rocker arm assembly in place and loosely install the bolts. Make sure that the rocker arms are properly positioned on the valve stems.
8. Tighten each bolt two turns at a time in the sequence shown below to ensure that the rockers do not bind on the valves.

Specified torque:

8 x 1.25 mm

24 N-m (2.4 kgf-m, 17 lbf-ft)

Apply engine oil to the bolt threads

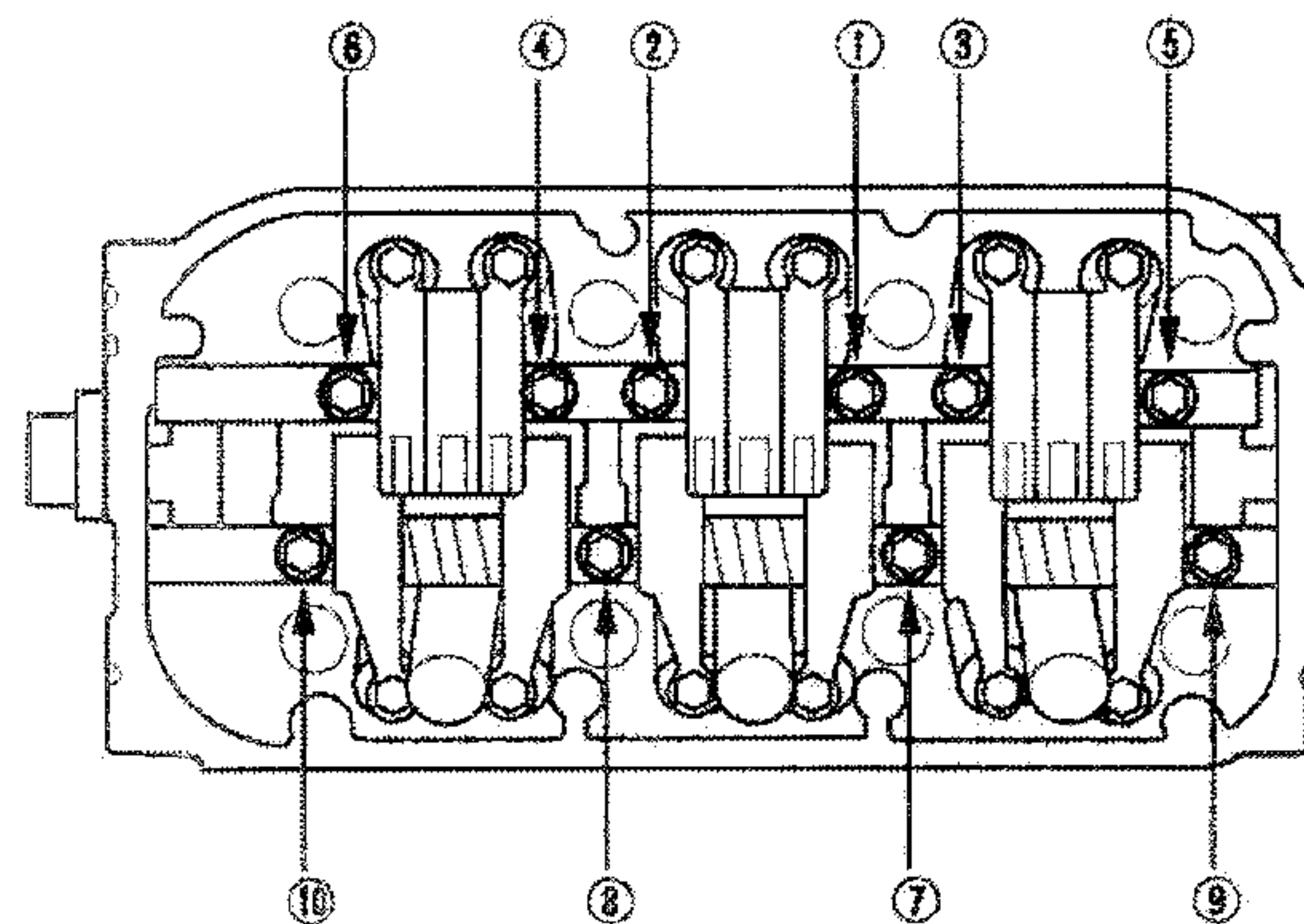

9. Install the injector base (A). Always use a new gasket (B).

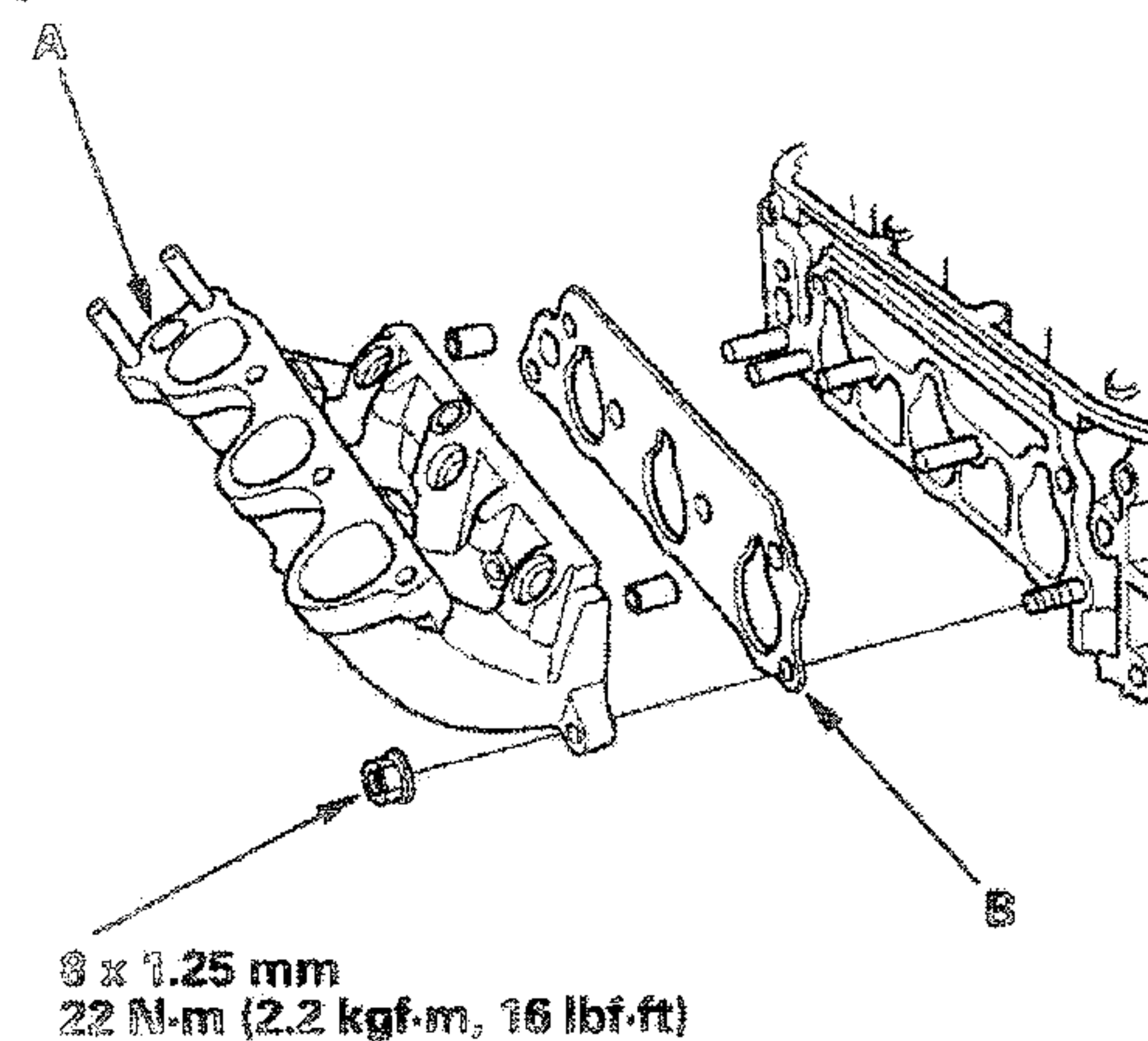

(cont'd)