

- Be careful not to burn yourself.
- Improper ATF level will affect shift quality.

1. ATF Level - Check

NOTE:

- Check the ATF level right after shifting the transmission through all of the positions/modes and turning the engine OFF.
- There are two types of level plugs: integrated washer type and separated washer type.

Preconditions

- Engine Warmed Up (the radiator fan comes on twice)
- [Engine Undercover Removed](#)

Procedure/Specifications

1. Start the engine.

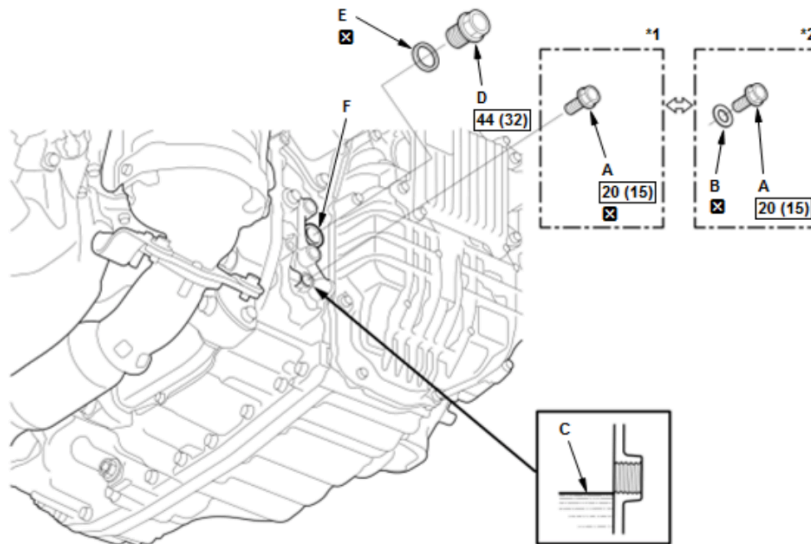

*1: Integrated washer type
*2: Separated washer type

2. While pressing the brake pedal firmly, shift the transmission to P→R→N→D→S→2nd→S→D→N→R→P position/mode, and wait at least 3 seconds in each position/mode.

NOTE: To shift to 2nd gear, enter the sequential sportshift mode by pressing the paddle shifter while in the S position/mode.

3. Turn the engine off.

4. Integrated washer type: Remove the level plug (A).

Separated washer type: Remove the level plug (A) with the sealing washer (B).

5. Make sure the ATF level is at the proper level (C).

Normal Conditions

Proper Transmission Fluid (ATF) Level
The ATF is dripping from the level plug hole.

6. If necessary, remove the filler plug (D) with the sealing washer (E), and add the recommended fluid through the filler plug hole (F) until the ATF overflows from the level plug hole.

NOTE: Using the wrong type of fluid will damage the transmission.

Transmission Fluid (ATF) Type

Specifications
Acura ATF TYPE 2

7. Integrated washer type: Install a new level plug.