

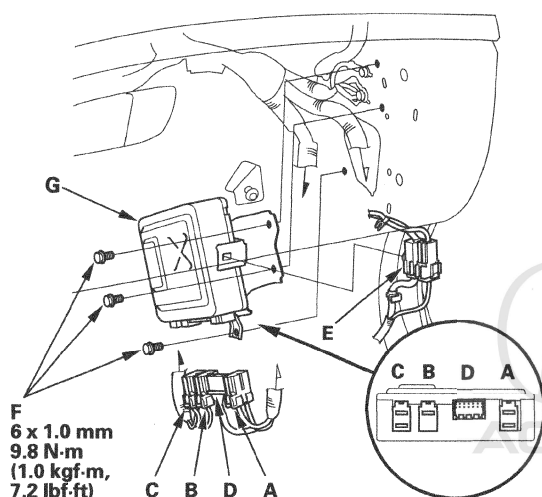

EPS Control Unit Removal/Installation

1. Do the battery terminal disconnection procedure (see page 22-86).
2. Remove these items:
 - Passenger's dashboard undercover (see page 20-131).
 - Passenger's front door sill trim (see page 20-78).
 - Passenger's kick panel (see step 3 on page 20-78).
 - Passenger's under-dash fuse/relay box (see page 22-84).
 - Harness clip (E) from the EPS control unit bracket.



3. Disconnect EPS control unit connector A (2P), connector B (2P), connector C (2P), and connector D (28P).
4. Remove the bolts (F) from the EPS control unit (G).
5. Remove the EPS control unit.

6. Install the EPS control unit in the reverse order of removal.
7. Do the battery terminal reconnection procedure (see page 22-86).
8. Do the torque sensor neutral position memorization (see page 17-23).
9. After installation, start the engine, allow it to idle, and turn the steering wheel from lock to lock several times. Check that the EPS indicator does not come on.