

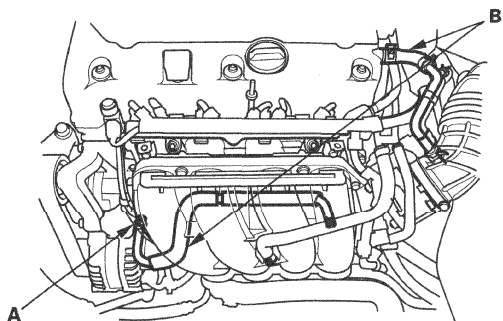

PCV Valve Inspection

1. Check the PCV valve (A), hoses (B), and the connections for leaks or restrictions.



2. At idle, make sure there is a clicking sound from the PCV valve when the hose between the PCV valve and intake manifold is lightly pinched (A) with your fingers or pliers.

If there is no clicking sound, check the PCV valve washer for cracks or damage. If the washer is OK, replace the PCV valve and recheck.

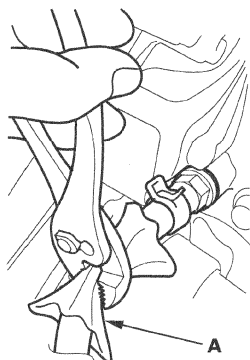

PCV Valve Replacement

1. Disconnect the PCV hose.
2. Remove the PCV valve (A).

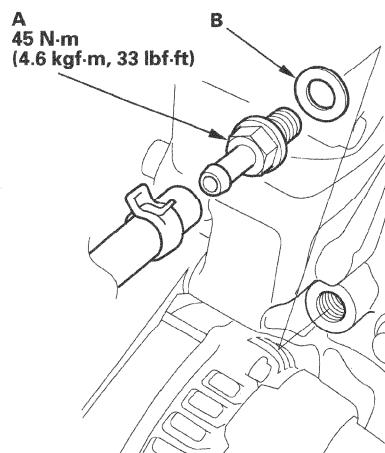

3. Install the parts in the reverse order of removal with a new washer (B).

