

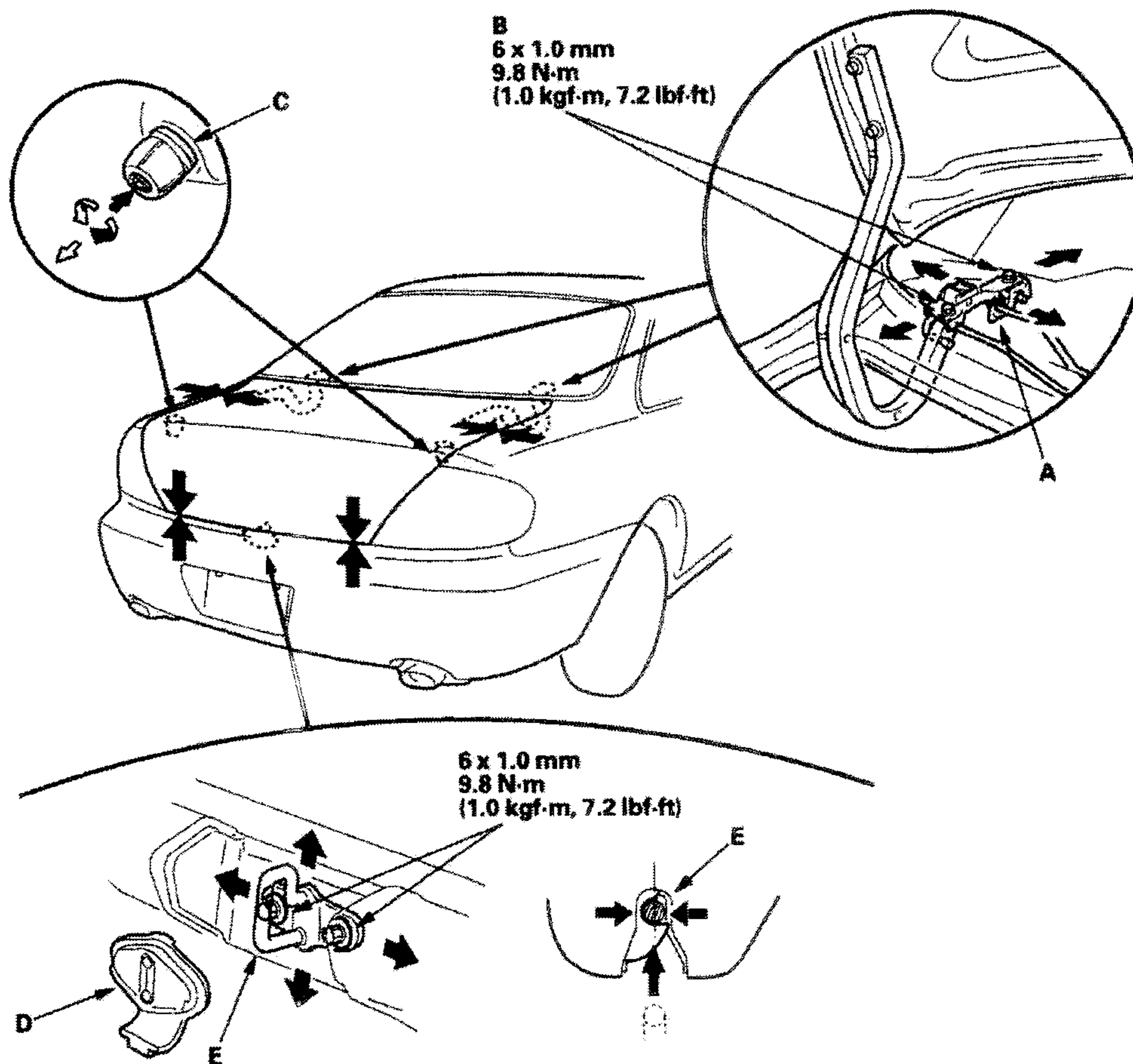

Trunk Lid

Adjustment

1. Slightly loosen each bolt.
2. Adjust the trunk lid alignment in the following sequence.
 - Remove the rear shelf (see page 20-52), and adjust the trunk lid hinges (A) right and left, as well as forward and rearward, by using the elongated holes. Take care not to hit the rear window when loosening the bolts (B).
 - Turn the trunk lid edge cushions (C), in or out as necessary, to make the trunk lid fit flush with the body at the rear and side edges.
 - Remove the trunk rear trim panel (see page 20-54) and striker cover (D), and adjust the fit between the trunk lid and the trunk lid opening by moving the striker (E).



3. Tighten each bolt securely.
4. Make sure the trunk lid opens properly and locks securely.
5. Apply body paint to the trunk lid mounting bolts and around the hinges.