

Modulator Unit Removal and Installation

NOTE:

- Do not spill brake fluid on the vehicle; it may damage the paint; if brake fluid gets on the paint, wash it off immediately with water.
- Take care not to damage or deform the brake lines during removal and installation.
- To prevent the brake fluid from flowing, plug and cover the hose ends and joints with a shop towel or equivalent material.

Removal

1. Disconnect modulator unit connector A (10P), connector B (8P) and the pump motor 2P connector (C).

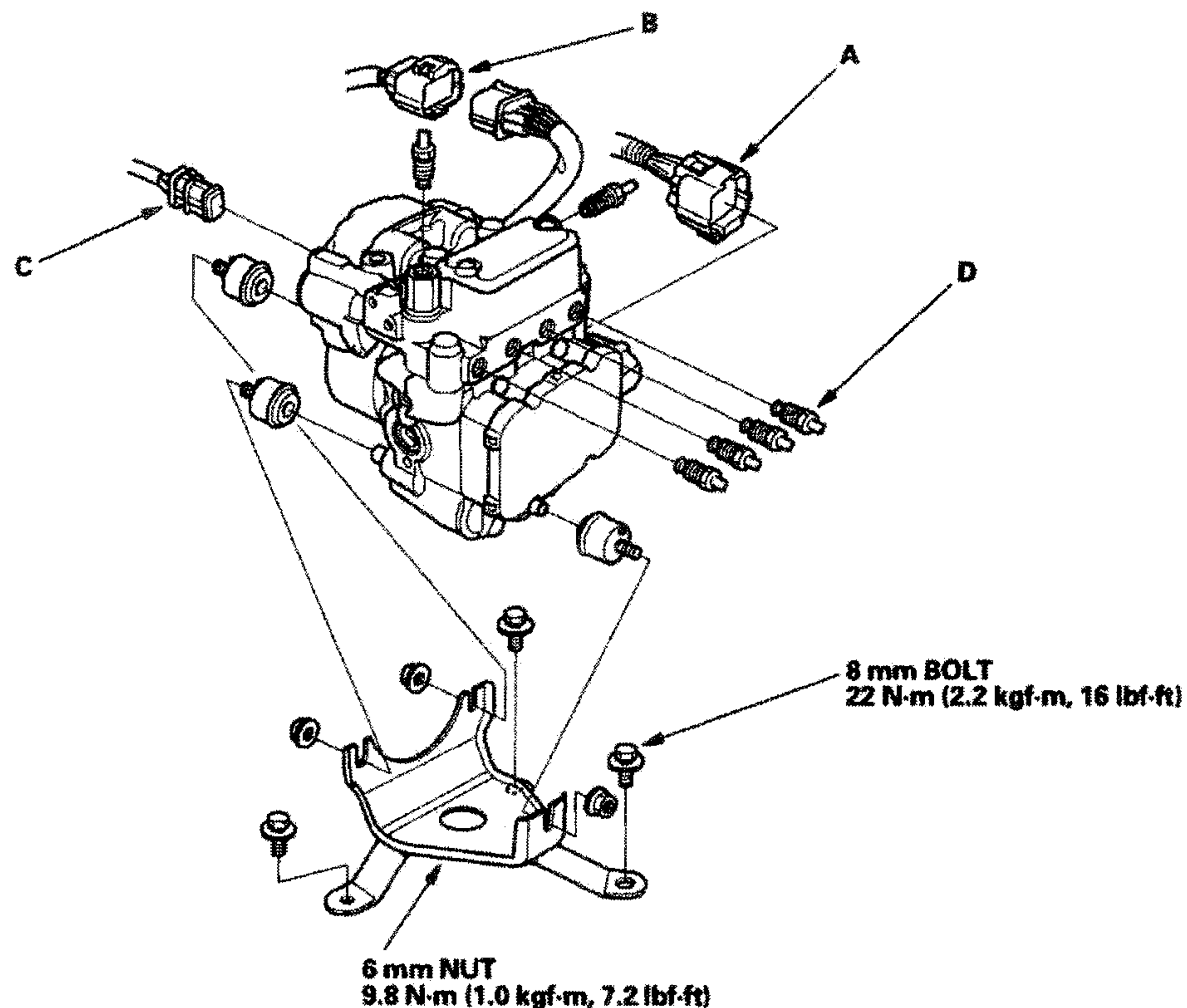

2. Disconnect the six brake lines (D), then remove the modulator unit.

Installation

1. Install the modulator unit in the reverse order of removal. Refill the modulator unit with brake fluid.
2. Bleed the brake system, starting with the front wheels.
3. Start the engine, and check that the ABS indicator and VSA system indicator go off.
4. Test-drive the vehicle, and check that the ABS indicator and VSA system indicator do not come on.

VSA System Components

VSA Modulator Fluid Replacement

1. Clean the area around of the modulator unit.
2. Remove the reservoir cap (A), diaphragm plate (B), filter (C), and diaphragm (D).

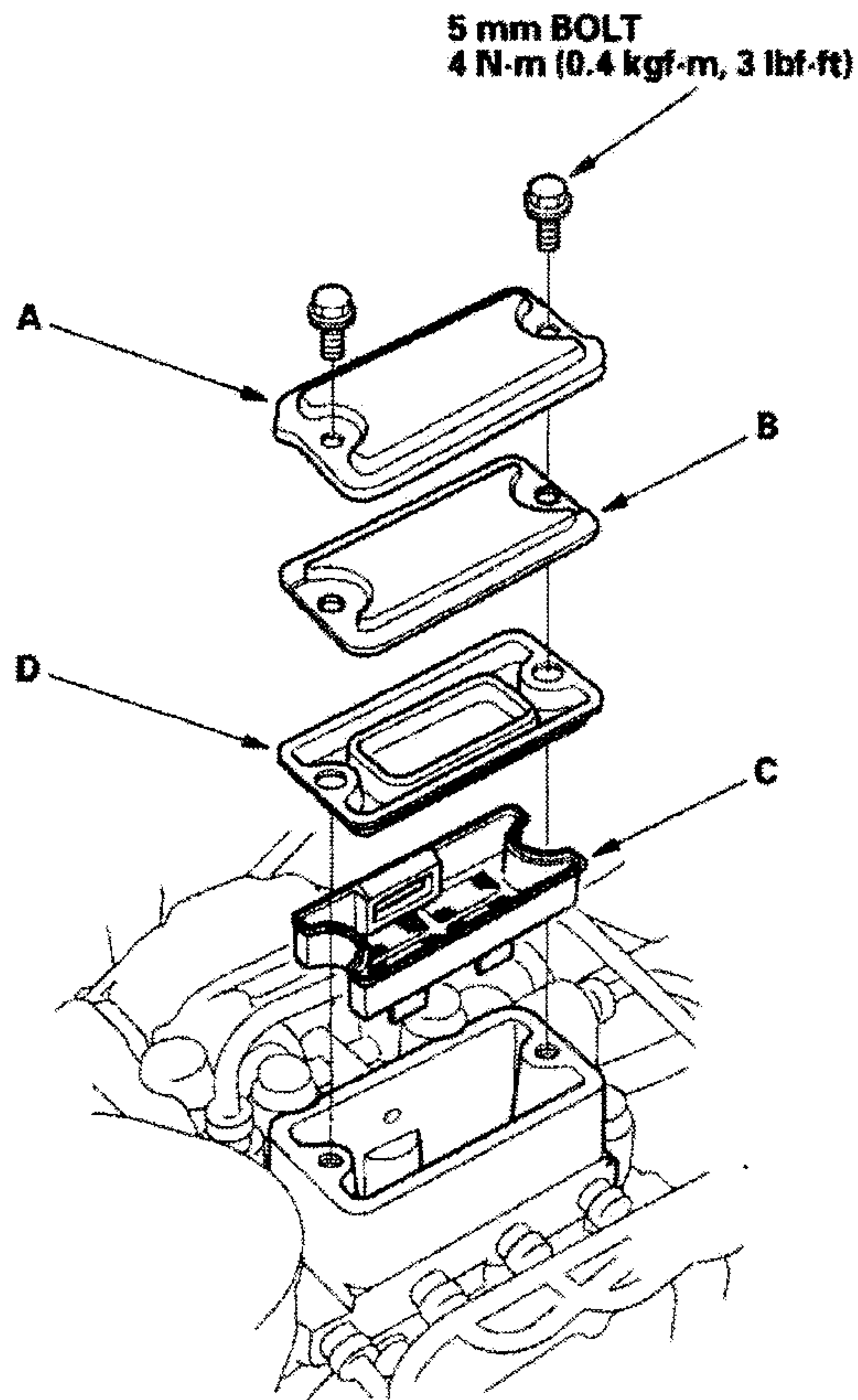

3. Clean the filter.
4. Remove the brake fluid from the VSA reservoir.

NOTE: Do not spill brake fluid on the vehicle; it may damage the paint; if brake fluid gets on the paint, wash it off immediately with water.

5. Install the filter.
6. Fill the VSA reservoir with brake fluid until it reaches the upper line of the filter.
7. Install the diaphragm, diaphragm plate, and reservoir cap, then hand-tighten the bolts.

8. Operate the pump motor by driving the vehicle at 6 mph (10 km/h) or more.

9. Repeat steps 1 through 8.

10. Test-drive the vehicle at 18 mph (30 km/h) or more for a few seconds, and check that the ABS indicator and VSA system indicator do not come on.

11. Tighten the VSA reservoir cap bolts to the specified torque.