



Door Outer Handle Cover Is Loose or Missing

(Supersedes 09-042 , dated November 6, 2009, to revise the information marked by the black bars)

REVISION SUMMARY

Under WARRANTY CLAIM INFORMATION, the failed part number was changed.

SYMPTOM

The front or rear body-colored outer door handle cover (end cap) is loose or missing.

PROBABLE CAUSE

The locking tab on the plastic door outer handle cover is breaking, causing the cover to loosen or fall off.

CORRECTIVE ACTION

Replace the loose or missing door outer handle cover.

PARTS INFORMATION

Left Front Door Outer Handle Cover:
P/N 72184-SJA-A01Z*

Right Front Door Outer Handle Cover:
P/N 72144-SJA-A11Z*

Left Rear Door Outer Handle Cover:
P/N 72184-SJA-J11Z*

Right Rear Door Outer Handle Cover:
P/N 72144-SJA-A11Z*

*To make sure the correct door outer handle cover is ordered, enter the vehicle's VIN in your parts catalog search.

SPECIAL TOOLS

- KTM trim tool set: SOJATP2014
- Trim pad remover, Snap-on A177A or equivalent, commercially available

WARRANTY CLAIM INFORMATION

The normal warranty applies.

OP#	Description	FRT
8181C2	Remove and replace one front door outer handle cover.	0.3
8211E9	Remove and replace one rear door outer handle cover.	0.4

Failed Part: 72184-SJA-J11ZC
 Defect Code: 06201
 Symptom Code: 01201
 Skill Level: Repair Technician

REPAIR PROCEDURE – FRONT DOOR HANDLE

NOTE: Put on gloves to protect your hands.

- Use the appropriate tool from the KTC trim tool set to avoid damage when prying parts
- Take care not to scratch or damage the door panel or other interior trim pieces.

1. Fully raise the front door glass.
2. Using a trim tool, push on the bottom hook and pivot the cover on the upper hooks, detach the front hook, then remove the cover and the screw securing the inner handle.

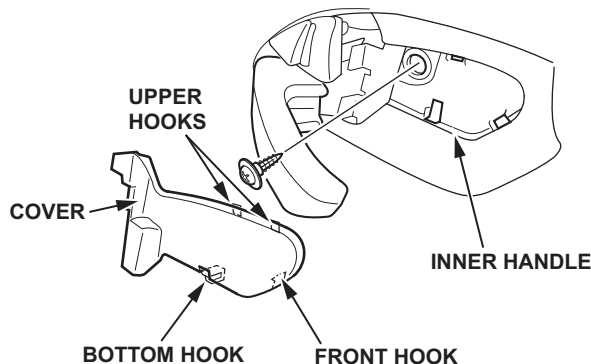

CLIENT INFORMATION: The information in this bulletin is intended for use only by skilled technicians who have the proper tools, equipment, and training to correctly and safely maintain your vehicle. These procedures should not be attempted by “do-it-yourselfers,” and you should not assume this bulletin applies to your vehicle, or that your vehicle has the condition described. To determine whether this information applies, contact an authorized Acura automobile dealer.

3. Using a trim tool, pull the top edge of the pocket light cover out to release the hooks and the cover, then remove the screw.

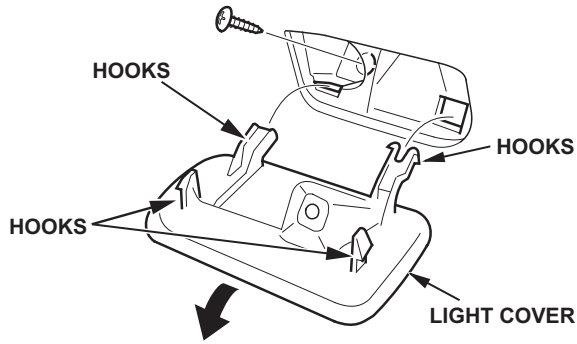

4. Using a trim tool, pry out the notch of the grip cover to detach the hook, pull out the cover to release the remaining hooks, then remove the cover from the grip.

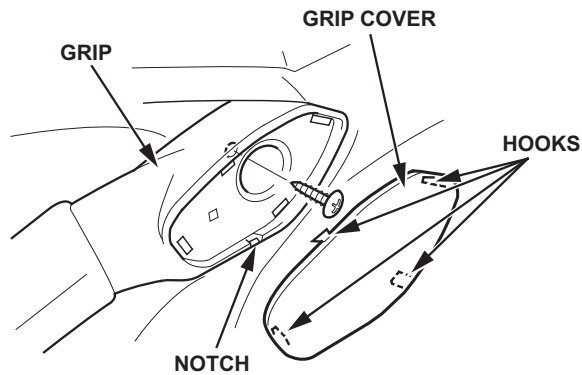

5. Remove the door panel with as little bending as possible to avoid creasing or breaking it.
- Release the clips that secure the door panel with a commercially available trim pad remover.
 - While holding the door panel away from the door, disconnect the door subharness connector and the power mirror connector.
 - While holding the door panel away from the door, remove the screws, then remove the inner handle from the door panel.

NOTE: The inner handle cable and the lock cable are connected to the door panel. Do not pull the door panel up too far, or the inner handle cable will be damaged.

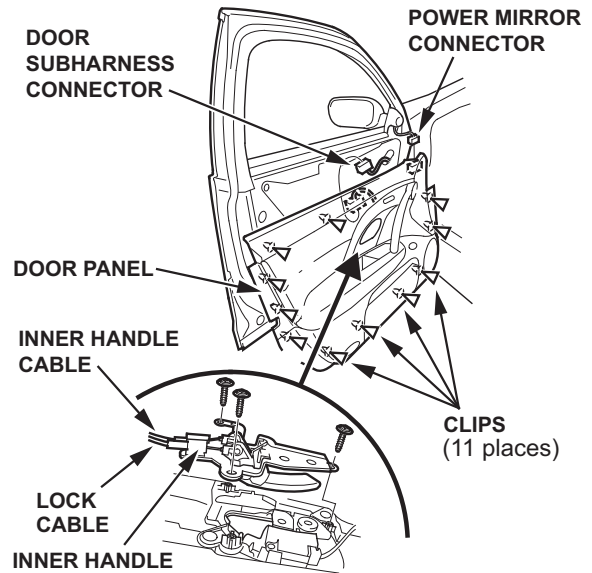

6. Remove the access cap, then push the glass run channel aside, as needed, to insert a Phillips screwdriver or a thin-wall 10 mm socket and extension onto the outer handle cover bolt.

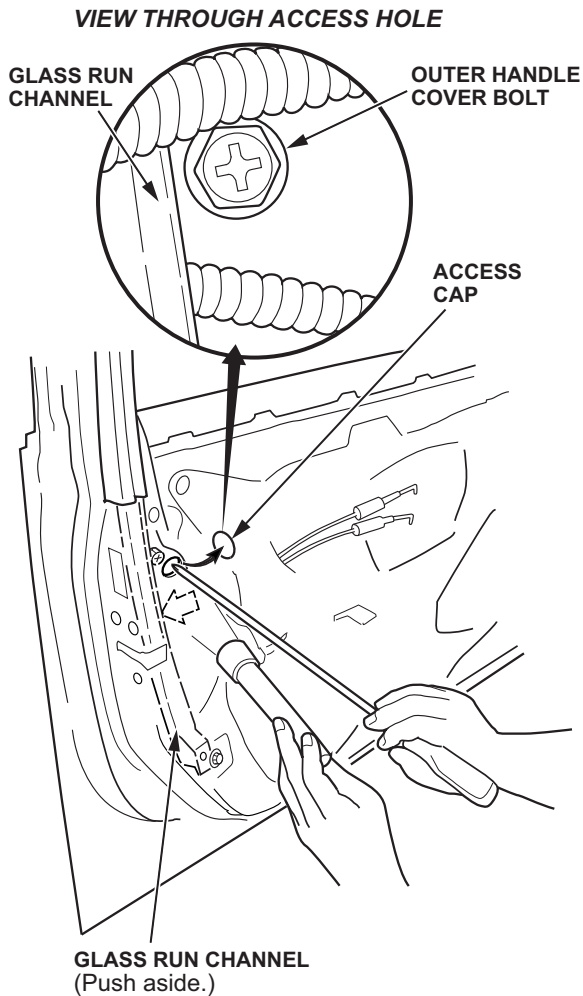

7. While holding the outer handle cover from the outside of the door, loosen the bolt. Pull back on the cover to release its hooks from the outer handle base.

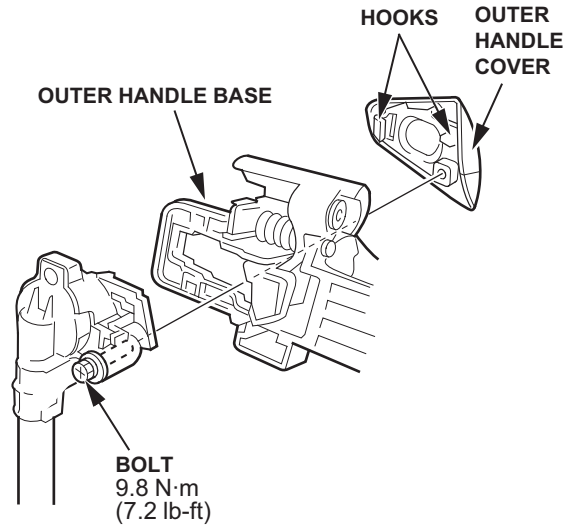

8. Install a new door outer handle cover in the reverse order of removal, and note these items:
 - Make sure the door handle works and aligns properly.
 - Make sure the door lock cylinder/door locks operate properly.
9. Install the door panel in the reverse order of removal, and note these items:
 - Make sure the plastic inner door cover is installed properly and sealed around its outside perimeter to keep out water.
 - Replace any damaged clips or cable fasteners with new ones.
 - Make sure the window and power door lock operate properly.

REPAIR PROCEDURE – REAR DOOR HANDLE

NOTE: Put on gloves to protect your hands.

- Use the appropriate tool from the KTC trim tool set to avoid damage when prying parts.
- Take care not to scratch or damage the door panel or other interior trim pieces.

1. Fully raise the rear door glass.
2. Using a trim tool, push on the bottom hook and pivot the cover on the upper hook, then detach the front hook, then remove the cover and the screws securing the inner handle.

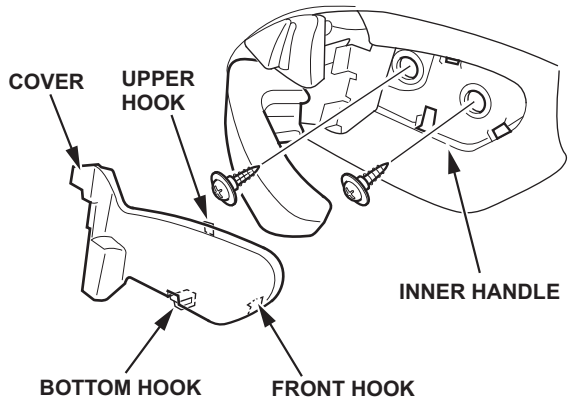

3. Remove the rubber mat, then remove the screw.

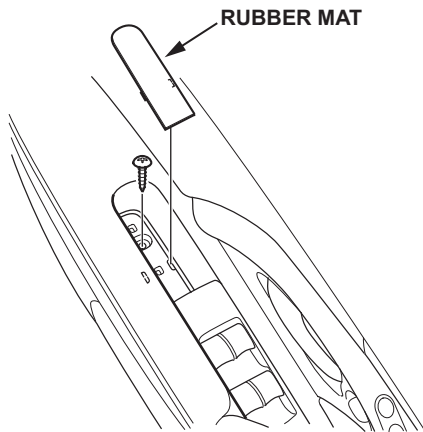

4. Release the clips that hold the door panel with a commercially available trim pad remover.

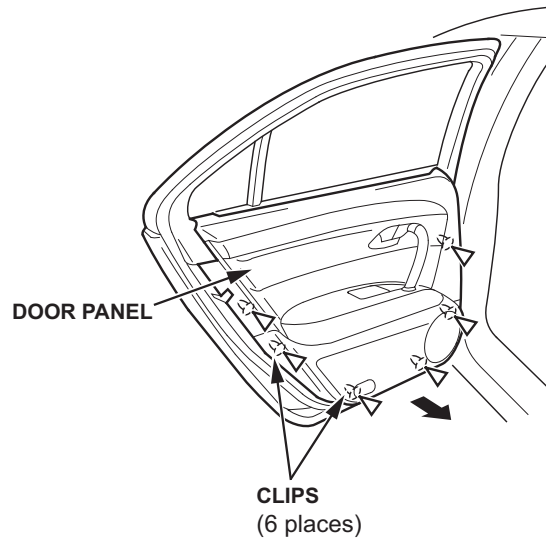

5. Remove the door panel with as little bending as possible to avoid creasing or breaking it.
 - While holding the door panel, pull the panel upward to release it from the upper clips.
 - While holding the door panel away from the door, disconnect the door subharness connector and the power window switch connector, remove the screws, then remove the inner handle from the door panel

NOTE: The inner handle cable and the lock cable are connected to the door panel. Do not pull the door panel up too far, or the inner handle cable will be damaged.

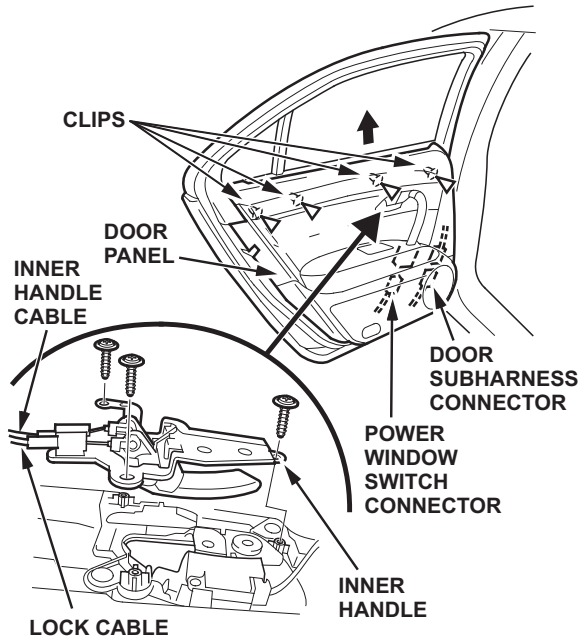

6. Using a clip remover, remove the remaining clips from the door. Using a knife, cut the bosses off the clips. Push each clip, then pull it away.

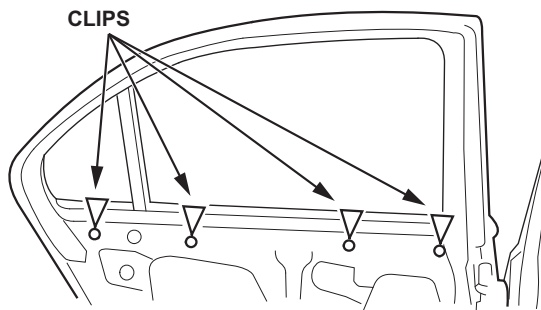

7. Peel back the upper left corner of the plastic inner door cover.

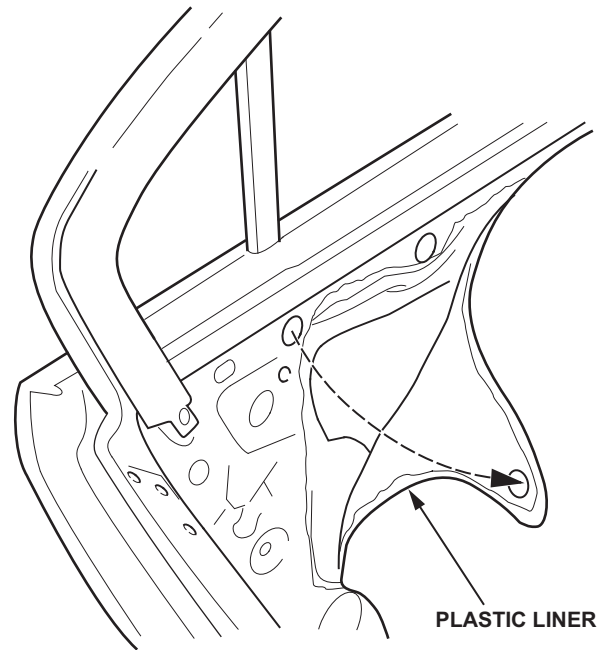

8. Disconnect the connector, and remove the screws, then lower the latch.

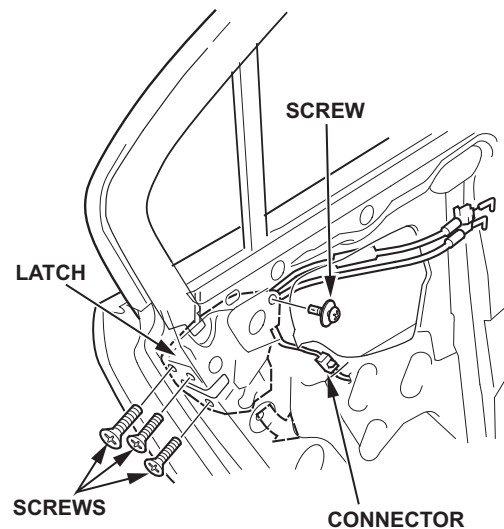

9. Remove the access cap, then push the glass run channel aside, as needed, to insert a Phillips screwdriver or a thin-wall 10 mm socket and extension onto the outer handle cover bolt.

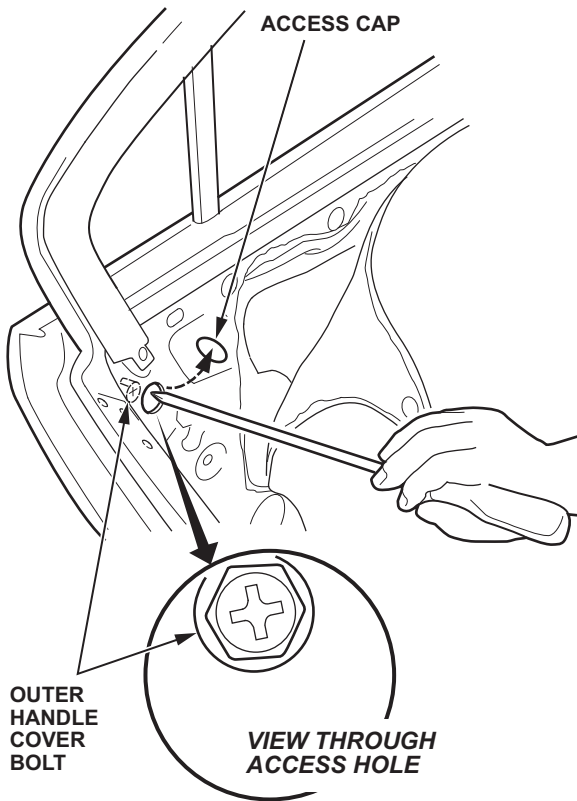

10. While holding the outer handle cover from the outside of the door, loosen the bolt. Pull back on the cover to release its hooks from the outer handle base.

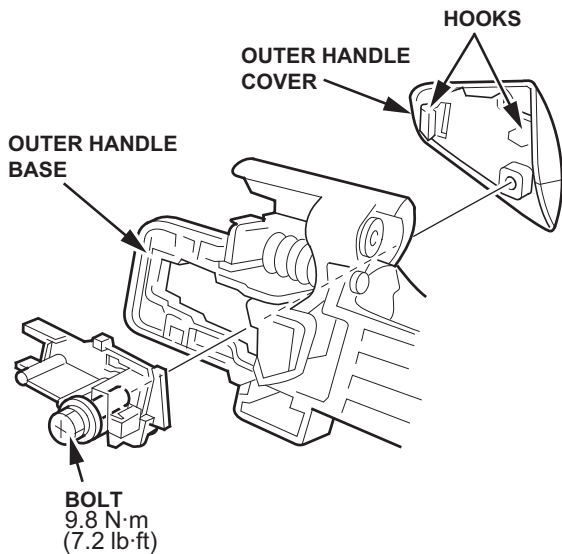

11. Install the rear door outer handle cover in the reverse order of removal, and note these items:
- Make sure the outer handle rod is connected securely.
 - Make sure the door handle and the lock work properly.
12. Install the rear door panel in the reverse order of removal, and note these items:
- Make sure the plastic inner door cover is installed properly and sealed around its outside perimeter to keep out water.
 - Before reinstalling the door panel, install the clips.
 - Replace any damaged clips or cable fasteners with new ones.
 - Make sure the window and the power door lock operate properly.