

Helping you fix it right the *first time - every time*

## Use Throttle Depressor Tool for A/C System Performance Test

**Currently Applies To:** All '94 and later models with R-134a A/C except SLX

If you're doing S/B 96-004, *Air Conditioning System Performance Test*, you've got to raise the engine speed and hold it steady for at least **10 minutes** with no one in the vehicle. Well, that's easier said than done, especially if you're working on a vehicle with an electronic throttle control system (ETCS). There's simply no way to raise the engine speed from under the hood.

That's where the throttle depressor tool comes in. This handy gadget connects between the steering wheel rim and the accelerator pedal. Coarse and fine adjustments on the tool allow for precise engine speed control. Here's what this tool looks like:

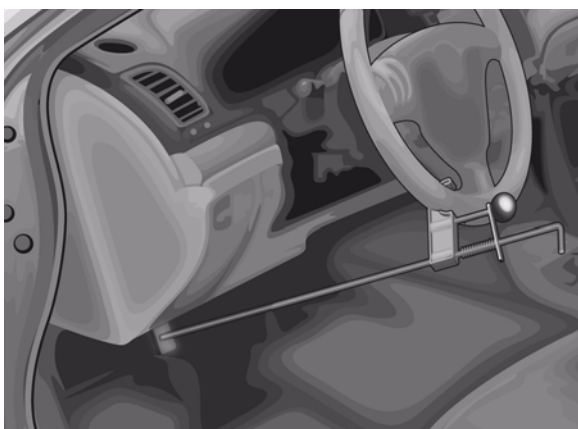

Since you're raising the engine speed, remember these important safety tips:

- Make sure that the parking brake is set and all four wheels are blocked.
- Make sure that the shift lever is in Park (A/T models) or in Neutral (M/T models).
- **Don't** exceed the engine speed that's listed in the applicable S/M or in ISIS.
- **Don't** stand in front of or behind the vehicle. (And don't let anyone else do it either.)
- **Don't** leave the vehicle unattended.

If you'd like to order this tool for your shop, give the Acura Tool and Equipment Program folks a call at **888-424-6857** and ask for Model No. B240B. You can also order it online; it's just a few clicks away on the *N*. From the main menu, click on **SERVICE**. You can then click on either **Service Bay** and **Tool and Equipment Program** or **eMail** and **Tool & Equipment Acura**. Either way takes you to the Tool and Equipment Program webpage. Once there, click on **Online Catalog**, enter the part number in the **Search** box, and click on **Go!**. You're taken straight to the order page.

## New Software for HDS: Version 2.014.008

During the week of May 12, 2008, each Acura dealership was sent a new CD containing HDS software version 2.014.008. This new CD wears a yellow label that reads **HDS VER 2.014.008**, and it's dated May 2008. Your system administrator should have this software already loaded onto the master server.

Here's some important info on 2.014.008:

- It supports the Vista operating system for the PC version of the HDS.
- It makes it easier to use TPMS diagnostics.
- It enhances Body Electrical system diagnostics.

## Treat the HDS Like a Computer to Help Avoid Lock-Ups

HDS lock-ups can rob you of valuable time and bog down your work. You can help avoid them, though, if you just treat the HDS like the computer that it really is. Here are some handy tips:

- **Never** disconnect the HDS from the 16P DLC while it's running applications or detach it from its docking station while it's updating software. Doing so can cause corrupted or lost data and at the very least, you'll have to do a reboot.
- Before you disconnect the HDS from the DLC, attach it to its docking station, or connect it to another DLC, make sure that you're at the switchboard screen.



- If you've got to leave the HDS connected to the DLC for a while without activity (for instance, you're taking a break or going to lunch), put the HDS in standby mode. This keeps it from locking up and saves you the hassle of having to reboot it. To put the HDS in standby mode, press the **red** button in the lower right corner. You'll see the **yellow** LED on the right side come on. When you're ready to go back to work, just press the **green** button above the red one, and the HDS will pick up right where you left off.

## Keyless Access Won't Unlock the Doors or Start the Engine

**Currently Applies To:** '05–08 RL

A bad front door outer handle can cause any of these keyless access system-related problems:

- The doors won't unlock when you reach behind the front door outer handle.
- The ignition knob won't turn when you go to start the engine, making it necessary to use the key in the remote.
- The No. 7 (10 A) fuse in the driver's under-dash fuse/relay box repeatedly blows ('05–06 models).
- The front door outer handle gets warm to the touch ('05–06 models).
- The indicator needles in the gauge control module won't go back to their minimum values when you turn the ignition switch to LOCK (0).
- One or more of these DTCs are set. Although you can clear them, they come right back when you cycle the ignition switch:
  - B1055 (relay control module lost communication with MICU [MICU message])
  - B1056 (relay control module lost communication with MICU [ALARM message])
  - B1061 (relay control module lost communication with gauge control module [A/T message])
  - B1063 (relay control module lost communication with combination switch control unit [WIPSW message])
  - B1605 (keyless access control unit lost communication with MICU [MICU message])
  - B1610 (keyless access control unit lost communication with gauge control module [VSP/NE message])
  - B1613 (keyless access control unit lost communication with driver's MPCS unit [DOORSW message])
  - B1614 (keyless access control unit lost communication with driver's MPCS unit [DRLOCKSW message])
  - B1615 (keyless access control unit lost communication with driver's MPCS unit [ASLOCKSW message])

To make things right, here's what you need to do:

1. Unplug the connectors from the front door outer handles (both driver's and passenger's), and replace the No. 7 fuse with a fresh one.
2. Plug in the connectors for each door handle one at a time until the No. 7 fuse blows. Note which handle blows the fuse, and replace that handle. Refer to pages 20-12 thru 20-14 of the '05–08 RL S/M. (Online, enter keywords **DOOR HANDLE** and select **Front Door Outer Handle Replacement** from the list.)
3. Replace the blown No. 7 fuse, and retest.

## Replacement Lens in Stock for Audio-HVAC Display Module Assy

**Currently Applies To:** '07–08 TL without navigation system

Got an audio-HVAC display module assembly with a lens that's scratched, nicked, cracked, or chipped? No need to replace the entire module assembly to fix this problem—just replace the lens. Acura parts stock now carries a replacement lens for this purpose. Here's what it looks like:



Each replacement lens comes with a set of easy-to-follow, illustrated instructions on how to install it.

Order P/N 04395-SEP-305ZA. Revised 6/19/08

## Whine, Whistle, or Howl Between 30 and 40 MPH

**Currently Applies To:** '05–08 RL

A bad propeller shaft center support bearing can cause an annoying whine, whistle, or howl if you're driving between **30 and 40 mph** and the bearing is cold.

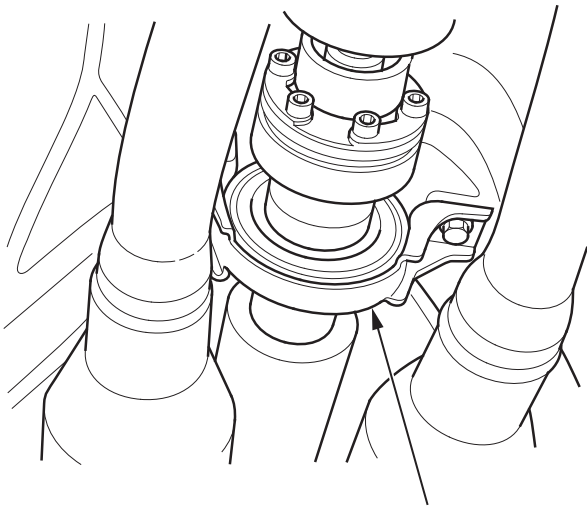

**CENTER SUPPORT BEARING**

To check for a bad center support bearing, here's what you need to do:

1. Raise the vehicle on a lift, and make sure that it's securely supported.
2. Have someone start the engine, shift into Drive, and slowly accelerate until the speedometer reads between **30 and 40 mph**.
3. While standing under the center support bearing, use a stethoscope to listen for noise coming from the bearing.
  - If you hear noise coming from the bearing, replace the propeller shaft. Refer to pages 16-42 thru 16-45 of the '05–08 RL S/M. (Online, enter keyword **PROPELLER** and select **Propeller Shaft Removal** and **Propeller Shaft Installation** from the list.)
  - If the bearing is quiet, continue with normal troubleshooting.

## M/T Intermittently Pops out of 1st Gear

**Currently Applies To:** '05–07 TL with M/T

Working on a vehicle that pops out of 1st gear from time to time? A problem with the back taper on the 1st gear dog teeth may be the reason why. We've since resolved this problem with a new replacement 1st gear (P/N 23421-PYZ-010). This should ensure that your client doesn't have a repeat problem.



**ACURA** *ServiceNews*

©2007 American Honda Motor Co., Inc. - All Rights Reserved. Published by AHM Parts and Service Communications, 1919 Torrance Blvd., Torrance, CA 90501-2746. All suggestions become the property of American Honda Motor Co., Inc.; sending a suggestion gives Honda permission to publish it without further consideration.

BSN 39423-39769 (0806)

