

**REMOVAL & INSTALLATION > FRONT BRAKE PAD REMOVAL AND INSTALLATION
(2016-19)**

Special Tools Required

Image	Description/Tool Number
	<p>Brake Caliper Piston Compressor 07AAE-SEPA101</p>
<p>Courtesy of HONDA, U.S.A., INC.</p>	

**REMOVAL & INSTALLATION > FRONT BRAKE PAD REMOVAL AND INSTALLATION
(2016-19) > REMOVAL**

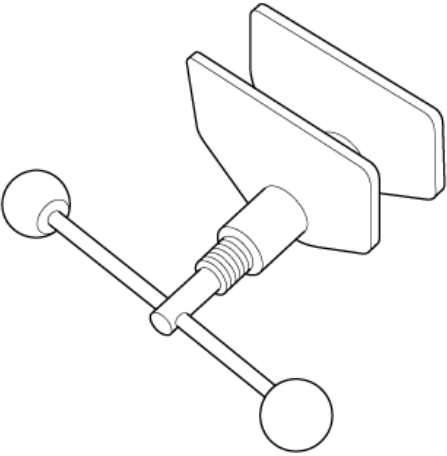

Courtesy of HONDA, U.S.A., INC.

Frequent inhalation of brake pad dust, regardless of material composition, could be hazardous to your health.

- Avoid breathing dust particles.
- Never use an air hose or brush to clean brake assemblies. Use an OSHA-approved vacuum cleaner.

1. Brake Fluid - Remove

1. Remove some brake fluid from the master cylinder reservoir.

2. Vehicle - Lift

3. Front Wheels - Remove

4. Brake Pad - Remove

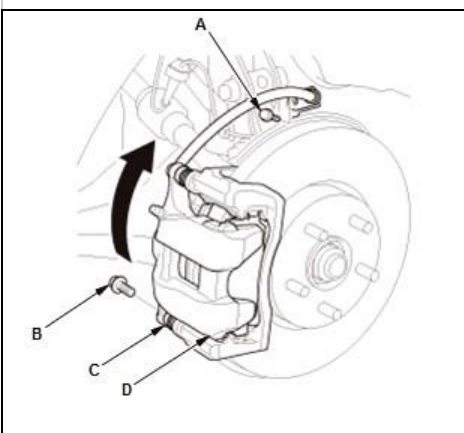

Courtesy of HONDA, U.S.A., INC.

1. Remove the brake hose mounting bolt (A).
2. Remove the flange bolt (B) while holding the caliper pin (C).
3. Pivot the caliper body (D) up out of the way.

NOTE:

1. Check the hose and the pin boots for damage and deterioration.
2. Be careful when pivoting the caliper body up or the spring could pop out of position.

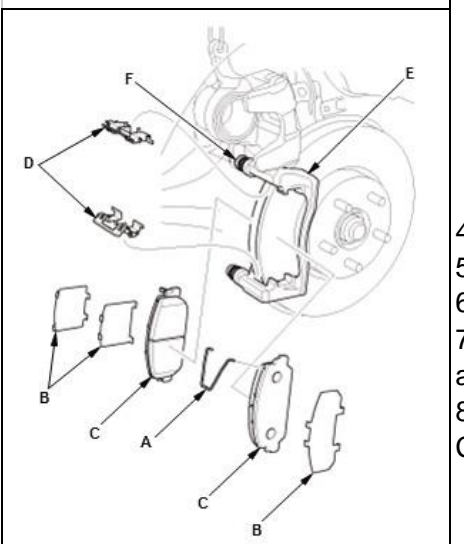

Courtesy of HONDA, U.S.A., INC.

4. Remove the pad return spring (A).
5. Remove the pad shims (B) and the brake pads (C).
6. Remove the upper and lower pad retainers (D).
7. Clean the caliper bracket (E) thoroughly; remove any rust, and check for grooves and cracks.
8. Verify that the caliper pins (F) move in and out smoothly. Clean and lube if needed.

5. Brake Disc - Inspect

REMOVAL & INSTALLATION > FRONT BRAKE PAD REMOVAL AND INSTALLATION (2016-19) > INSTALLATION



Courtesy of HONDA, U.S.A., INC.

Frequent inhalation of brake pad dust, regardless of material composition, could be hazardous to your health.

- Avoid breathing dust particles.
- Never use an air hose or brush to clean brake assemblies. Use an OSHA-approved vacuum cleaner.

1. Brake Pad - Install

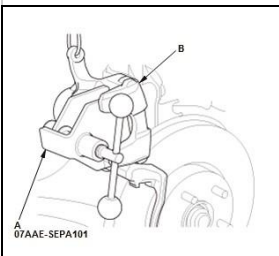

Courtesy of HONDA, U.S.A., INC.

1. Install the brake caliper piston compressor tool (A) on the caliper body (B).
2. Press in the piston with the brake caliper piston compressor tool.

NOTE: Be careful when pressing in the piston; brake fluid might overflow from the master cylinder's reservoir. If brake fluid gets on any painted surface, wash it off immediately with water.

3. Remove the brake caliper piston compressor tool.

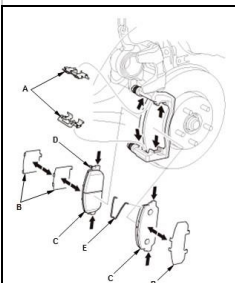

Courtesy of HONDA, U.S.A., INC.

4. Apply a thin coat of M-77 assembly paste (P/N 08798-9010) to the retainer mating surface of the caliper bracket (indicated by the arrows).

5. Install the upper and lower pad retainers (A).

6. Wipe off the excess assembly paste from the retainers. Keep the assembly paste away from the brake disc and the brake pads.

7. Apply a thin coat of M-77 assembly paste (P/N 08798-9010) to the pad side of the shims (B), the back of the brake pads (C), and the other areas indicated by the arrows.

8. Wipe off the excess assembly paste from the pad shims and brake pads friction material. Keep grease and assembly paste away from the brake disc and brake pads. Contaminated brake disc or brake pads reduce stopping ability.

9. Install the brake pads and pad shims correctly. Install the brake pad with the wear indicator (D) on the upper inside position.

NOTE : If you are reusing the brake pads, always reinstall the brake pads in their original positions to prevent a temporary loss of braking efficiency.

10. Install the pad return spring (E).

Fig 1: Disk Brake Caliper Mounting Bolt Torque Specifications

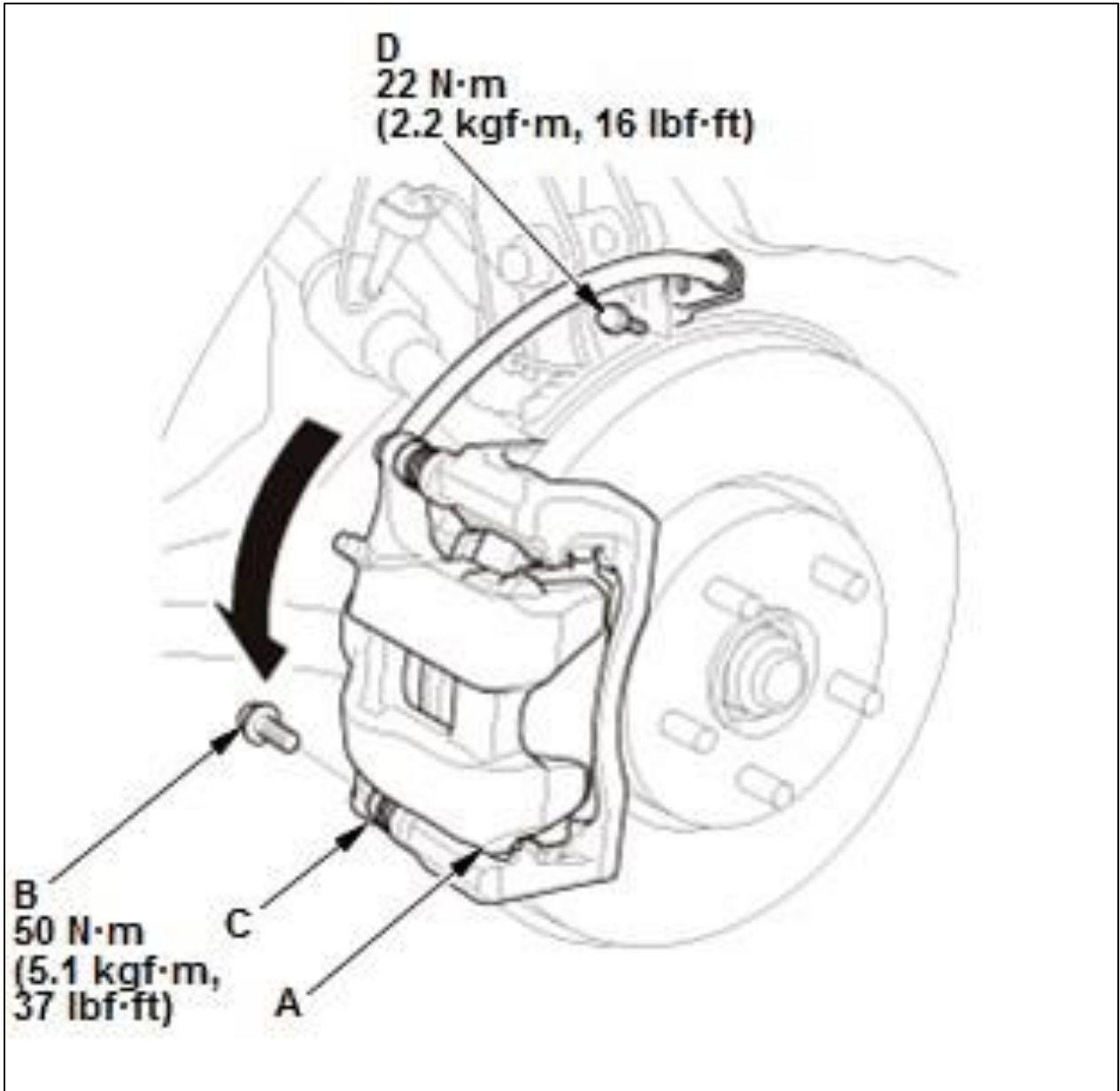

Courtesy of HONDA, U.S.A., INC.

11. Pivot the caliper body (A) down into position
12. Install the flange bolt (B), and tighten it to the specified torque while holding the caliper pin (C).
NOTE: Be careful not to damage the pin boot.
13. Install the brake hose mounting bolt (D).

2. Front Wheels - Install

3. Brake Fluid - Refill

1. Press the brake pedal several times to make sure the brakes work.
NOTE: Engagement may require a greater pedal stroke immediately after the brake pads have been replaced as a set. Several applications of the brake pedal will restore the normal pedal stroke.

2. Add brake fluid as needed.

||

|