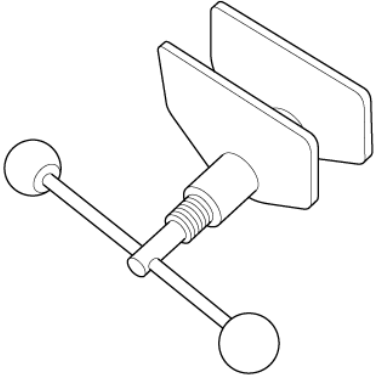

## Rear Brake Pad Removal and Installation

### Special Tool Required

Image	Description/Tool Number
	Brake Caliper Piston Compressor 07AAE-SEPA101

### Removal

#### **CAUTION**

Frequent inhalation of brake pad dust, regardless of material composition, could be hazardous to your health.

- Avoid breathing dust particles.
- Never use an air hose or brush to clean brake assemblies. Use an OSHA-approved vacuum cleaner.

#### 1. Brake Fluid - Remove

1. Remove some brake fluid from the master cylinder.

#### 2. Vehicle - Lift

1. [Raise and support the vehicle.](#)

#### 3. Rear Wheels - Remove

1. [Remove both rear wheels.](#)

#### 4. Brake Pad - Remove

1. Remove the flange bolts (A) while holding the caliper pins (B).

NOTE: Be careful not to damage the pin boots.

2. Remove the caliper body (C).

NOTE: Check the hose and the pin boots for damage and deterioration.

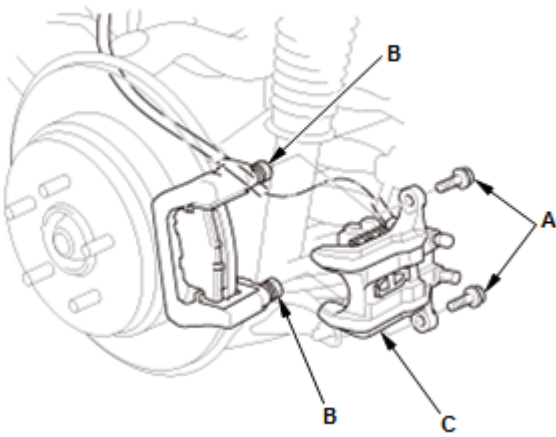

- 
3. Remove the outer pad shim (A) and the outer brake pad (B).

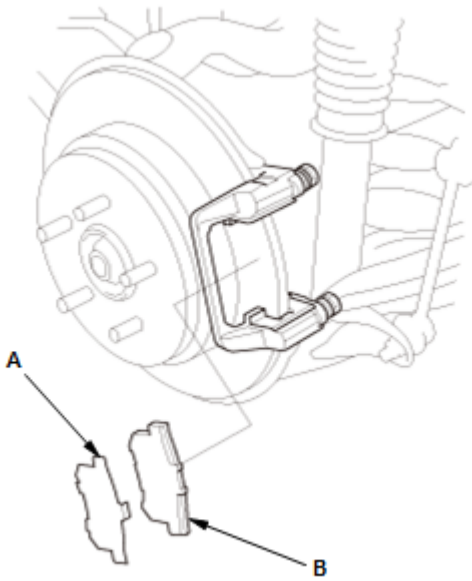

4. Remove the inner pad (A) from the caliper body.

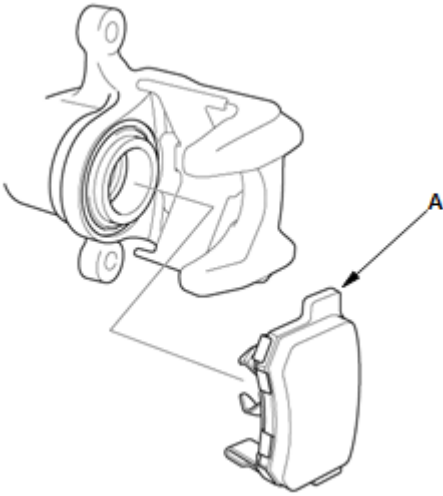

5. Remove the upper and lower pad retainers (A).

NOTE: The upper and lower pad retainers are different. During installation, make sure the pad retainers are in the proper positions.

6. Clean the caliper bracket (B) thoroughly; remove any rust, and check for grooves and cracks.
7. Verify that the caliper pins (C) move in and out smoothly. Clean and lube if needed.

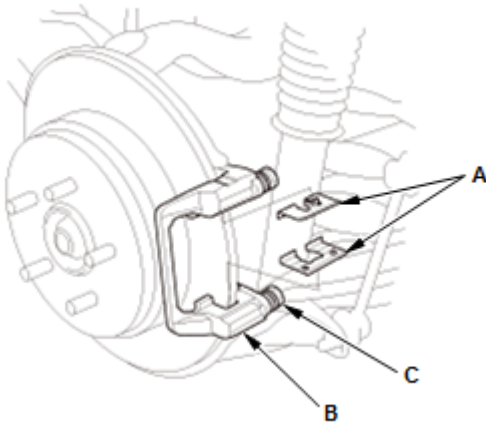

## 5. Brake Disc/Drum - Inspect

1. [Inspect the brake disc/drum for runout, thickness, and parallelism.](#)

## Installation

### CAUTION

Frequent inhalation of brake pad dust, regardless of material composition, could be hazardous to your health.

- Avoid breathing dust particles.
- Never use an air hose or brush to clean brake assemblies. Use an OSHA-approved vacuum cleaner.

## 1. Brake Pad - Install



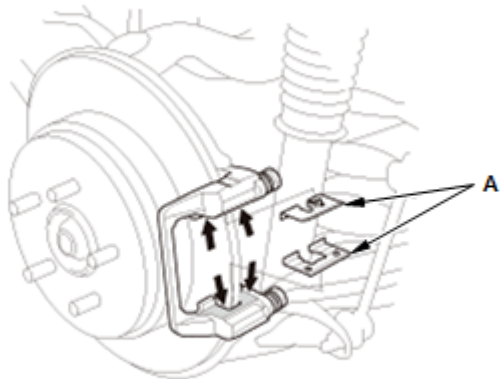

1. Apply a thin coat of M-77 assembly paste (P/N 08798-9010) to the retainer mating surface of the caliper bracket (indicated by the arrows).

2. Install the upper and lower pad retainers (A).

NOTE: The upper and lower pad retainers are different. Make sure the pad retainers are in the proper positions.

3. Wipe off the excess assembly paste from the retainers. Keep the assembly paste away from the brake disc/drum and the brake pads.

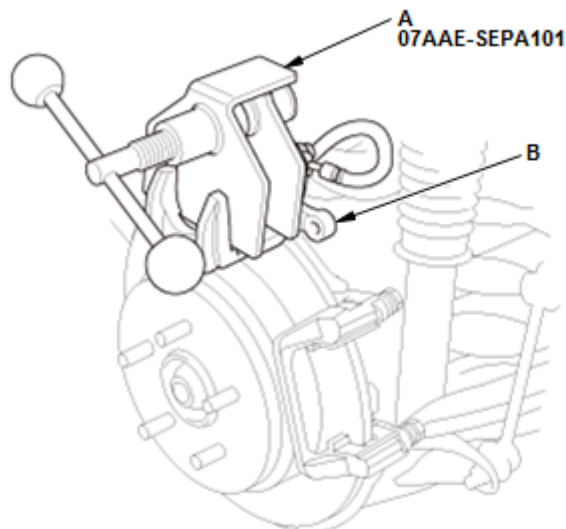

4. Install the brake caliper piston compressor tool (A) on the caliper body (B).

5. Press in the piston with the brake caliper piston compressor tool.

NOTE: Be careful when pressing in the piston; brake fluid might overflow from the master cylinder's reservoir. If brake fluid gets on any painted surface, wash it off immediately with water.

6. Remove the brake caliper piston compressor tool.

## Outer pad

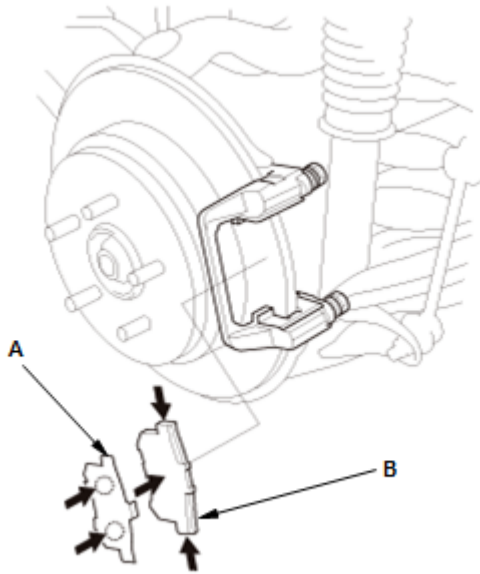

7. Apply a thin coat of M-77 assembly paste (P/N 08798-9010) to the pad side of the shim (A), the back of the brake pads (B), and the other areas indicated by the arrows.
8. Wipe off the excess assembly paste from the pad shim and brake pads friction material. Keep grease and assembly paste away from the brake disc/drum and brake pads. Contaminated brake disc/drum or brake pads reduce stopping ability.
9. Install the brake pads and pad shim correctly. Install the brake pad with the wear indicator (C) on the bottom inside position.

NOTE: If you are reusing the brake pads, always reinstall the brake pads in their original positions to prevent a temporary loss of braking efficiency.

## Inner pad

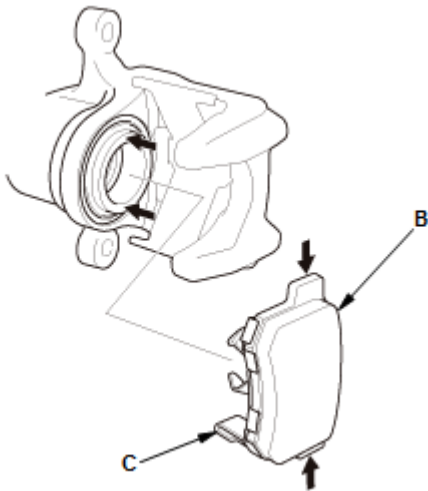



10. Install the caliper body (A).

11. Install the flange bolts (B), and tighten it to the specified torque while holding the caliper pins (C).

NOTE: Be careful not to damage the pin boot.

12. Press the brake pedal several times to make sure the brakes work.

NOTE: Engagement may require a greater pedal stroke immediately after the brake pads have been replaced as a set. Several applications of the brake pedal will restore the normal pedal stroke.

## 2. Rear Wheels - Install

1. [Install both rear wheels.](#)

## 3. Brake Fluid - Refill

1. Add brake fluid as needed.