



Applies To: **2013 RDX 2WD** – From VIN 5J8TB3H..DL000001 thru 5J8TB3H..DL016429
2013 RDX 4WD – From VIN 5J8TB4H..DL000001 thru 5J8TB4H..DL020459

April 13, 2013

2013 RDX: Front Brakes Squeal

SYMPTOM

The front brakes may squeal at low speeds under light brake application.

POSSIBLE CAUSE

Glazing on the front brake pads and/or rotors may cause the front brakes to squeal.

CORRECTIVE ACTION

Replace the front brake pads and install new pad return springs.

PARTS INFORMATION

NOTE: To help clarify where new parts are used in the REPAIR PROCEDURE, the new part is listed in the applicable step with a ">" symbol.

Front Pad Set:

P/N 45022-TX4-A01

(Set includes front pads, shims, and pad return springs)

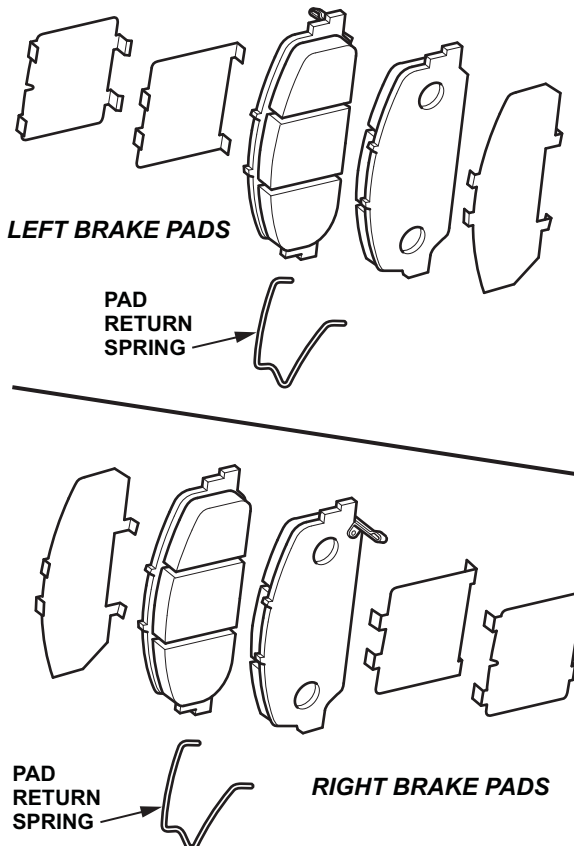

TOOL INFORMATION

Brake Caliper Piston Compressor Tool (or equivalent)
P/N 07AAE-SEPA101

WARRANTY CLAIM INFORMATION

The normal warranty applies.

OP#	Description	FRT
4101D5	Replace brake pads, install new pad return springs, measure and inspect for glaze on rotors and test-drive.	0.7 hr
A	Resurface rotors.	0.5 hr

Failed Part: 45022-TX4-A00

Defect Code: 01401

Symptom Code: 04201

Skill Level: Repair Technician

REPAIR PROCEDURE

1. Remove some brake fluid from the master cylinder.
2. Raise and support the vehicle and remove both front wheels.
3. Move the brake caliper out of the way to access the brake pads.
 - Remove the brake hose mounting bolt.
 - Remove the flange bolt, while holding the caliper pin with a wrench. Be careful not to damage the pin boot.
 - Pivot the caliper body up, out of the way.

NOTE: Check the hose and the pin boots for damage and deterioration.

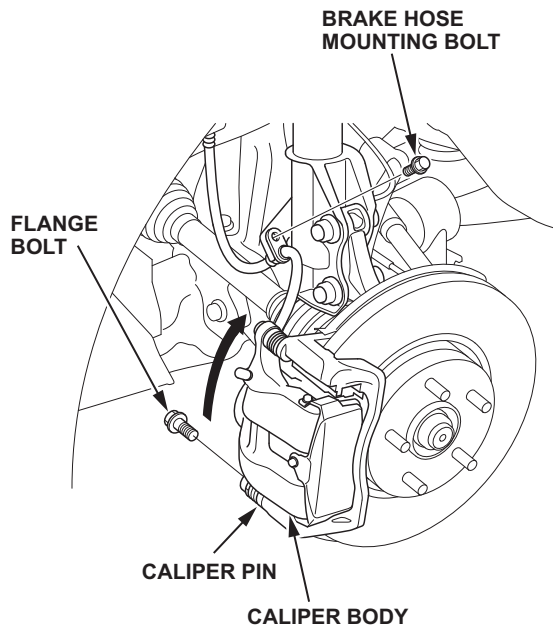

4. Remove the pad shims and the brake pads.

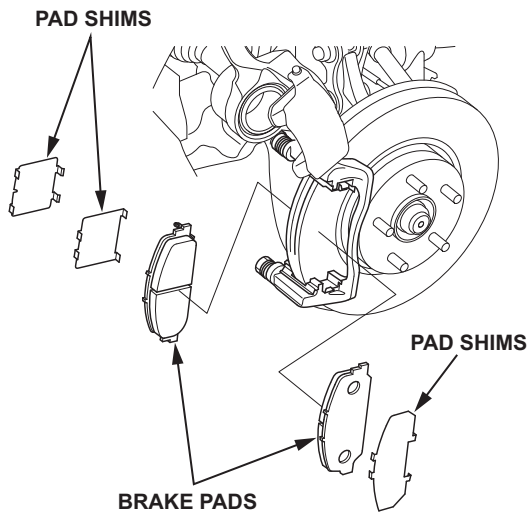

5. Remove the pad retainers.

- Clean the caliper bracket thoroughly; remove any rust, and check for grooves and cracks.
- Verify that the caliper pins move in and out smoothly. Clean and lube if needed.

PAD RETAINERS

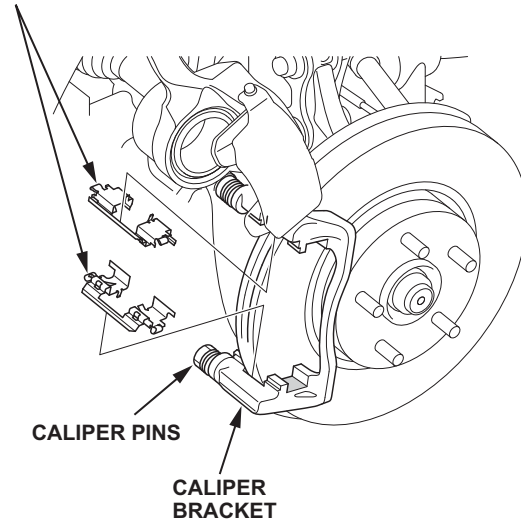

6. Inspect the rotor for:

- Glazing
- Parallelism: **0.015 mm (0.00059 in)** max.
- Runout: **0.04 mm (0.0016 in)** service limit.
- Thickness: **23.00 mm (0.906 in)** max refinishing limit.
 - If the rotor shows any glazing or if it measures over the above listed specifications, resurface it using a brake lathe, then go to step 7.
 - If the rotor does not have any glazing and is within specs, it is OK. Go to step 7.

7. Apply a thin coat of M-77 assembly paste (P/N 08798-9010) to the retainer mating surface of the caliper bracket.

- Install the pad retainers and wipe off the excess assembly paste from the retainers.
- Make sure to keep the assembly paste away from the rotor and the brake pads.

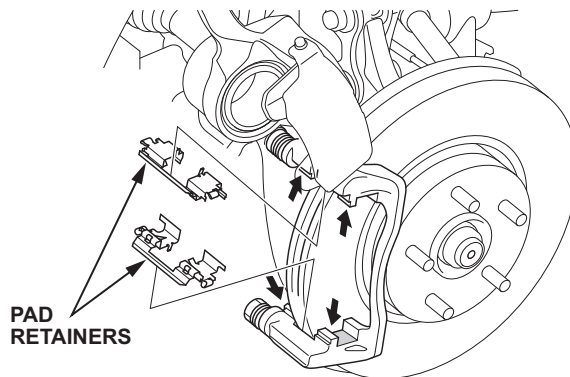

8. Reset the brake caliper piston.

- Install the brake caliper piston compressor tool on the caliper body.

NOTE: Be careful when pressing the piston; brake fluid might overflow from the brake fluid reservoir. If brake fluid gets on any painted surface, wash it off immediately with water.

- Make sure the piston boot is in position to prevent damaging it when pivoting the caliper body down.
- Remove the brake caliper piston compressor tool.

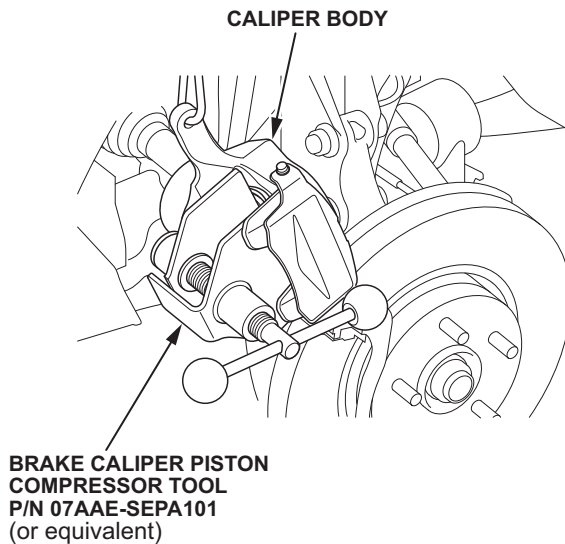

9. Apply a thin coat of M-77 assembly paste (P/N 08798-9010) to the pad side of the shims, the back of the brake pads and the other areas indicated by the arrows.

NOTE: Contaminated rotors or brake pads reduce stopping ability.

- Make sure and wipe off the excess assembly paste from the pad shims and the brake pads.
- Keep grease and assembly paste away from the rotor and the brake pad friction material.
- Install the brake pad with the wear indicator on the upper inside portion.

> Brake Pads

> Shims

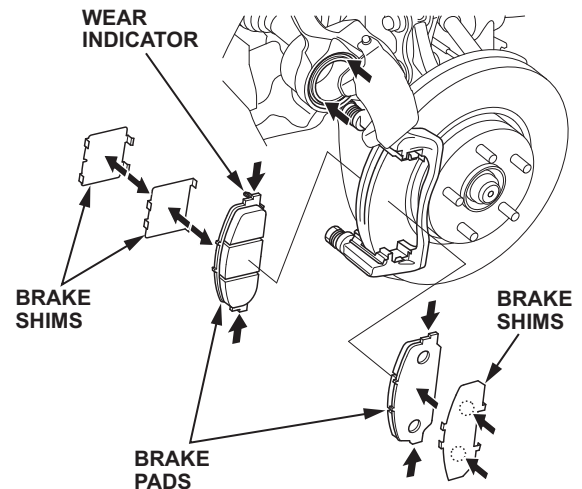

10. Install the pad return spring while holding the brake pads. Insert the pad return spring ends securely into the pad installation holes, located on the top side of the caliper body.

NOTE: The pad return spring helps prevent the pads or rotor from glazing.

> Pad Return Spring

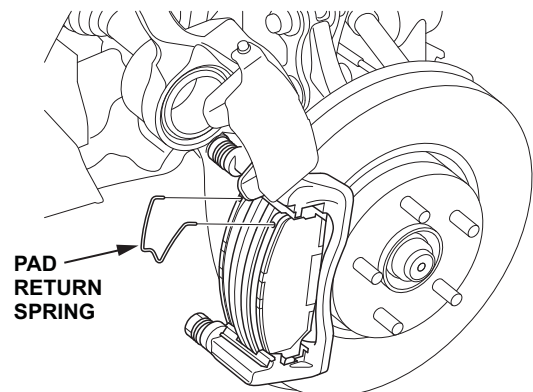

11. Reinstall the brake caliper.

- Pivot the caliper body down into position.
- Install the flange bolt and torque it to **50 N•m (37 lb-ft)**.
- Hold the caliper pin with a wrench, being careful not to damage the pin boot.
- Install the brake hose mounting bolt, and torque it to **22 N•m (16 lb-ft)**.

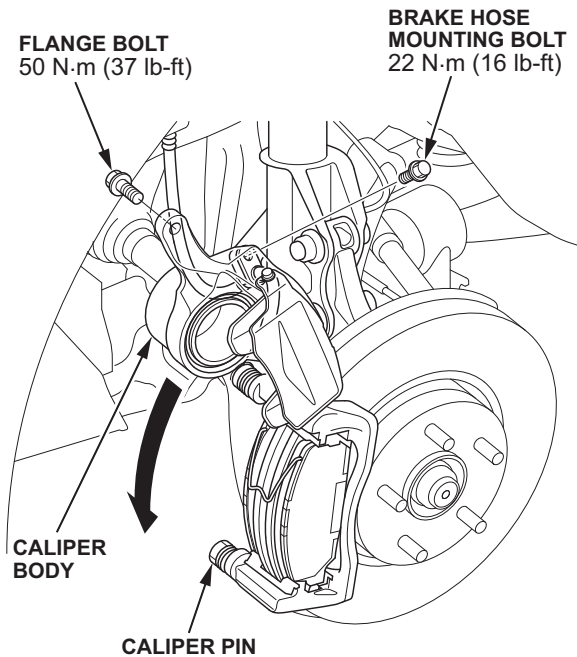

12. Repeat steps 3 through 11 on the other side.

13. Press the brake pedal several times to make sure the brakes work.

NOTE: The brakes may require a greater pedal stroke for engagement immediately after the brake pads have been replaced as a set. Several applications of the brake pedal will restore the normal pedal stroke.

14. Install both front wheels.

NOTE: Before installing each wheel, clean the mating surfaces between the rotor and the inside of the wheel. Confirm the wheel does not contact the caliper cover.

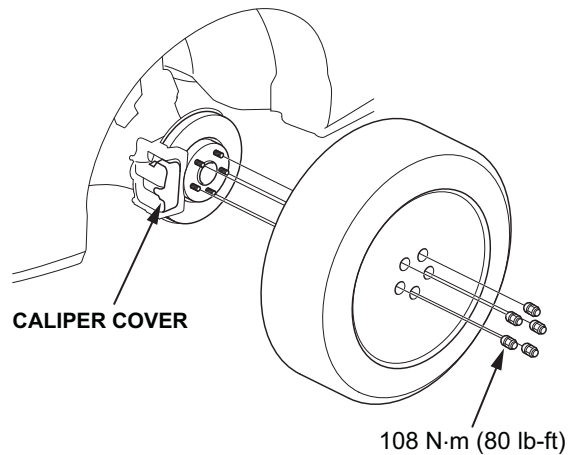

15. Make sure to add brake fluid as needed.

16. Test-drive to confirm that the brake squeal is gone.