

REMOVAL & INSTALLATION > ALTERNATOR REMOVAL AND INSTALLATION (2016-18) > REMOVAL

1. Battery Terminal - Disconnect
2. Drive Belt - Remove
3. Drive Belt Auto-Tensioner - Remove
4. A/C Condenser Fan Shroud and Radiator Fan Shroud - Remove
5. Connector (Alternator and A/C Compressor) and Positive Alternator Cable - Disconnect

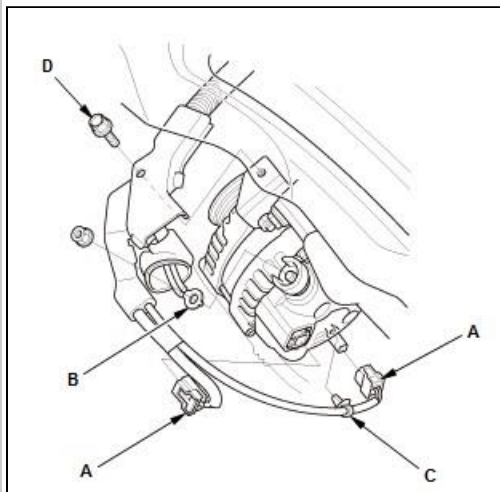

Courtesy of HONDA, U.S.A., INC.

1. Disconnect the connectors (A) and the positive alternator cable (B)
2. Remove the harness clamp (C) and the bolt (D) securing the harness holder.

6. Alternator - Remove

1. Remove the mounting bolts (A) and the alternator bracket (B).

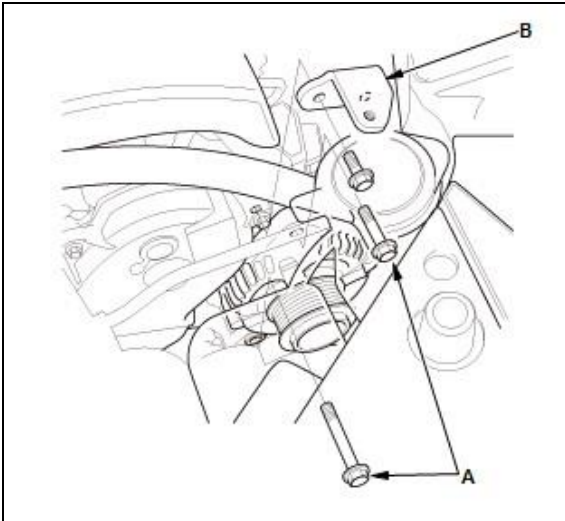

Courtesy of HONDA, U.S.A., INC.

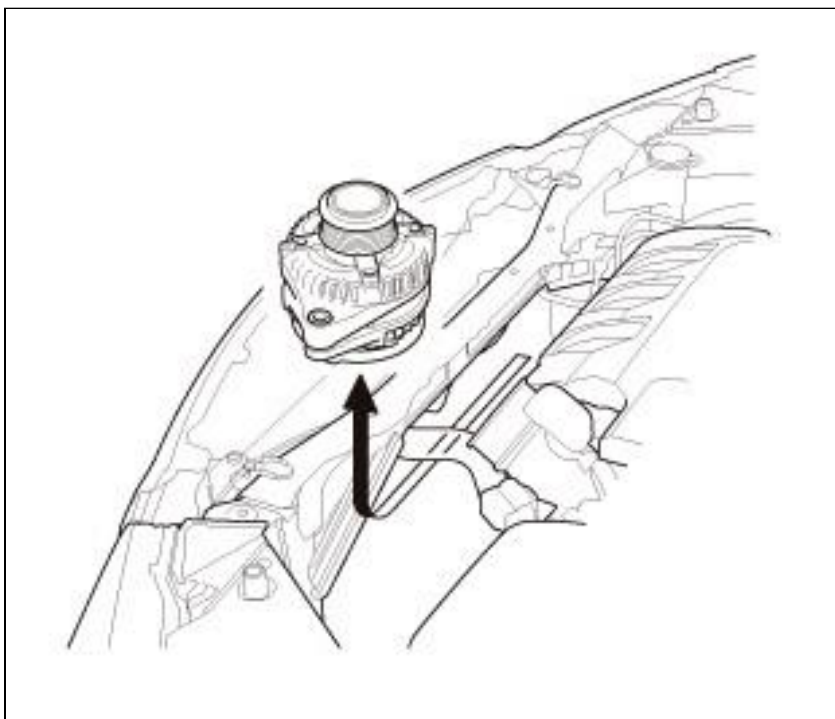

2. Remove the alternator.

Courtesy of HONDA, U.S.A., INC.

REMOVAL & INSTALLATION > ALTERNATOR REMOVAL AND INSTALLATION (2016-

18) > INSTALLATION

1. Alternator - Install

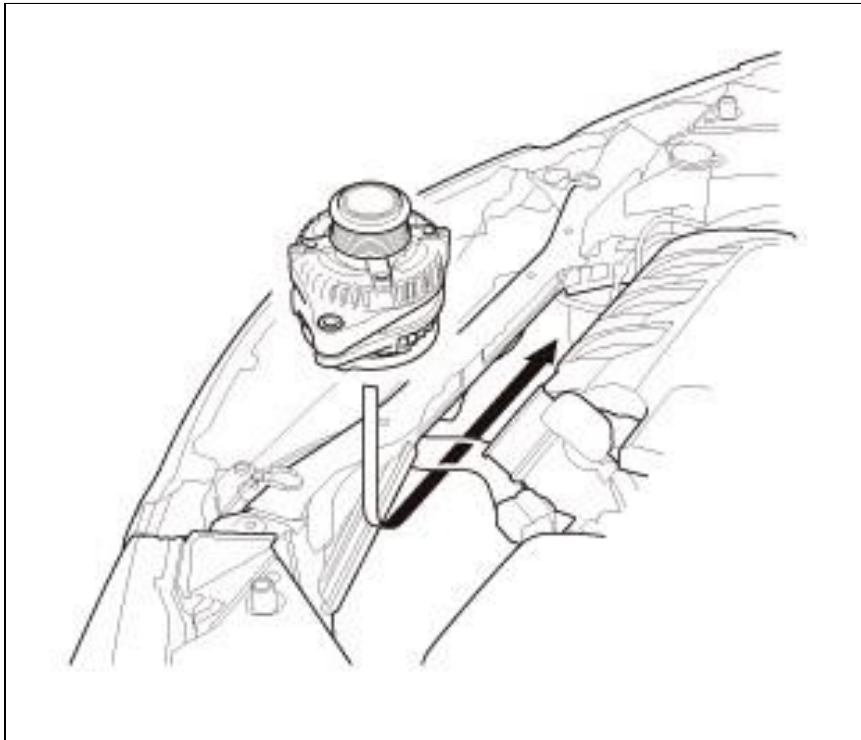

Courtesy of HONDA, U.S.A., INC.

1. Install the alternator.

Fig 1: Alternator Bolts With Torque Specifications

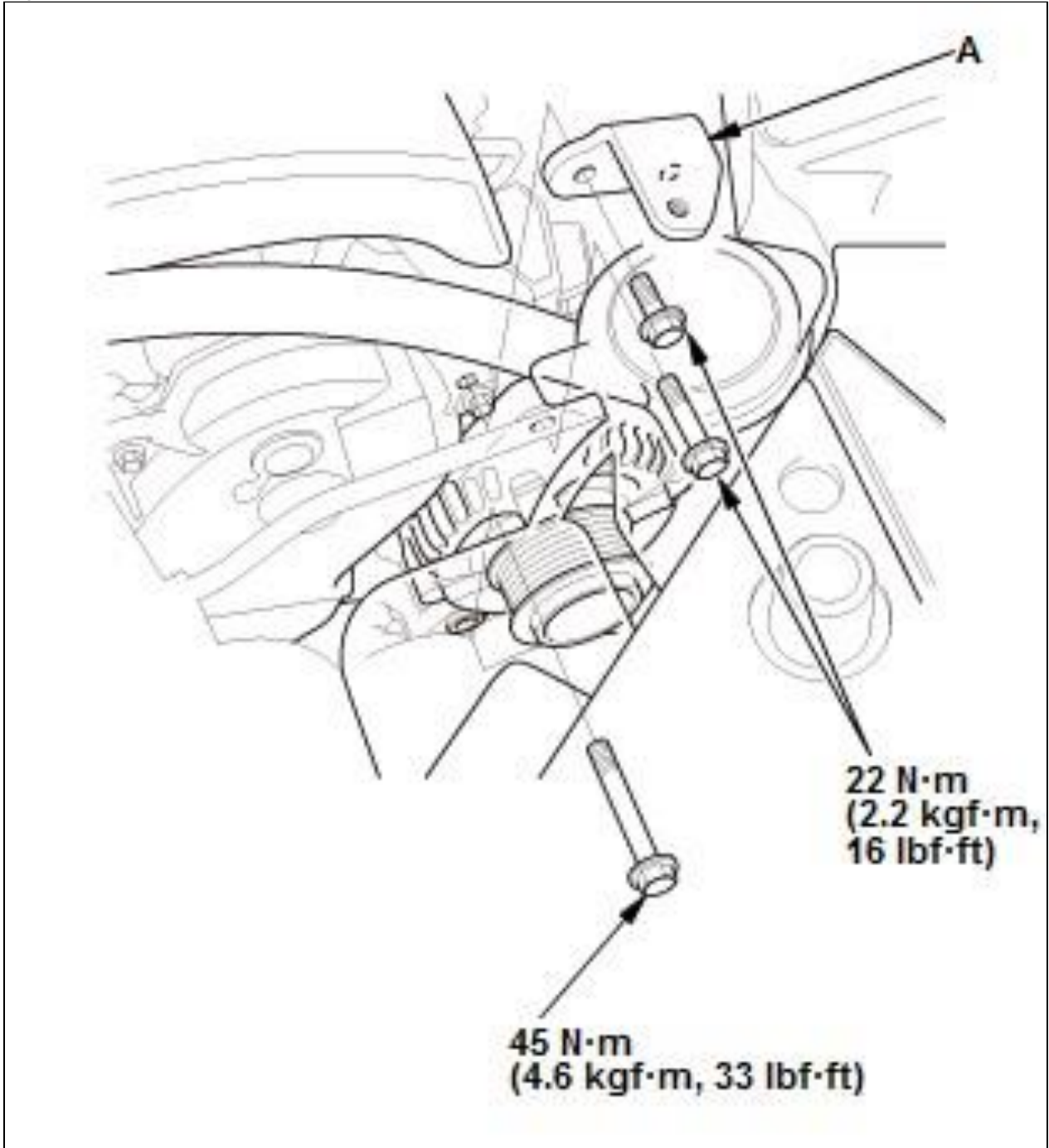

Courtesy of HONDA, U.S.A., INC.

2. Loosely install the alternator bracket (A)
 3. Tighten the alternator mounting bolts and the bracket mounting bolt.
2. Connector (Alternator and A/C Compressor) and Positive Alternator Cable - Connect

1. Install the bolt (A) securing the harness holder
2. Connect the connectors (B) and the positive alternator cable (C).
Make sure the crimped side of the ring terminal faces away from the alternator when you connect it
3. Install the harness clamp (D).

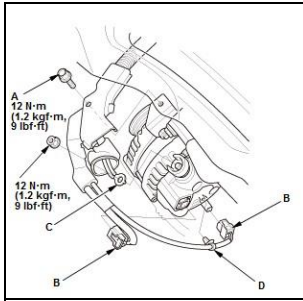

Courtesy of HONDA, U.S.A.,
INC.

3. A/C Condenser Fan Shroud and Radiator Fan Shroud - Install
4. Drive Belt Auto-Tensioner - Install
5. Drive Belt - Install
6. Battery Terminal - Connect