

Valve Clearance Adjustment (2013-15)

Adjustment

NOTE: Connect the HDS to the DLC, and monitor ECT SENSOR 1. Adjust the valve clearance only when the engine coolant temperature is less than 100 °F (38 °C).

1. Cylinder Head Cover - Remove

1. Remove the cylinder head covers .

2. Valve Clearance - Adjustment

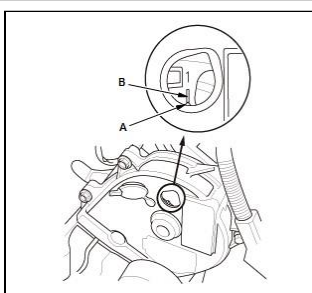

1. Set the No. 1 piston at top dead center (TDC). Align the pointer (A) on the front upper cover with the No. 1 piston TDC mark (B) on the front camshaft pulley.

Courtesy of HONDA, U.S.A., INC.

REAR

2. Select the correct feeler gauge for the valve clearance you are going to check.

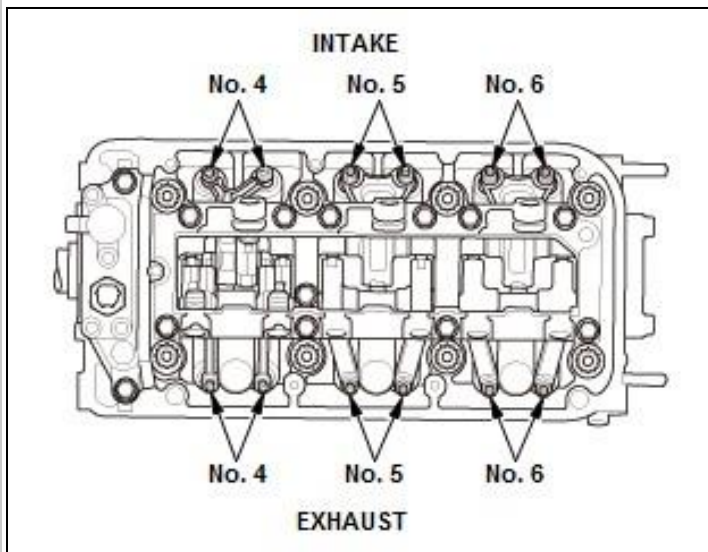
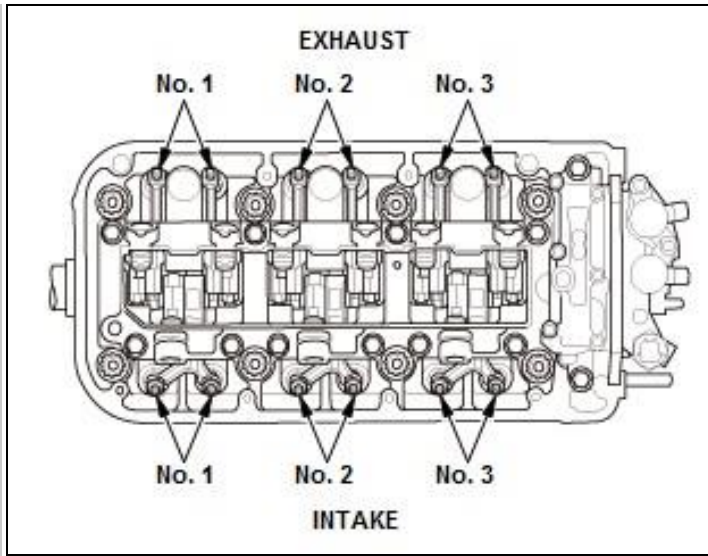

Courtesy of HONDA, U.S.A., INC. HONDA, U.S.A., INC.

FRONT

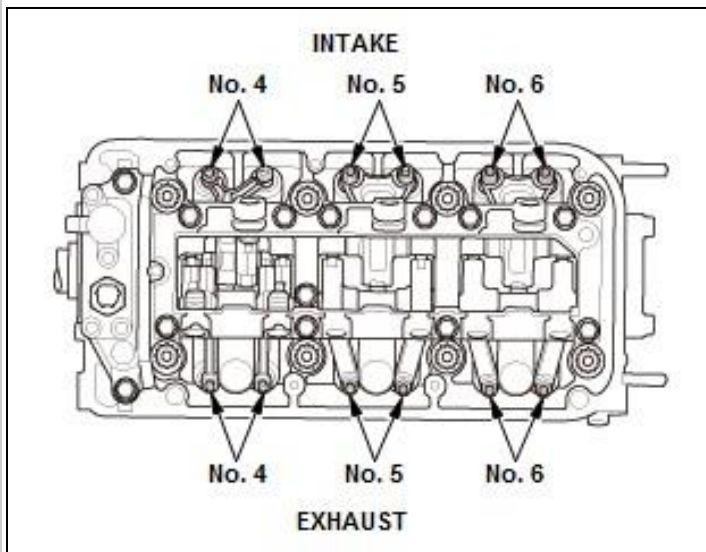
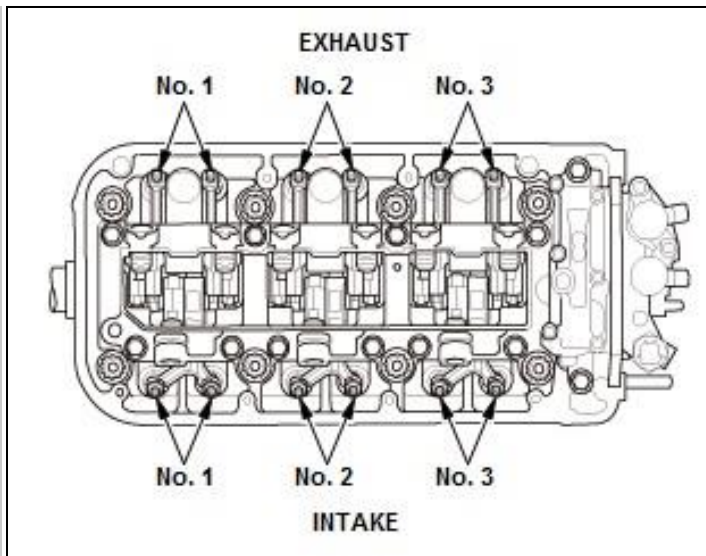

Courtesy of HONDA, U.S.A., INC. HONDA, U.S.A., INC.

Valve Clearance

Intake:	0.20-0.24 mm (0.008-0.009 in)
----------------	-------------------------------

Exhaust:	0.28-0.32 mm (0.011-0.012 in)
-----------------	-------------------------------

INTAKE

3. Insert the feeler gauge (A) between the adjusting screw and the end of the valve stem on the No. 1 cylinder, and slide it back and forth; you should feel a slight amount of drag.

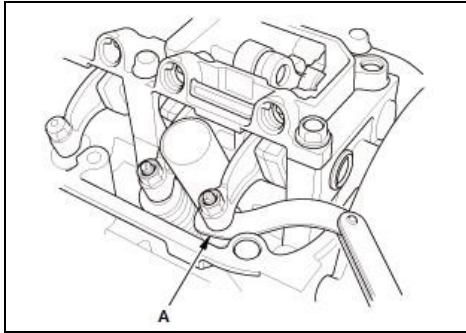
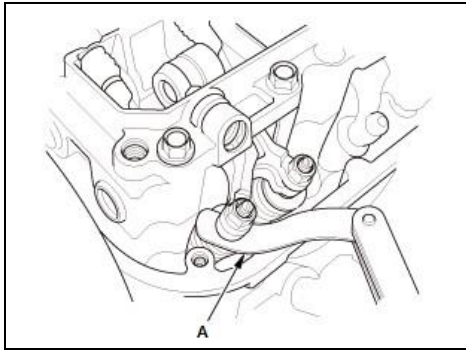

Courtesy of HONDA, U.S.A., INC.HONDA, U.S.A.,
INC.

EXHAUST

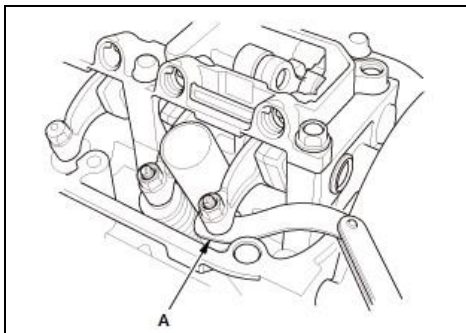
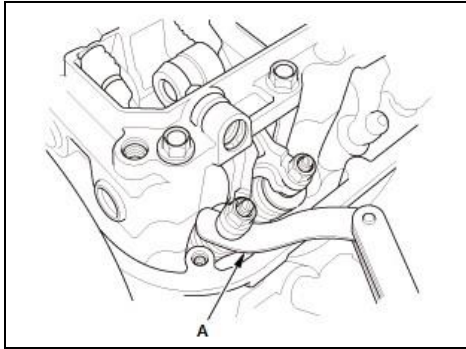

Courtesy of HONDA, U.S.A., INC.HONDA, U.S.A.,
INC.

INTAKE

4. If you feel too much or too little drag, loosen the locknut, and turn the adjusting screw until the drag on the feeler gauge is correct

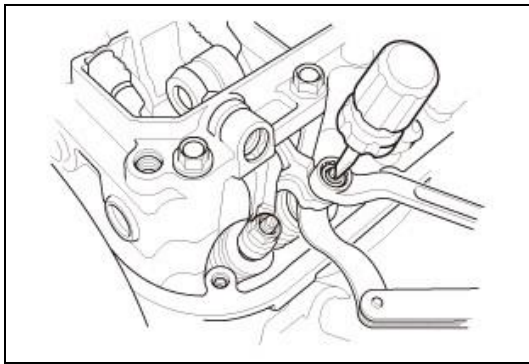

5. While holding the adjusting screw with the screw driver, tighten the locknut, then recheck the clearance. Repeat the adjustment, if necessary.

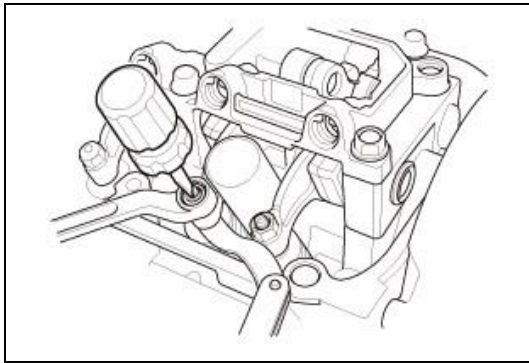

Courtesy of HONDA, U.S.A., INC. HONDA, U.S.A., INC.

EXHAUST

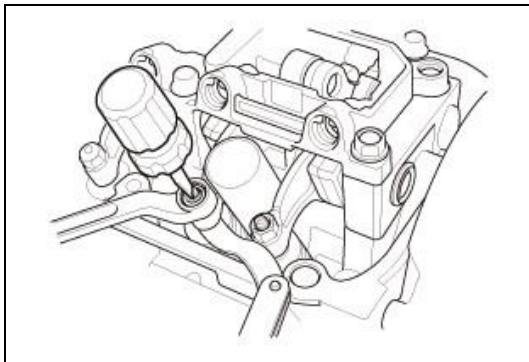
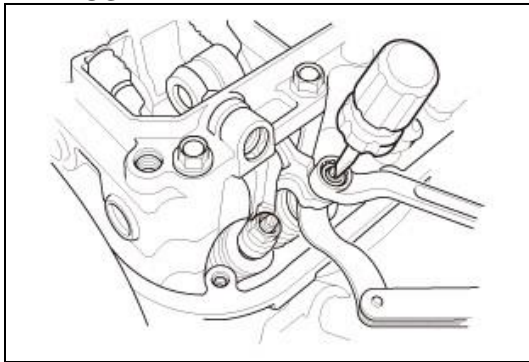

Courtesy of HONDA, U.S.A., INC. HONDA, U.S.A., INC.

Specified Torque

No. 1, No. 2, No. 3, and No. 4 cylinders:

20 N.m (2.0 kgf.m, 15 lbf.ft)

Apply new engine oil to the nut threads.

No. 5 and No. 6 cylinders:

14 N.m (1.4 kgf.m, 10 lbf.ft)

Apply new engine oil to the nut threads.

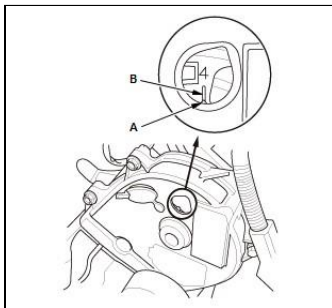

6. Rotate the crankshaft clockwise. Align the pointer (A) on the front upper cover with the No. 4 piston TDC mark (B) on the front camshaft pulley
7. Check and, if necessary, adjust the valve clearance on the No. 4 cylinder.

Courtesy of HONDA, U.S.A., INC.

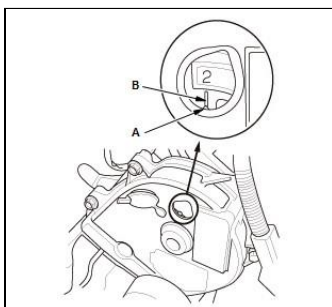

8. Rotate the crankshaft clockwise. Align the pointer (A) on the front upper cover with the No. 2 piston TDC mark (B) on the front camshaft pulley
9. Check and, if necessary, adjust the valve clearance on the No. 2 cylinder.

Courtesy of HONDA, U.S.A., INC.

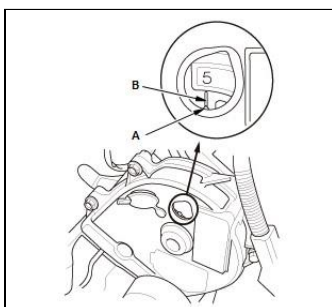

10. Rotate the crankshaft clockwise. Align the pointer (A) on the front upper cover with the No. 5 piston TDC mark (B) on the front camshaft pulley
11. Check and, if necessary, adjust the valve clearance on the No. 5 cylinder.

Courtesy of HONDA, U.S.A., INC.

12. Rotate the crankshaft clockwise. Align the pointer (A) on the front upper cover with the No. 3 piston TDC mark (B) on the front camshaft pulley
13. Check and, if necessary, adjust the valve clearance on the No. 3 cylinder.

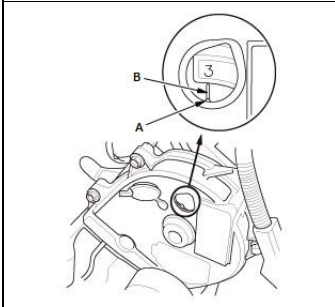

Courtesy of HONDA, U.S.A., INC.

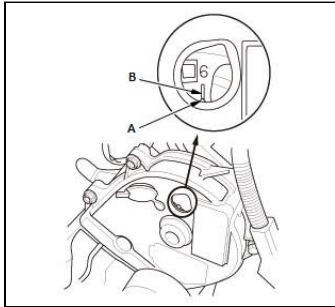

Courtesy of HONDA, U.S.A., INC.

14. Rotate the crankshaft clockwise. Align the pointer (A) on the front upper cover with the No. 6 piston TDC mark (B) on the front camshaft pulley
15. Check and, if necessary, adjust the valve clearance on the No. 6 cylinder.

3. Cylinder Head Cover - Install

1. Install the cylinder head covers .