

# REMOVAL & INSTALLATION > ALTERNATOR REMOVAL AND INSTALLATION (2013-15) > REMOVAL

## 1. Battery - Remove

1. Do the battery removal procedure .

## 2. Drive Belt - Remove

1. Remove the drive belt .

## 3. A/C Condenser Fan Shroud and Radiator Fan Shroud - Remove

1. Remove the A/C condenser fan shroud and the radiator fan shroud .

## 4. Alternator Connector and Positive Alternator Cable - Disconnect

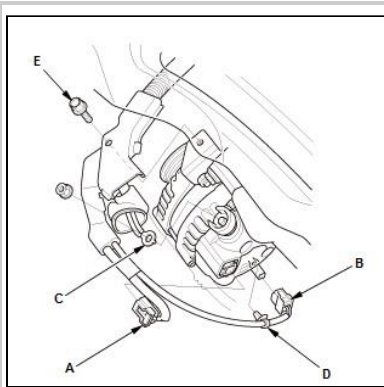

1. Disconnect the alternator connector (A), the A/C compressor clutch connector (B), and the positive alternator cable (C)
2. Remove the harness clamp (D) and the bolt (E) securing the harness holder.

Courtesy of HONDA, U.S.A., INC.

## 5. Alternator - Remove

1. Remove the mounting bolts (A) and the alternator bracket (B).

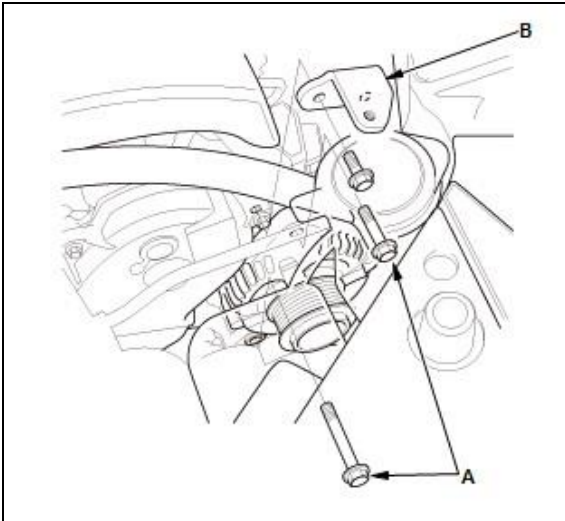

Courtesy of HONDA, U.S.A., INC.

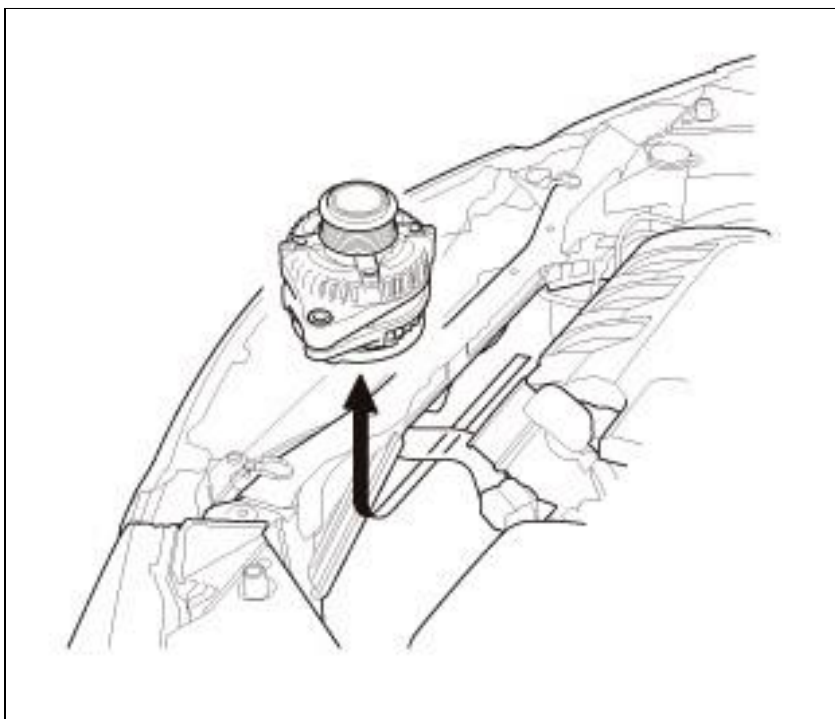

2. Remove the alternator.

Courtesy of HONDA, U.S.A., INC.

**REMOVAL & INSTALLATION > ALTERNATOR REMOVAL AND INSTALLATION  
(2013-**

## 15) > INSTALLATION

### 1. Alternator - Install

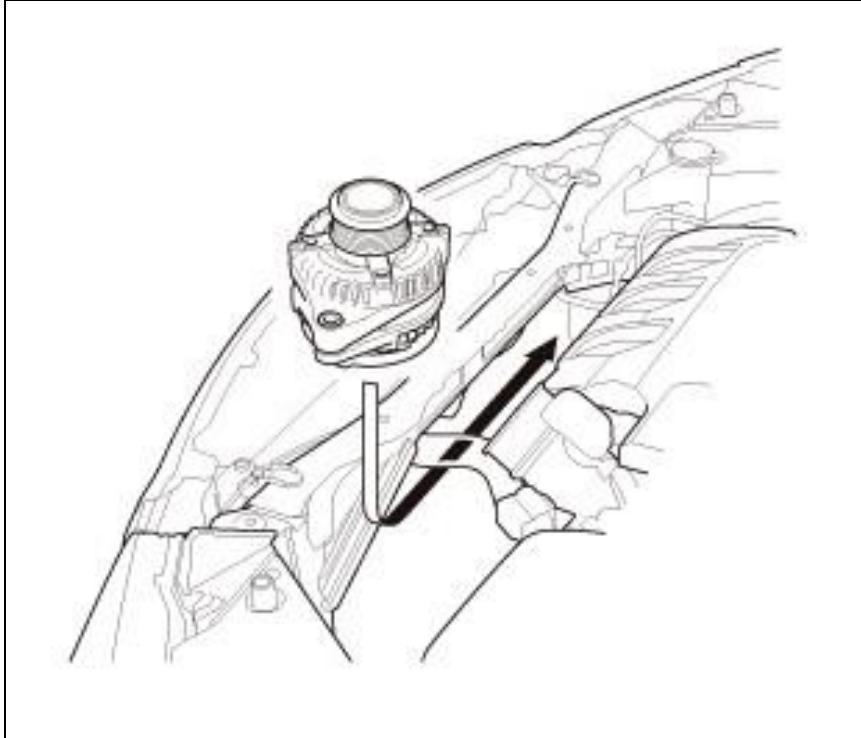

Courtesy of HONDA, U.S.A., INC.

1. Install the alternator.

Fig 1: Alternator Bolts With Torque Specifications

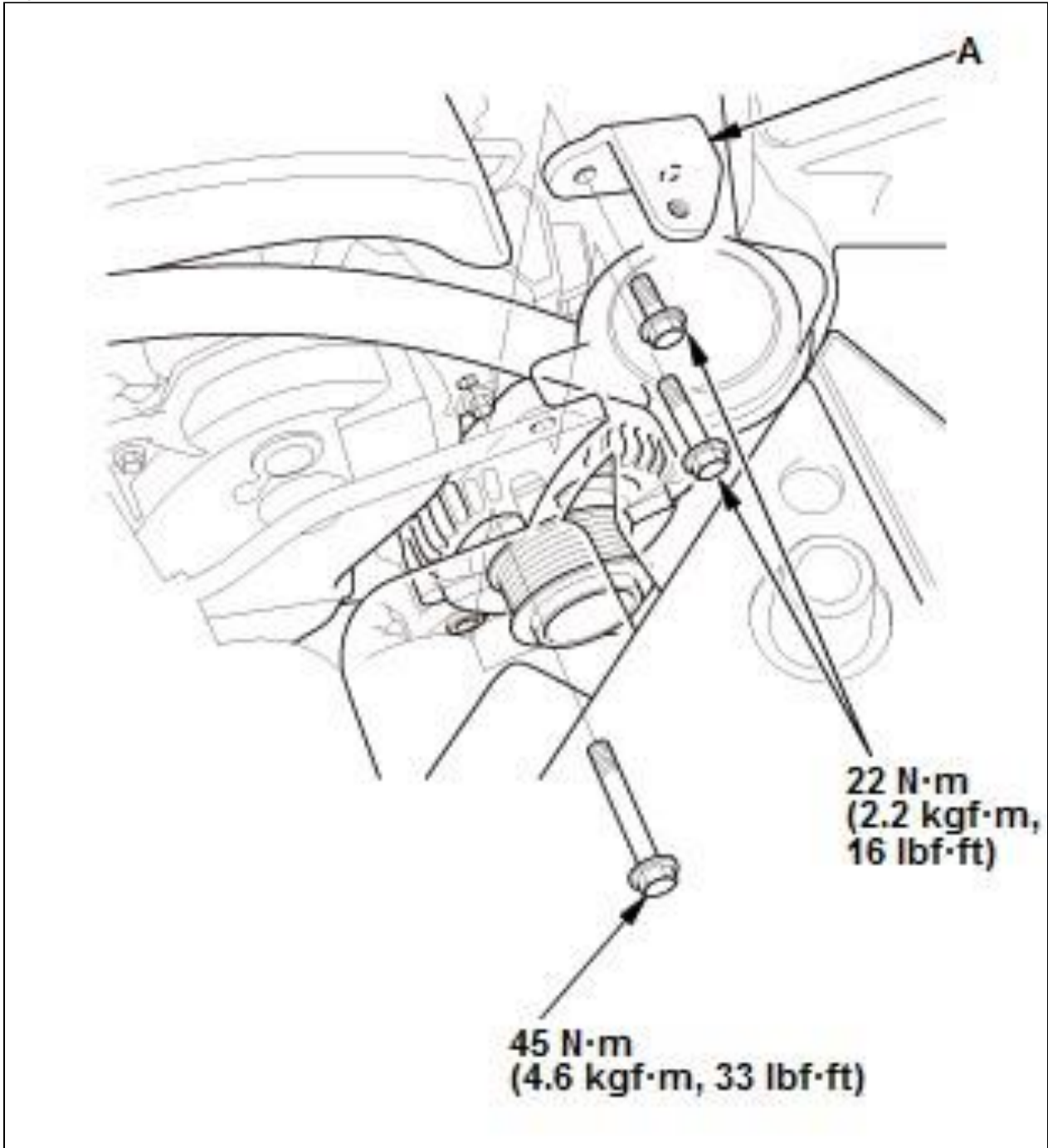

Courtesy of HONDA, U.S.A., INC.

2. Loosely install the alternator bracket (A)
3. Tighten the alternator mounting bolts and the bracket mounting bolt.

## 2. Alternator Connector and Positive Alternator Cable - Connect

1. Install the bolt (A) securing the harness holder
2. Connect the alternator connector (B), the A/C compressor clutch connector(C), and the positive alternator cable (D). Make sure the crimped side of the ring terminal faces away from the alternator when you connect it
3. Install the harness clamp (E).

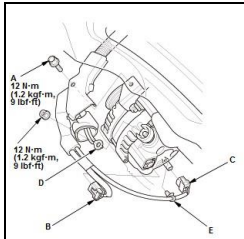

Courtesy of HONDA,  
U.S.A., INC.

### 3. A/C Condenser Fan Shroud and Radiator Fan Shroud - Install

1. Install the A/C condenser fan shroud and the radiator fan shroud .

### 4. Drive Belt - Install

1. Install the drive belt .

### 5. Battery - Install

1. Do the battery installation procedure .