

Camshaft Pulley Removal And Installation (2013-15)

Removal

1. Timing Belt - Remove

1. Remove the timing belt .

2. Camshaft Pulley - Remove

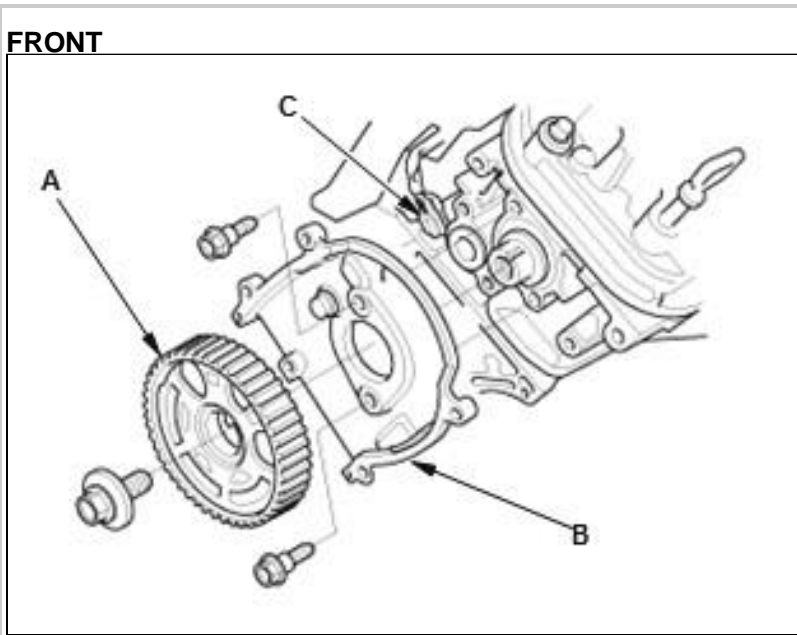

1. Remove the camshaft pulleys (A) and the back covers (B)
2. Front: Disconnect the CMP sensor connector (C).

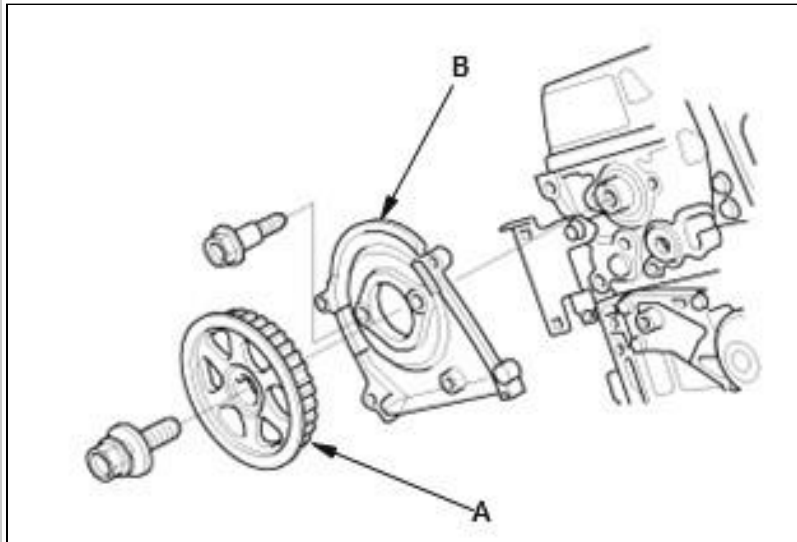

Courtesy of HONDA, U.S.A., INC.HONDA, U.S.A., INC.

REAR

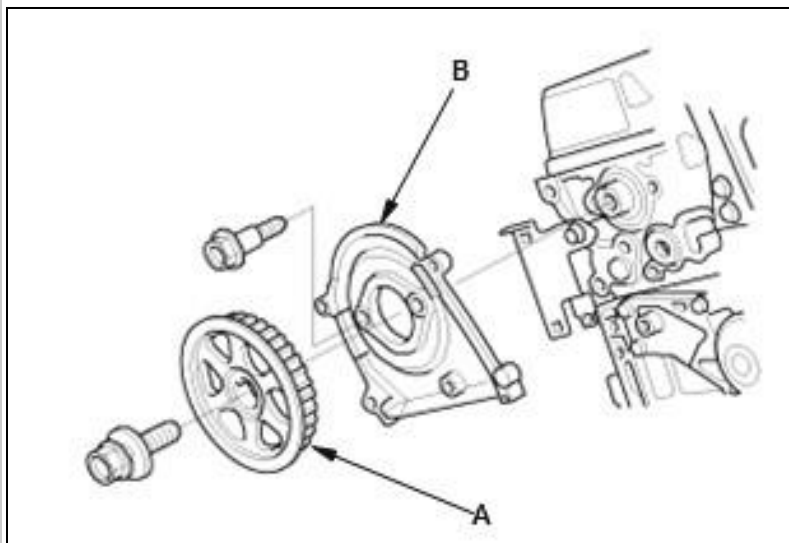
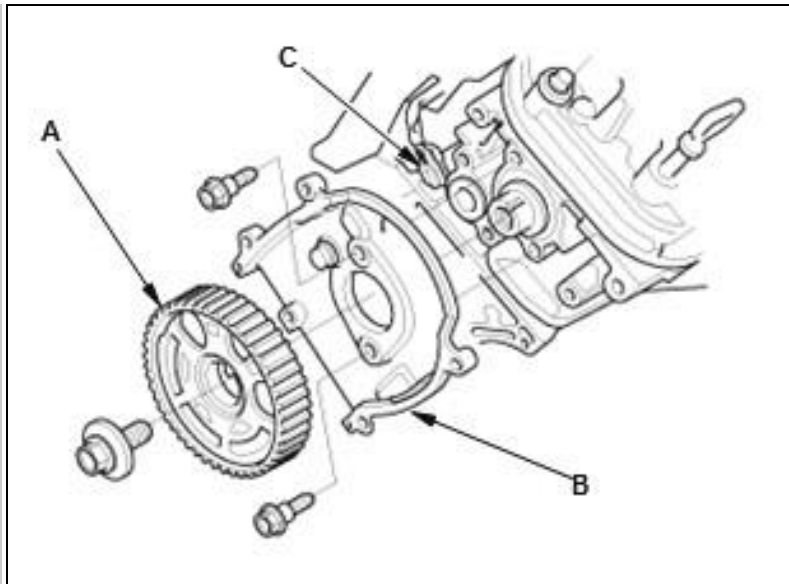

Courtesy of HONDA, U.S.A., INC. HONDA, U.S.A., INC.

Installation 1. Camshaft

Pulley - Install Fig 1: Front

Camshaft Pulley With

Torque Specifications

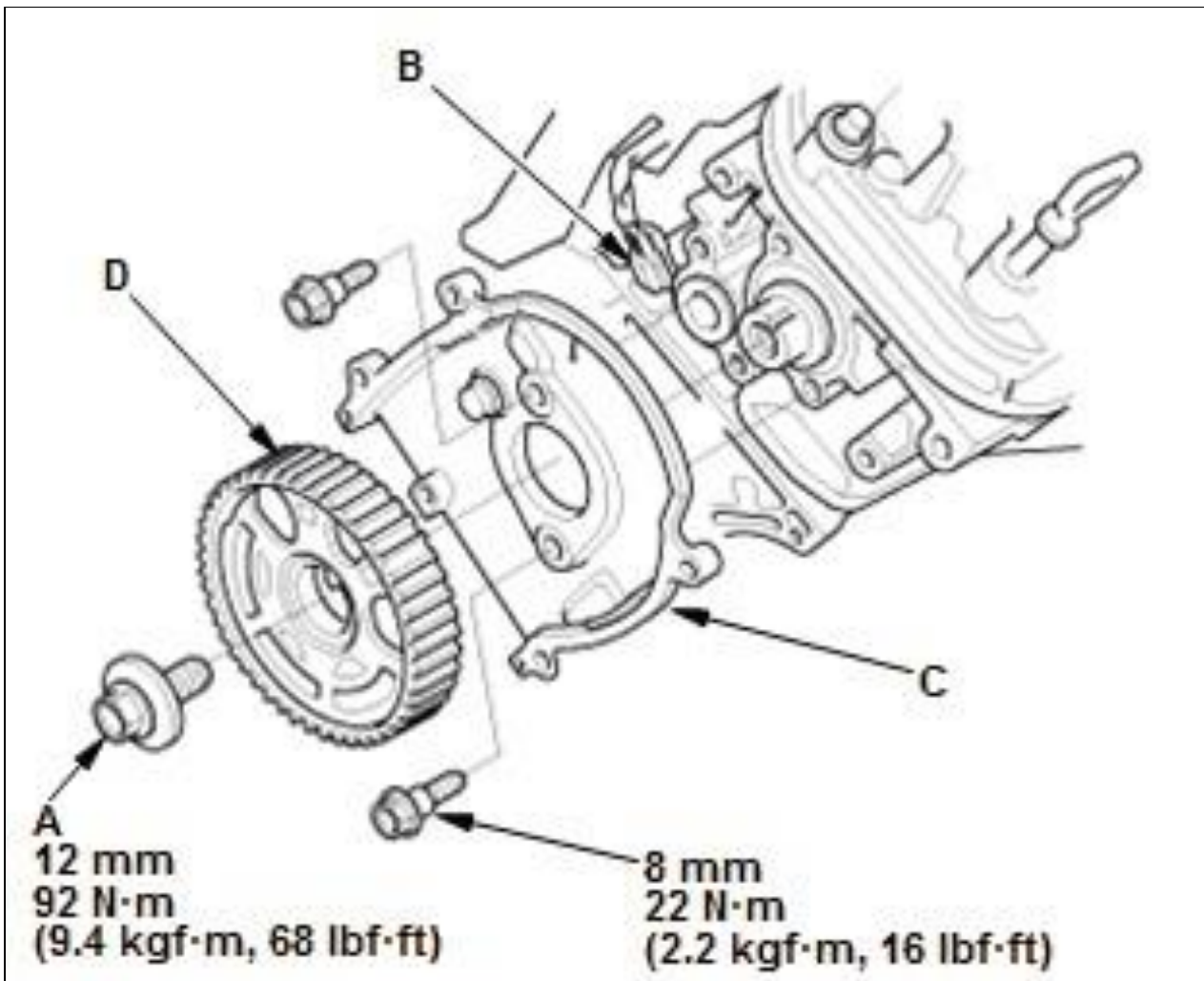

Courtesy of HONDA, U.S.A., INC.
Fig 2: Rear Camshaft Pulley With Torque Specifications

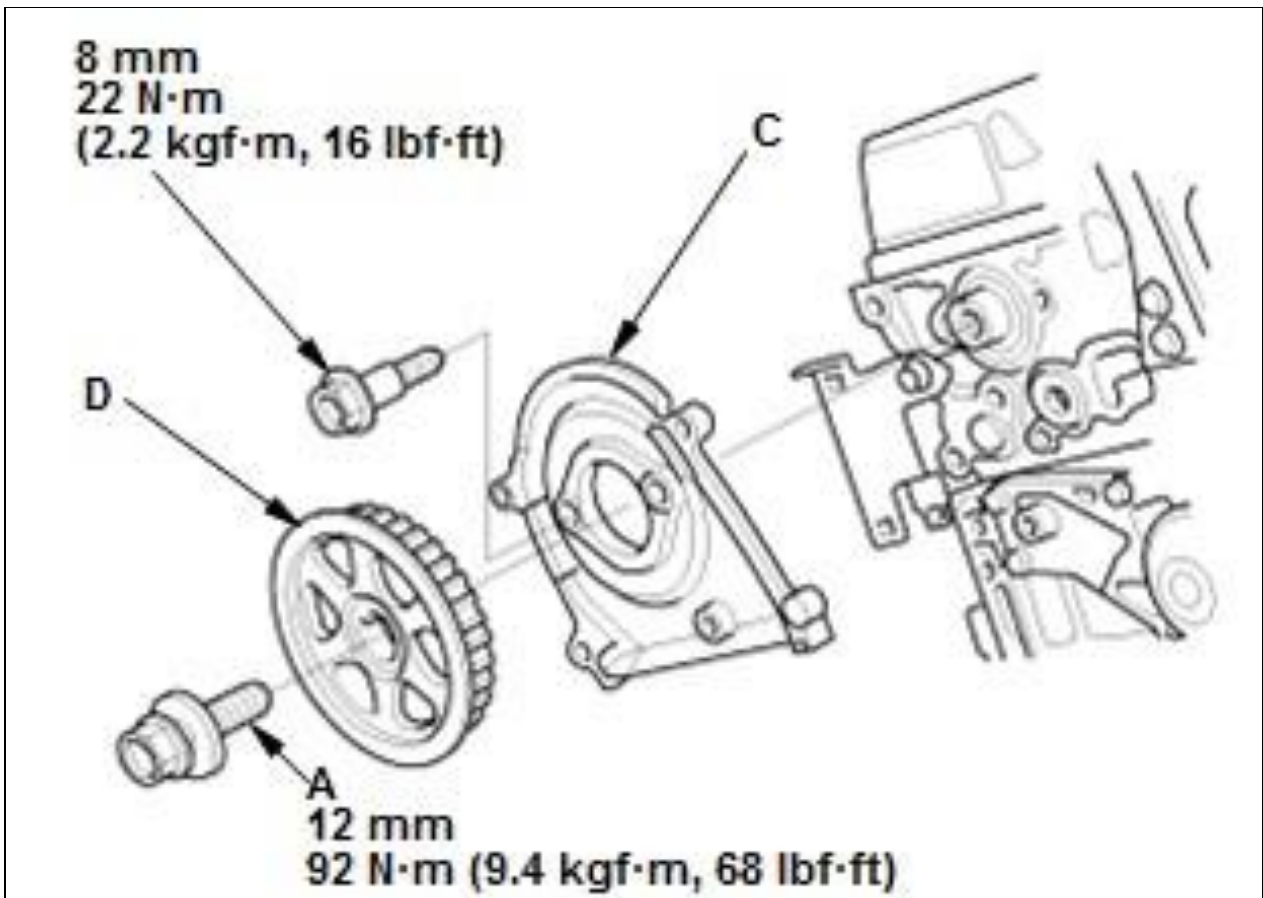

Courtesy of HONDA, U.S.A., INC.

1. Apply new engine oil to the threads of the camshaft pulley mounting bolt (A)
2. Front: Connect the CMP sensor connector (B)
3. Install the back cover (C) and the camshaft pulley (D).

2. Timing Belt - Install

1. Install the timing belt .