

Service Manual: STARTING SYSTEM - SERVICE
INFORMATION

**REMOVAL INSTALLATION > STARTER REMOVAL, INSTALLATION, AND
PERFORMANCE TEST (2013-18)**

Starter Removal, Installation, and Performance Test

**REMOVAL INSTALLATION > STARTER REMOVAL, INSTALLATION, AND
PERFORMANCE TEST (2013-18) > INSTALLATION**

1. Starter - Install

Fig 1: Starter With Torque Specifications

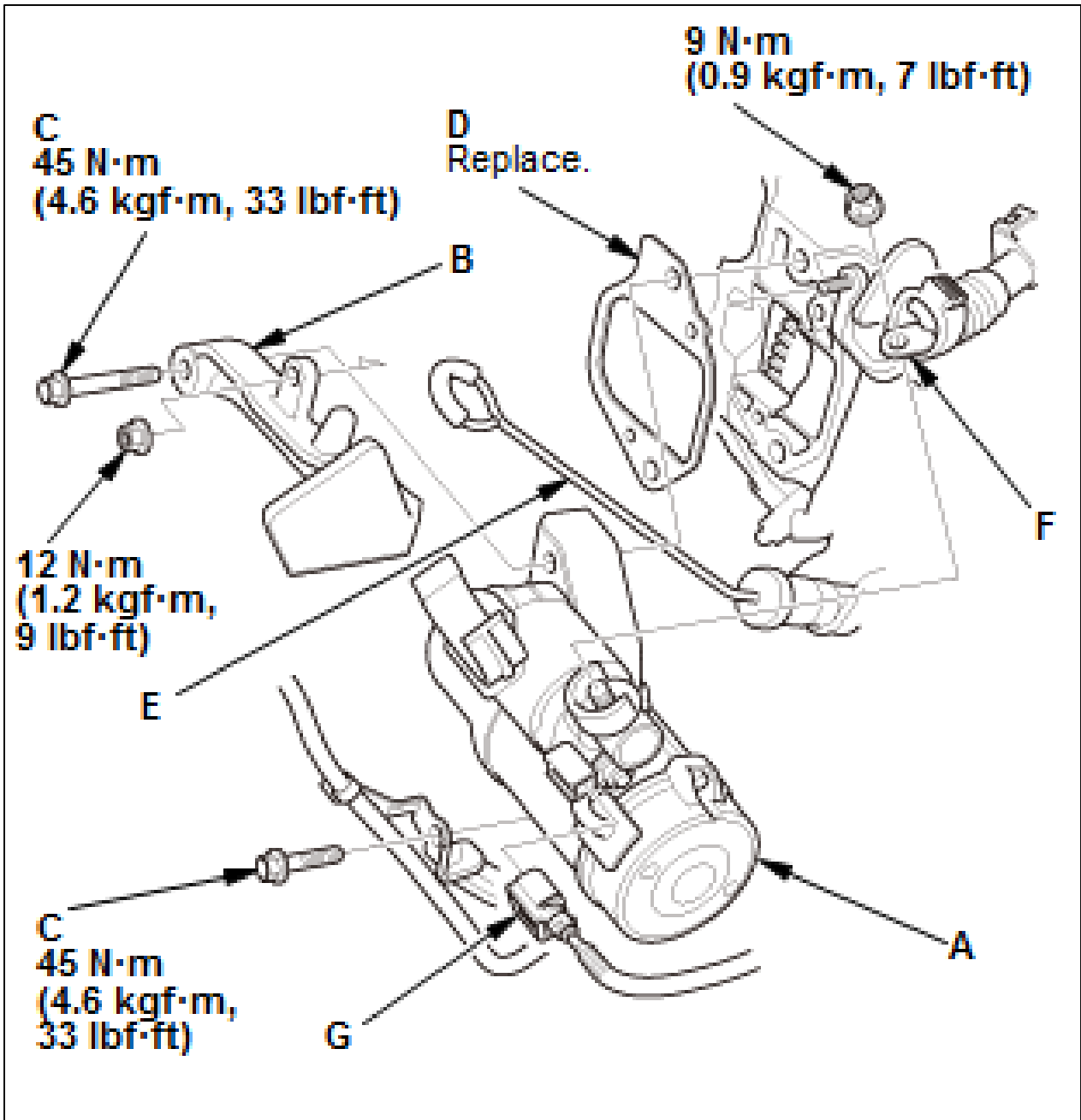

Courtesy of HONDA, U.S.A., INC.

1. Install the starter (A) and the skid block (B), then tighten the mounting bolts (C).

NOTE: Always use a new gasket (D)

2. Install the dipstick (E)
3. Connect the positive starter cable (F) and the S terminal connector (G). Make sure the crimped side of the ring terminal faces away from the starter when you connect it.

2. Air Intake Scoop - Install



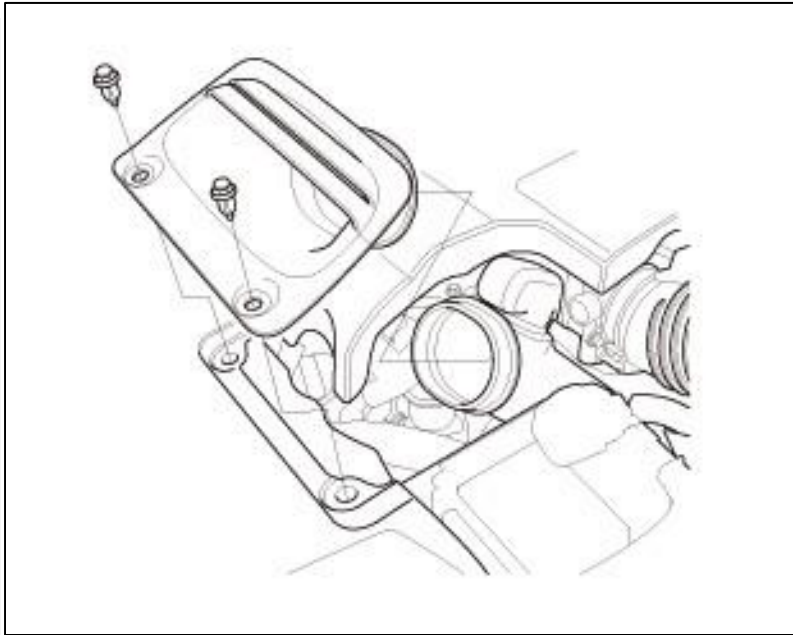

1. Install the air intake scoop.

Courtesy of HONDA, U.S.A., INC.

3. Battery Terminal - Connect

1. Do the battery terminal reconnection procedure .

4. Starter After Install - Check

1. Start the engine to make sure the starter works properly.