

## REMOVAL INSTALLATION > STARTER REMOVAL, INSTALLATION, AND PERFORMANCE TEST (2013-18)

### Starter Removal, Installation, and Performance Test

## REMOVAL INSTALLATION > STARTER REMOVAL, INSTALLATION, AND PERFORMANCE TEST (2013-18) > REMOVAL

#### 1. Battery Terminal - Disconnect

1. Do the battery terminal disconnection procedure .

#### 2. Air Intake Scoop - Remove

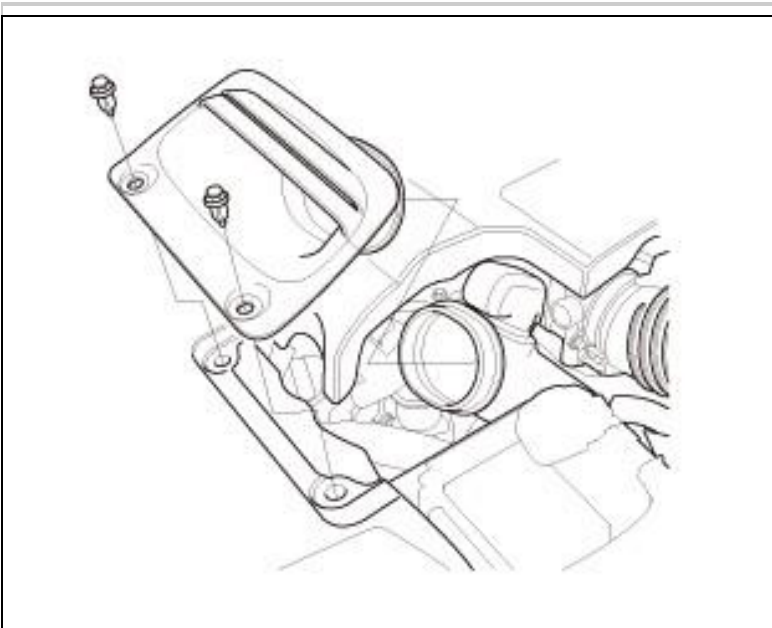

Courtesy of HONDA, U.S.A., INC.

1. Remove the air intake scoop.

#### 3. Starter - Remove

1. Disconnect the positive starter cable (A) and the S terminal connector (B)
2. Remove the dipstick (C)
3. Remove the skid block (D), the starter (E), and the gasket (F).

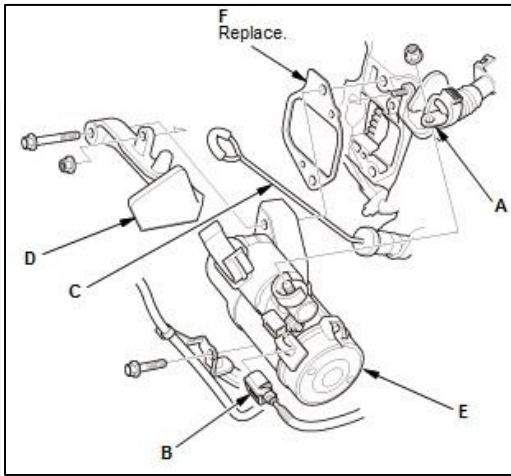

Courtesy of HONDA, U.S.A., INC.