

YMMS: 2018 Acura RDX Base
Engine: 3.5L Eng
VIN:

Oct 17, 2019
License:
Odometer:

REMOVAL & INSTALLATION > TIMING BELT DRIVE PULLEY REMOVAL AND INSTALLATION (2016-18) > REMOVAL / INSTALLATION

1. Timing Belt - Remove
2. Timing Belt Drive Pulley - Remove

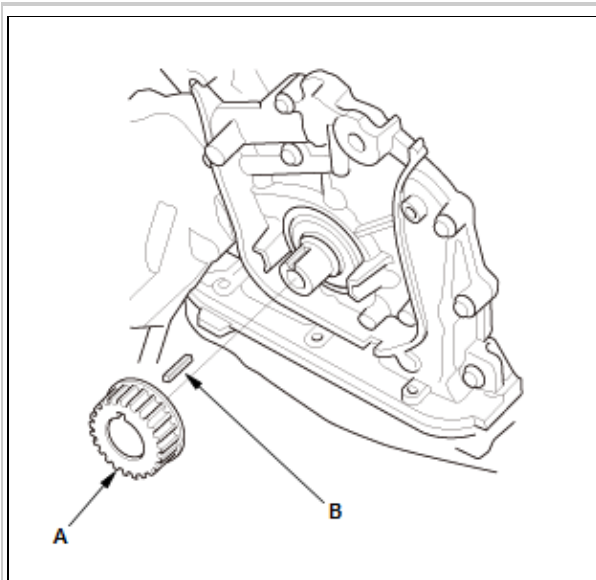

Courtesy of HONDA, U.S.A., INC.

1. Remove the timing belt drive pulley (A) and the key (B).

3. All Removed Parts - Install

1. Install the removed parts in the reverse order of removal.

NOTE: *Inspect the timing belt drive pulley and the key for damage. If it is cracked or damaged, replace the timing belt drive pulley and the key.*