

Intermediate Shaft Disassembly and Reassembly

Special Tool Required

Image	Description/Tool Number
	Bearing Driver Attachment, 42 x 47 mm 07746-0010300
	Bearing Driver Attachment, 52 x 55 mm 07746-0010400
	Driver Handle, 15 x 135L 07749-0010000

Image	Description/Tool Number
	Fork Seal Driver, 39.2 x 49.5 x 15 mm 07947-4630100
	Support Base 07965-SD90100
	Installer Attachment 40 mm 07LAD-PW50601

Image	Description/Tool Number
	Support Base Attachment 07LAF-SM40300

Disassembly

1. Heat Shield - Remove

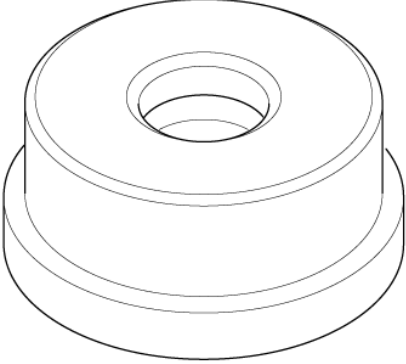
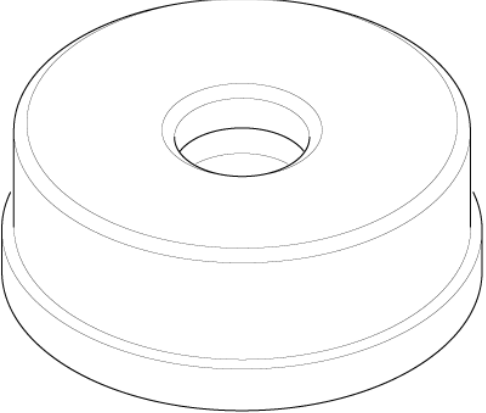
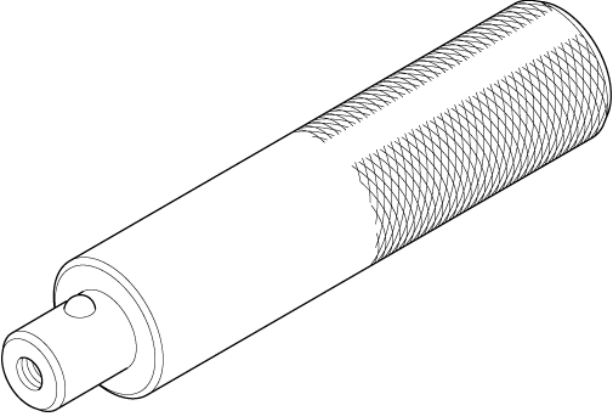

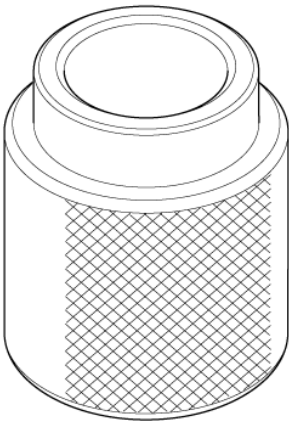
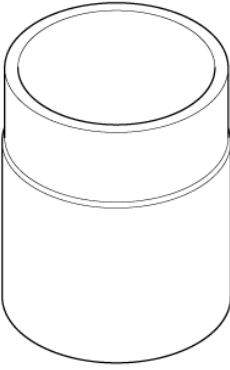
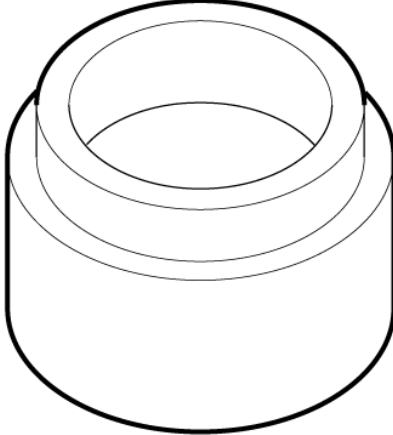
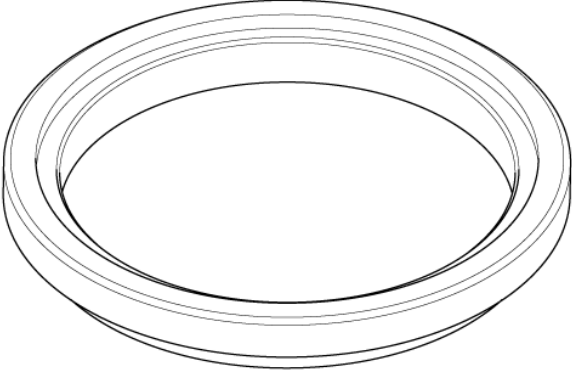
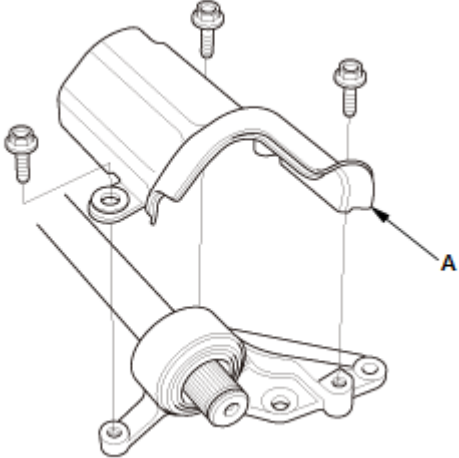
1. Remove the heat shield (A).

2. Outer Seal - Remove

1. Remove the outer seal (A).

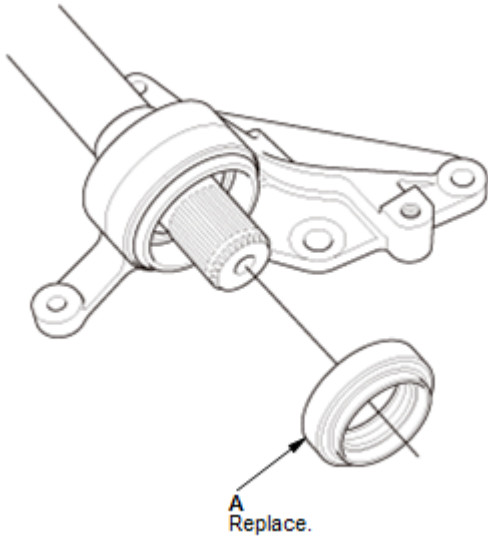

3. Intermediate Shaft - Remove

1. Remove the external snap ring (A).

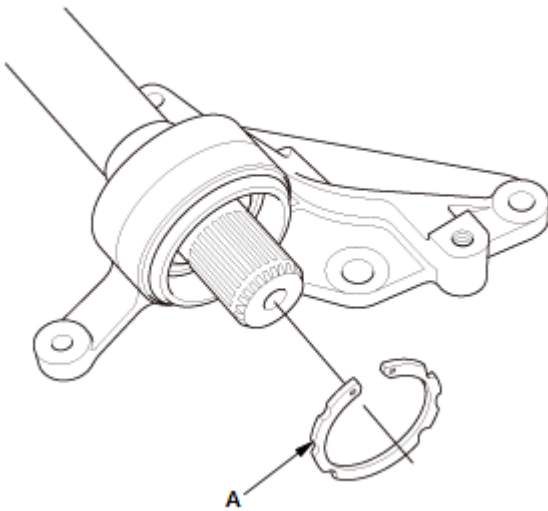

2. Press the intermediate shaft (A) out of the intermediate shaft bearing (B) using the support base attachment, the support base, and a press.

NOTE: Be careful not to damage the bearing support ring (C) on the intermediate shaft during disassembly.

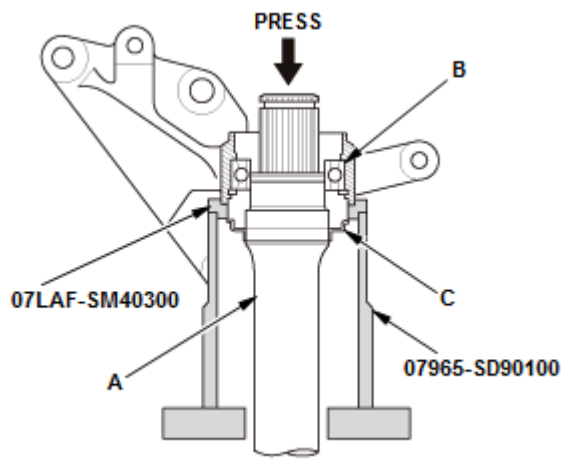

4. Intermediate Shaft Bearing - Remove

1. Remove the internal snap ring (A).

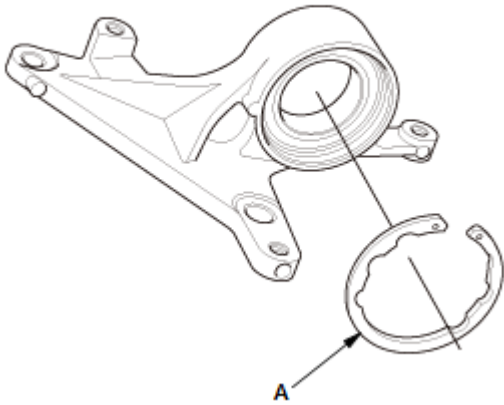

2. Press the intermediate shaft bearing (A) out of the bearing support (B) using the 15 x 135L driver handle, the 42 x 47 mm bearing driver attachment, the support base attachment, the support base, and a press.

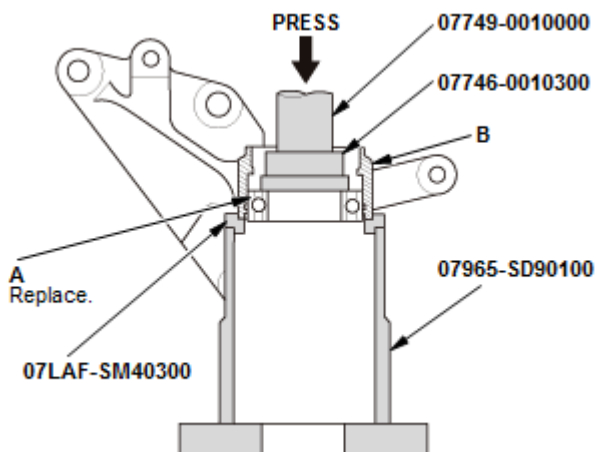

Exploded View

1. Intermediate Shaft - Exploded View

Exploded View

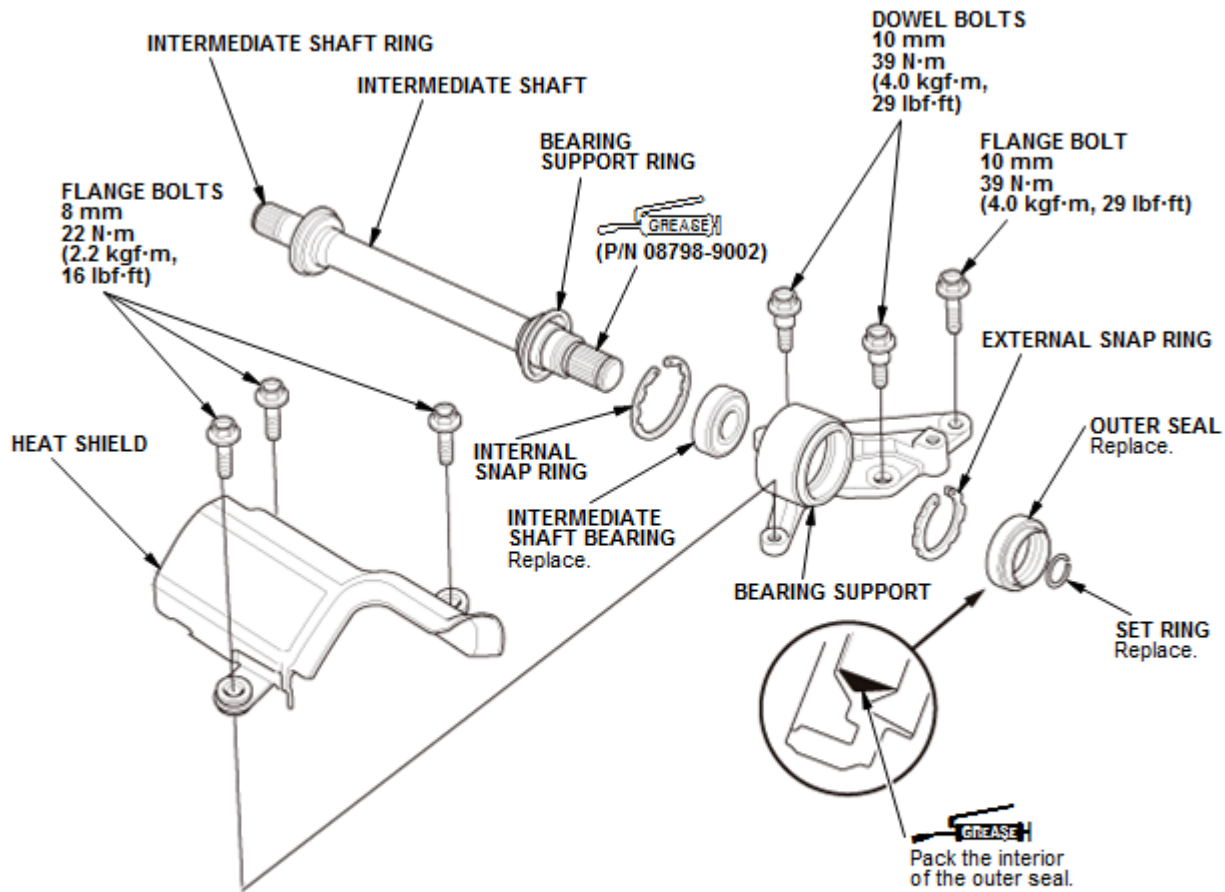

Reassembly

Refer to the Exploded View as needed during this procedure.

1. Intermediate Shaft Bearing - Install

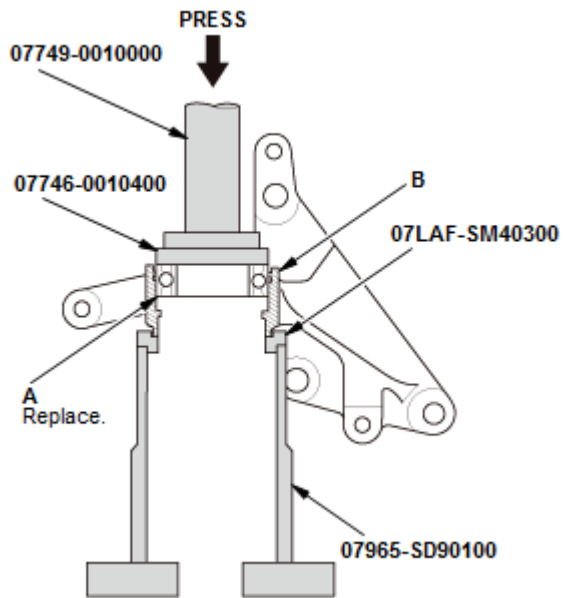

1. Clean the disassembled parts with solvent.

NOTE: Do not wash the rubber parts with solvent.

2. Dry the disassembled parts with compressed air.

3. Press a new intermediate shaft bearing (A) into the bearing support (B) using the 15 x 135L driver handle, the 52 x 55 mm bearing driver attachment, the support base attachment, the support base, and a press.

4. Install the internal snap ring (A).

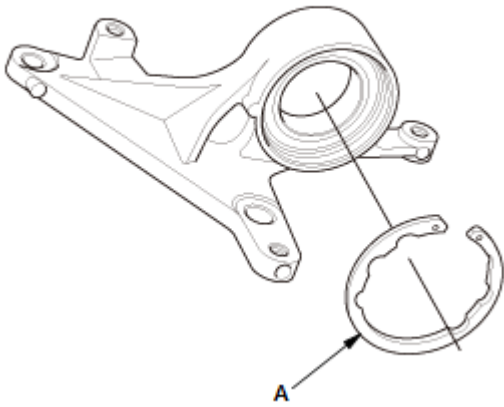

2. Intermediate Shaft - Install

1. Press the intermediate shaft (A) into the shaft bearing (B) using the 39.2 x 49.5 x 15 mm fork seal driver and a press.

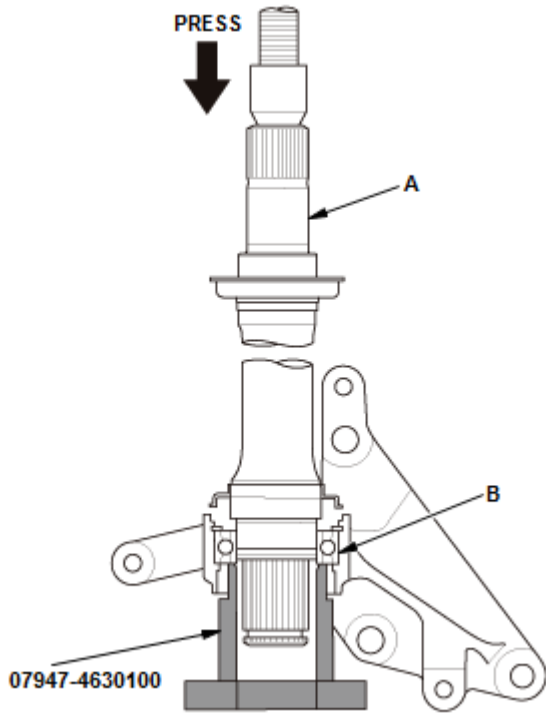

-
2. Install the external snap ring (A).

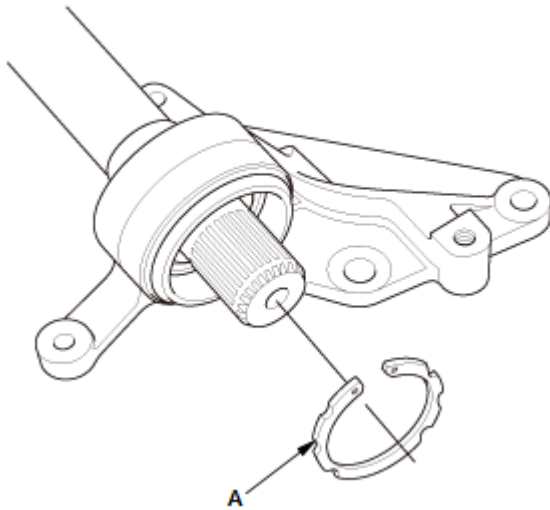

3. Outer Seal - Install

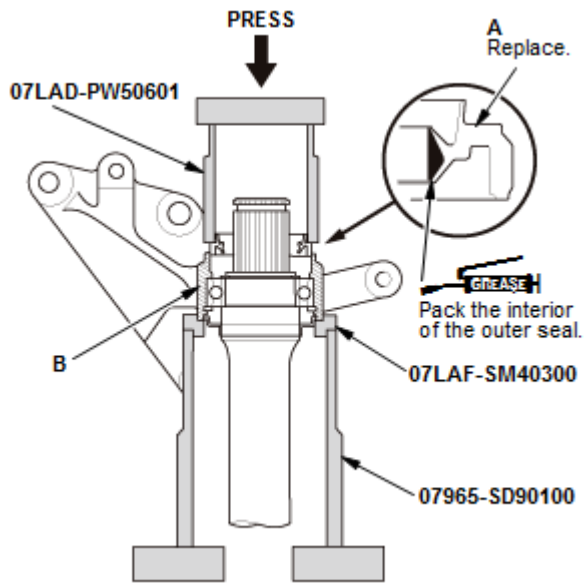

1. Install a new outer seal (A) into the bearing support (B) using the 40 mm installer attachment, the support base attachment, the support base, and a press. Press in the seal until it is even with the surface of the bearing support.

4. Heat Shield - Install

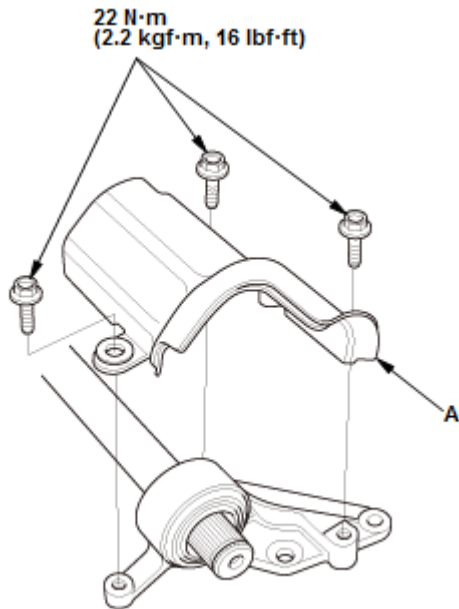

1. Install the heat shield (A).