

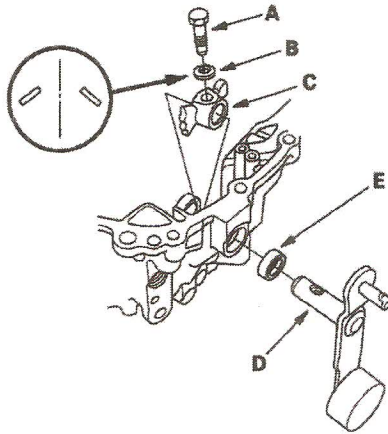

20. Remove the 8 mm special bolt (A), 8 mm spring washer (B), shift arm (C), change lever (D), and 16 x 23 x 5 mm dust seal (E).



Reverse Shift Lever Clearance Inspection

1. Measure the clearance between the reverse shift lever (A) and reverse shift fork (B) with a feeler gauge (C). If the clearance is more than the service limit, go to step 2.

Standard: 0.05 – 0.50 mm (0.002 – 0.020 in.)
Service Limit: 0.6 mm (0.024 in.)

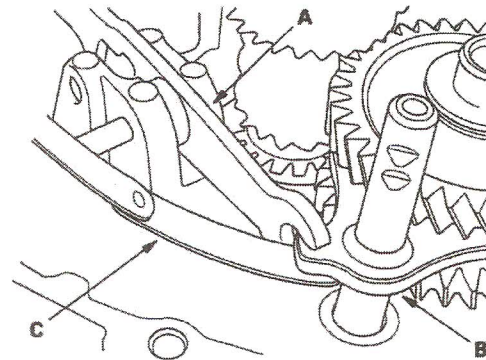

2. Measure the width of the reverse shift lever.

- If distance is not within the standard, replace the reverse shift lever with a new one.
- If distance is within the standard, replace the reverse shift fork with a new one.

Standard: 6.400 – 6.650 mm (0.2520 – 0.2618 in.)

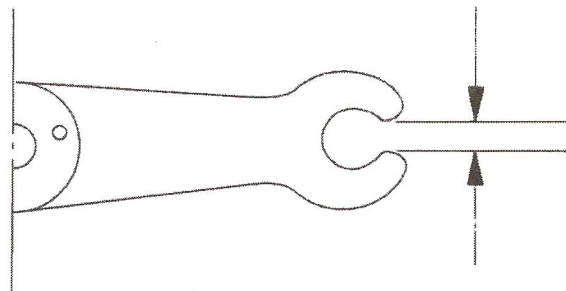

(cont'd)